

RECEIVED

JUL 9 1951  
STATE ENGINEER  
SALEM, OREGON

RECEIVED

JUL 17 1951  
STATE ENGINEER  
SALEM, OREGON

T365. R.7 W., W.1 M

Scale 4" = 1 Mile

June 1951

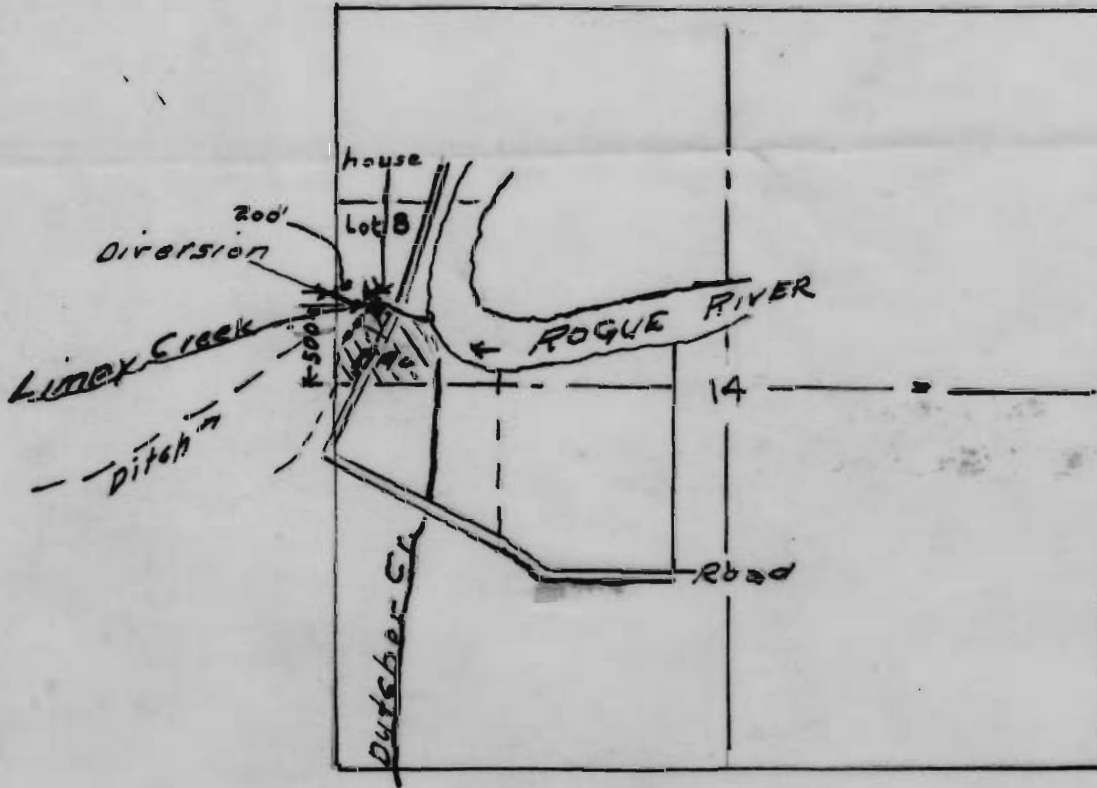

Clifford G. Cross

Application No. 26064  
Permit No. 20566