

Sec. 15, T. 36 S., R. 2 W. W. M.

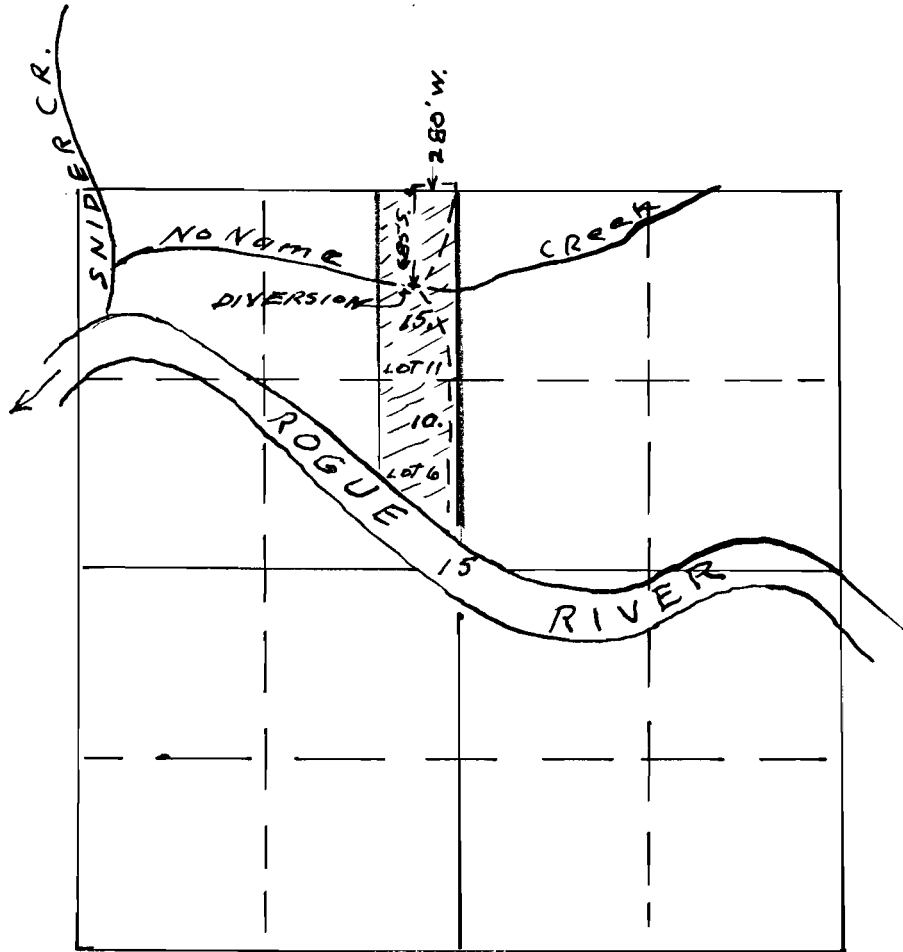

Map To accompany application of
E.E. Robinson for use of water from
No name Creek for irrigation.

This office 8/9/51 *Whitth*

Application No 26297

Permit No 20642

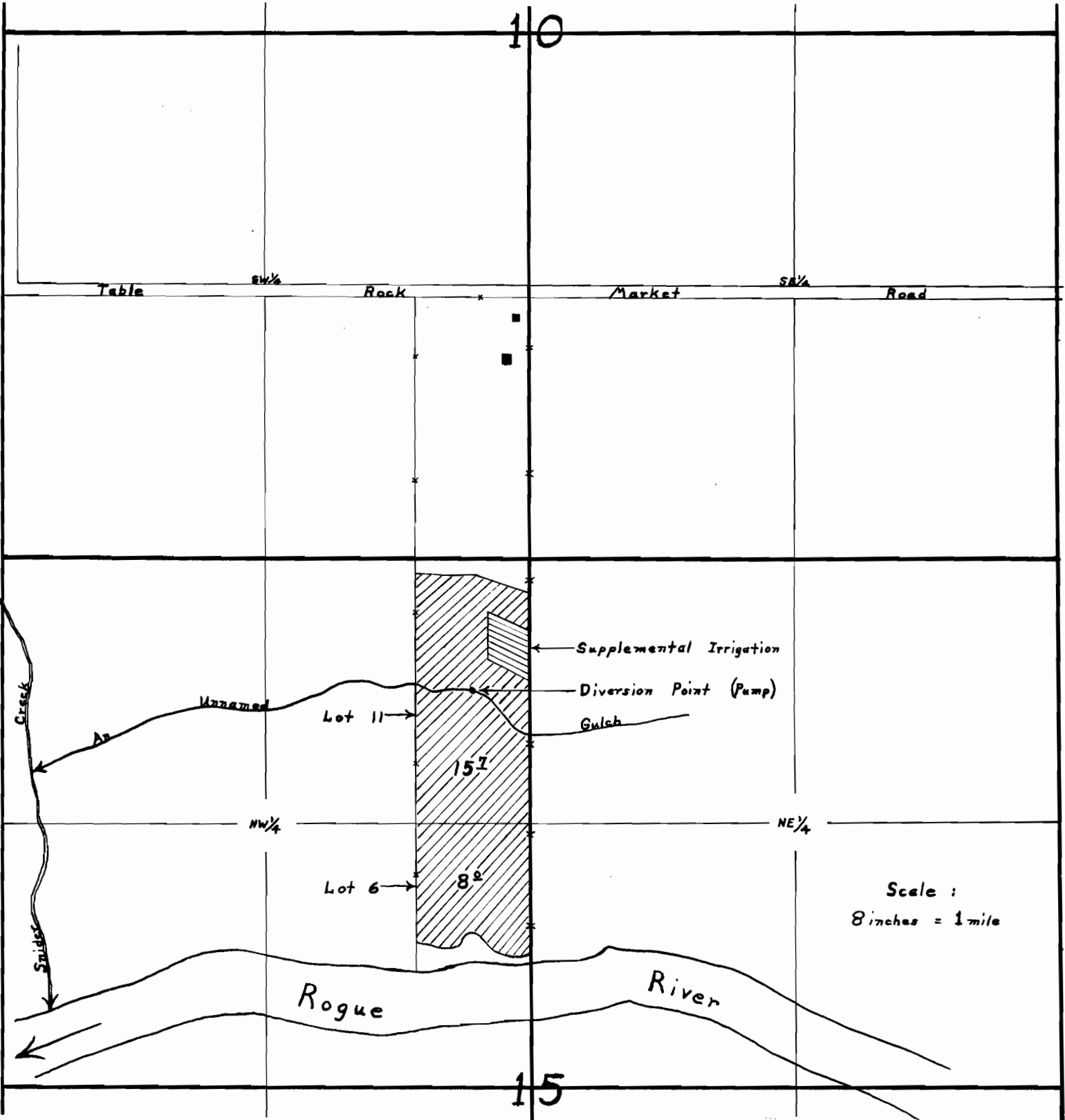

Map accompanying final proof of E.E. Robinson, for use of water from an unnamed gulch for irrigation and supplemental irrigation purposes. 2-9-55.

Application No. 26297

Permit No. 20642

David C. Hendrix, Watermaster Dist. No. 15