

RANGE 26 EAST W.M.

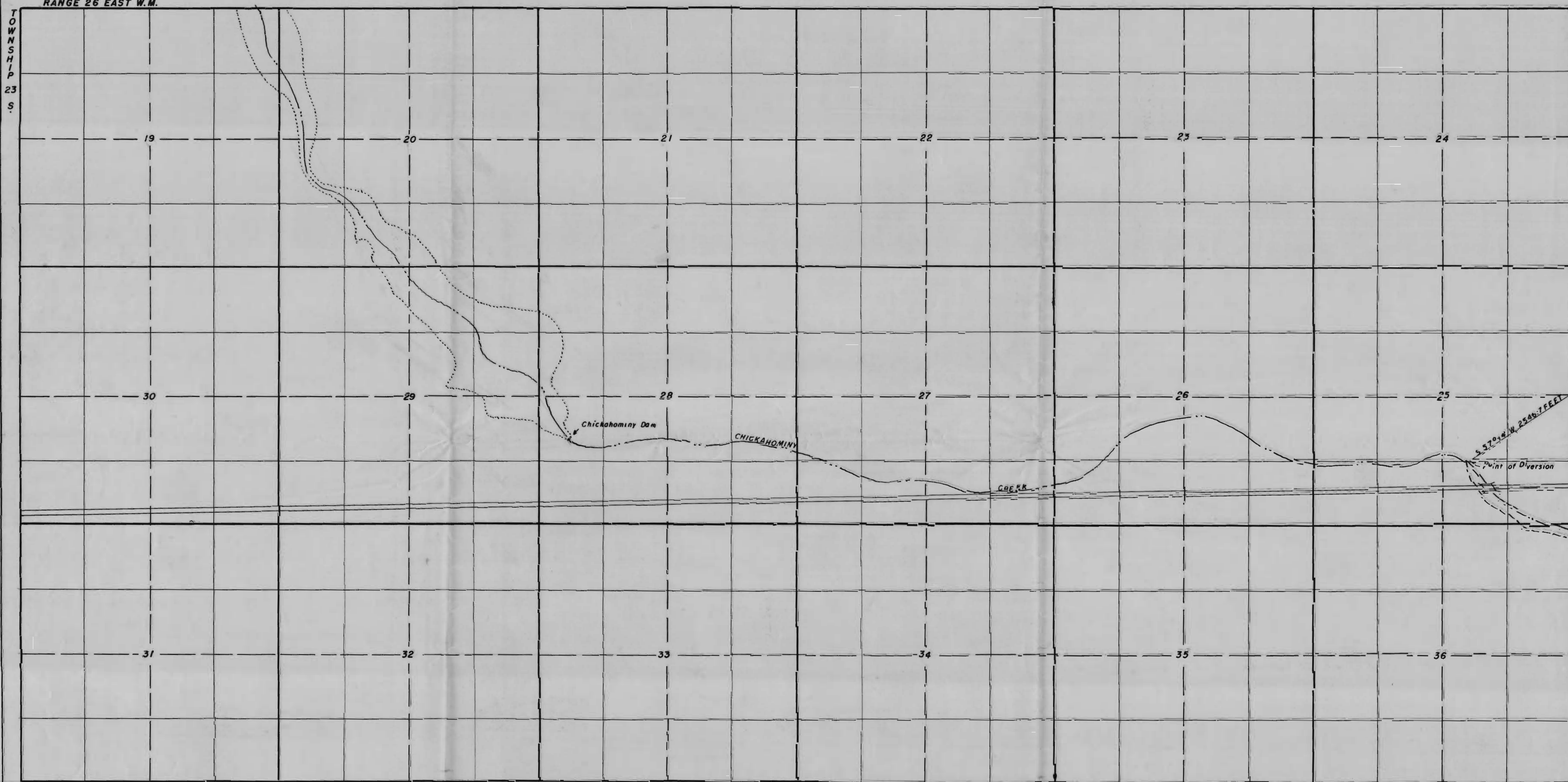

SCALE: 4" = 1 MILE

RANGE 27 EAST W.M.

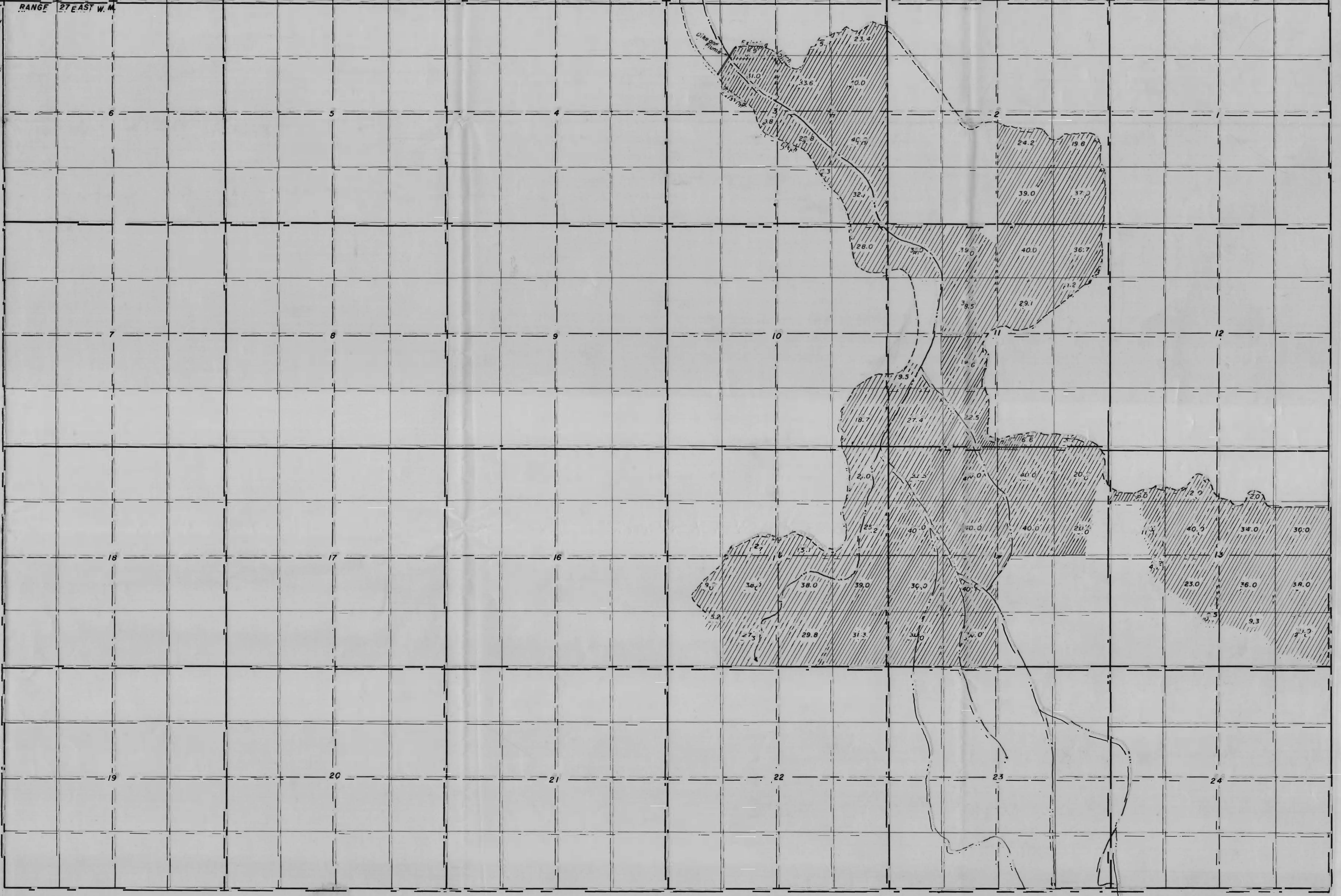

MAP  
 TO ACCOMPANY APPLICATION FOR A PERMIT TO  
 APPROPRIATE THE PUBLIC WATERS  
 OF THE STATE OF OREGON

WILEN L. CLUSTER, RILEY, OREGON      APPLICANT

RECEIVED  
 SEP 1 8 1951  
 STATE ENGINEER  
 SALEM, OREGON

I, WILEN L. CLUSTER, of the County of Clatsop, State of Oregon, do hereby certify that this map was prepared by me or under my direct supervision and that the same is a true and correct copy of the original map as shown to me by the applicant. My commission expires on the 1st day of January, 1952.

WILEN L. CLUSTER  
 State Engineer

License No. 2511

Application No. R-26454 + 26456  
 Permits No. R-1256 + 20743



