

J. R. GIVENS IRRIGATION WORKS

SEC. 23 & 26, T.11 S., R. 4 W., W.M.

SCALE: 1" = 10 CH.

SEPT. 18, 1951

Application No. 26513

Permit No. 20780



526222' N. 27.943
to Pt. N89°30'E. 1.995
of SW Cor. Cl. 78

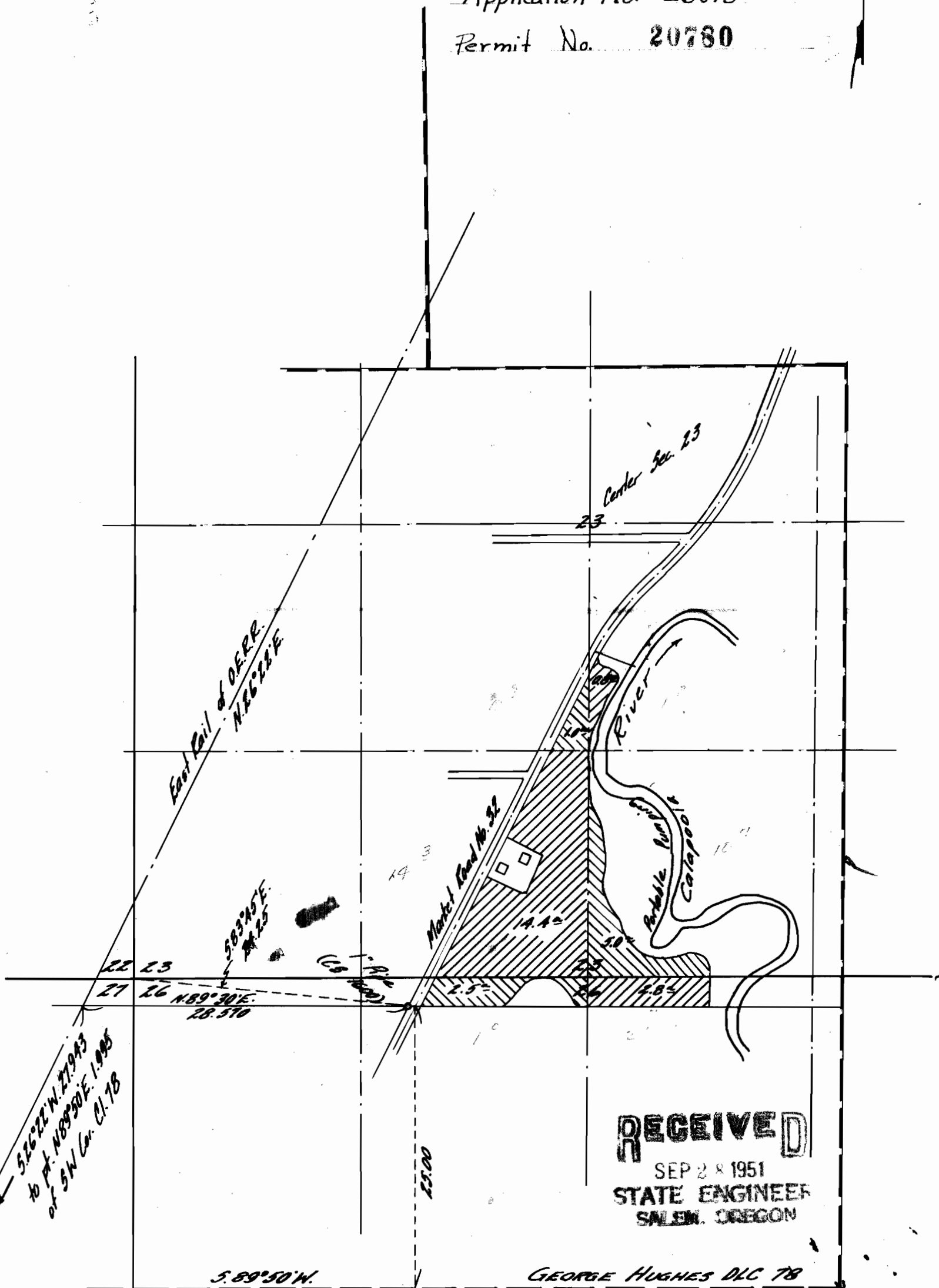

RECEIVED
SEP 28 1951
STATE ENGINEER
SALEM, OREGON

GEORGE HUGHES DLC 78

26513