

GLENN E TYLER
 COUNTY SURVEYOR
 LAKE COUNTY
 LAKEVIEW, OREGON

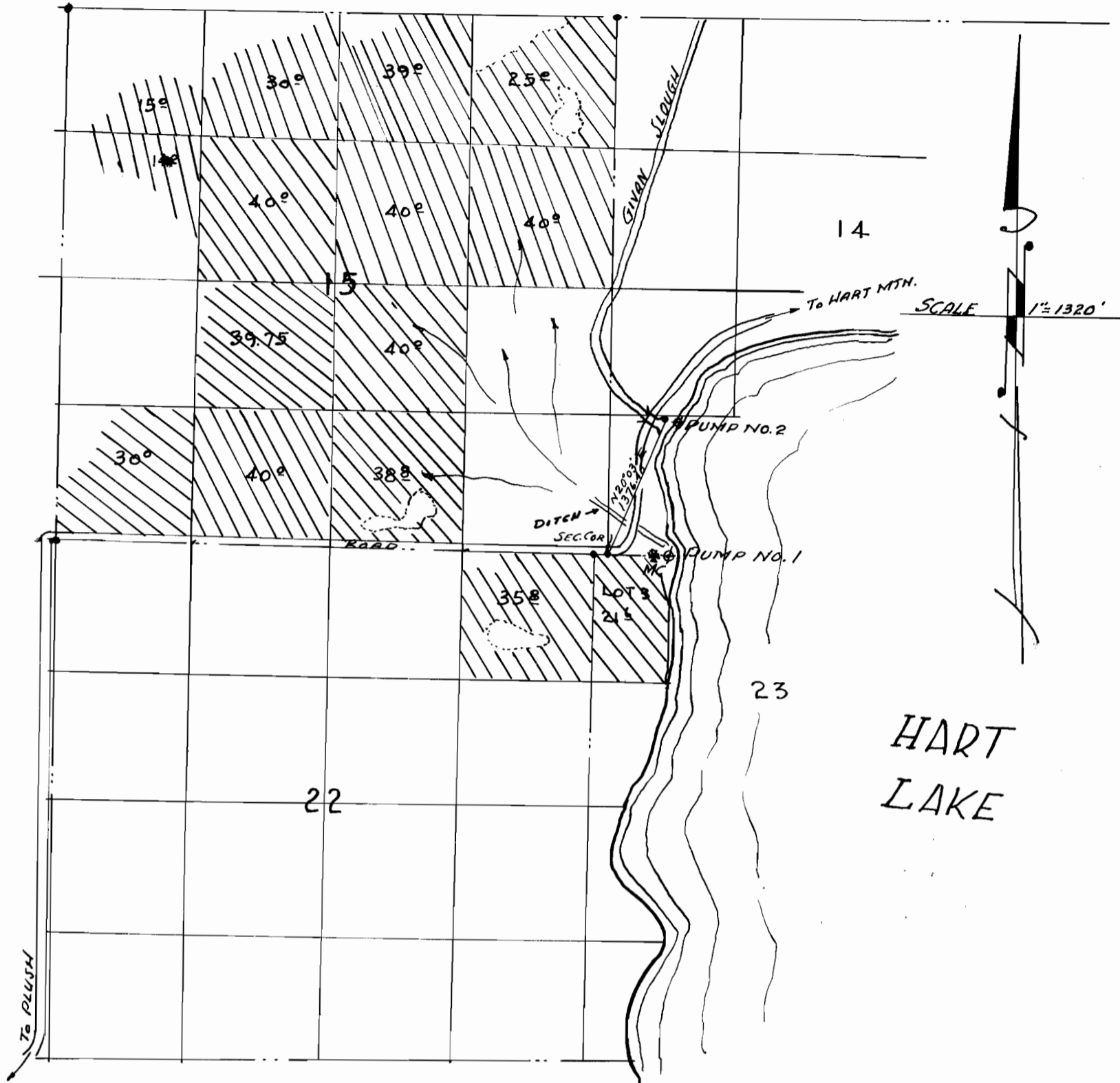

MAP TO ACCOMPANY THE APPLICATION OF DONALD J,
 AND CORNELIUS J FITZGERALD OF PLUSH OREGON
 FOR A SUPPLEMENTAL DUMPING RIGHT OF THE WATERS
 OF HART LAKE FOR IRRIGATION PURPOSES.
 LOCATED IN SECS. 14-15-22 AND 23- TOWNSHIP 36 SOUTH
 RANGE 24 EAST OF WILLAMETTE MERIDIAN LAKE CO. ORE.

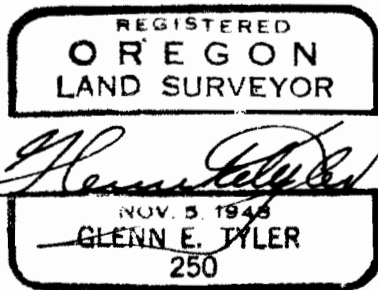

I, GLENN E TYLER OF LAKEVIEW OREGON DO
 HEREBY CERTIFY THAT THE ABOVE MAP WAS
 PREPARED FROM (THE ADJUDICATION MAP
 OF THE WATERS OF WARNER LAKES IN 1929)
 THE DUMP TIES ARE MAPPED FROM FIELD
 NOTES TAKEN DURING AN ACTUAL SURVEY
 MADE BY ME ON DEC. 12 1950, AND
 CONSIST OF THE FOLLOWING:-
 DUMP NO. 1 IS LOCATED 20 FEET EAST
 OF THE MEANDER CORNER COMMON TO
 SECS. 14 & 23 T 36 S R 24 E. W. M.
 DUMP NO. 2:- A LEAD PLUG WITH A NAIL IS
 SET ON THE NORTH CONCRETE BRIDGE
 ABUTMENT AND IS N 20° 03' E - 1376.40' FROM
 THE SW COR. OF SEC. 14 - T 36 S - R 24 E W. M.

Glenn E. Tyler

Application No. 26441
 Permit No. 20858