

EVERETT WATTERS IRRIGATION WORKS
 SEC. 2, T.13 S., R.1E., WILL. MER.
 LINN COUNTY, OREGON

SCALE: 1" = 200'

NOV. 28, 1951

I, Orris A. Carnegie, of Albany, Oregon do hereby certify that this map was made from notes taken during an actual survey made by me on November 28, 1951; that the monuments shown on this map are as follows: A crowbar which is the Northwest corner of the Southeast $\frac{1}{4}$ of Section 2, T.13 S., R. 1E. of the Will. Mer. in Linn County, Oregon; and a $\frac{1}{2}$ " pipe which is the Southeast corner of the Northwest $\frac{1}{4}$ of the Southeast $\frac{1}{4}$ of Section 2 in said Township and Range.

REGISTERED
 OREGON
 LAND SURVEYOR

Orris A. Carnegie

MAY 9, 1947
 ORRIS A. CARNEGIE
 213

RECEIVED
 DEC 10 1951
 STATE ENGINEER
 SALEM, OREGON

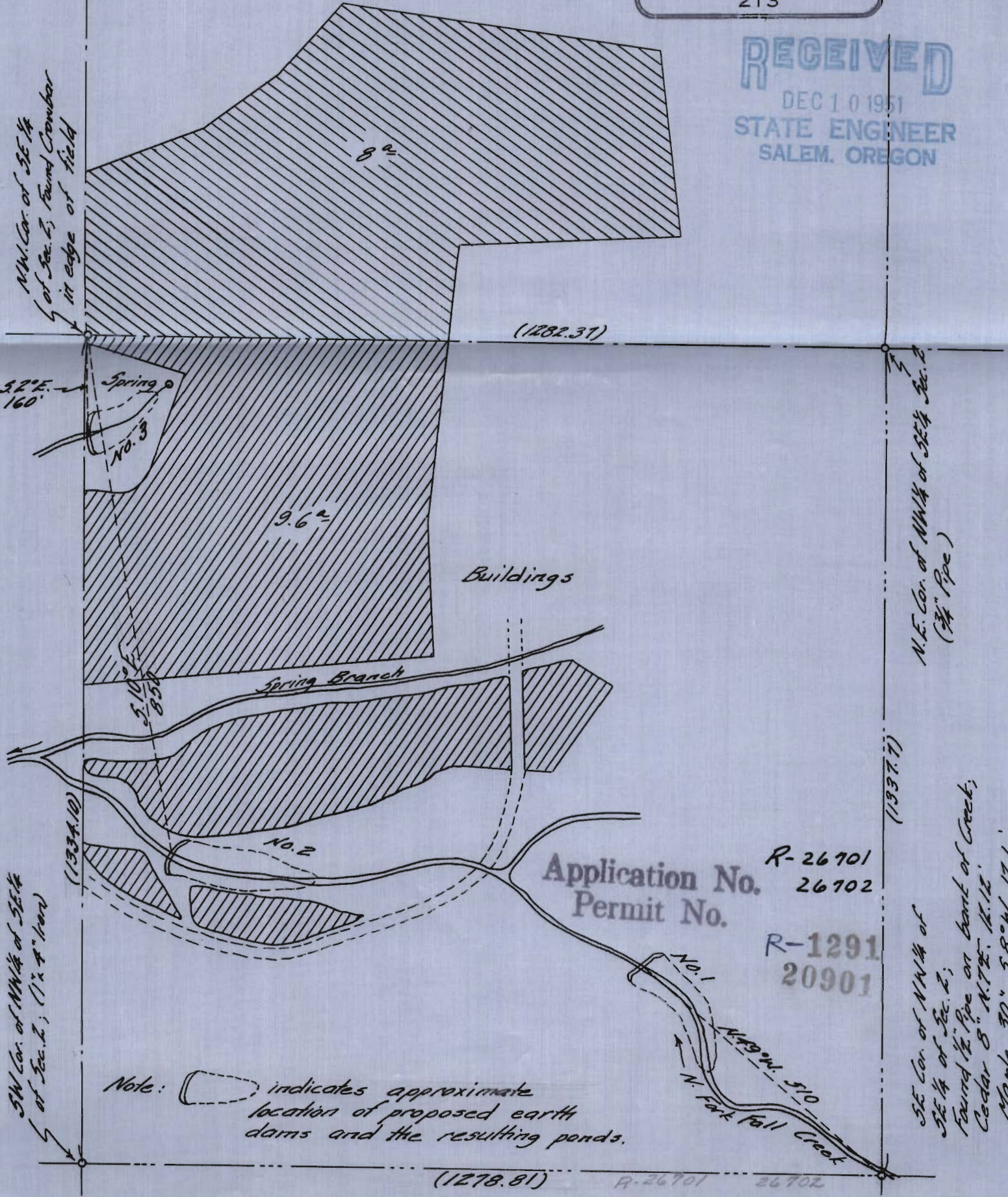

Application No. R-26701
 Permit No. 26702
 R-1291
 20901

Note: indicates approximate location of proposed earth dams and the resulting ponds.

NW. Cor. of SE $\frac{1}{4}$ of Sec. 2, Found Crowbar in edge of field

SW Cor. of NW $\frac{1}{4}$ of SE $\frac{1}{4}$ of Sec. 2, (1" x 4" bar)

N.E. Cor. of NW $\frac{1}{4}$ of SE $\frac{1}{4}$ Sec. 2 (3/4" Pipe)

SE Cor. of NW $\frac{1}{4}$ of SE $\frac{1}{4}$ of Sec. 2; Found 1/2" Pipe on bank of Creek; Cedar 8" N. 78° W. 12.12' Maple 30" S. 8° W. 17.1'

(1278.81)

R-26701 26702