

1/4 COR  
STONE

UTZLAND

HUBBARD

STATE HIGHWAY

S.W. LESSER  
ROAD.

S.W. 65TH  
AVE

S.W. HAINS

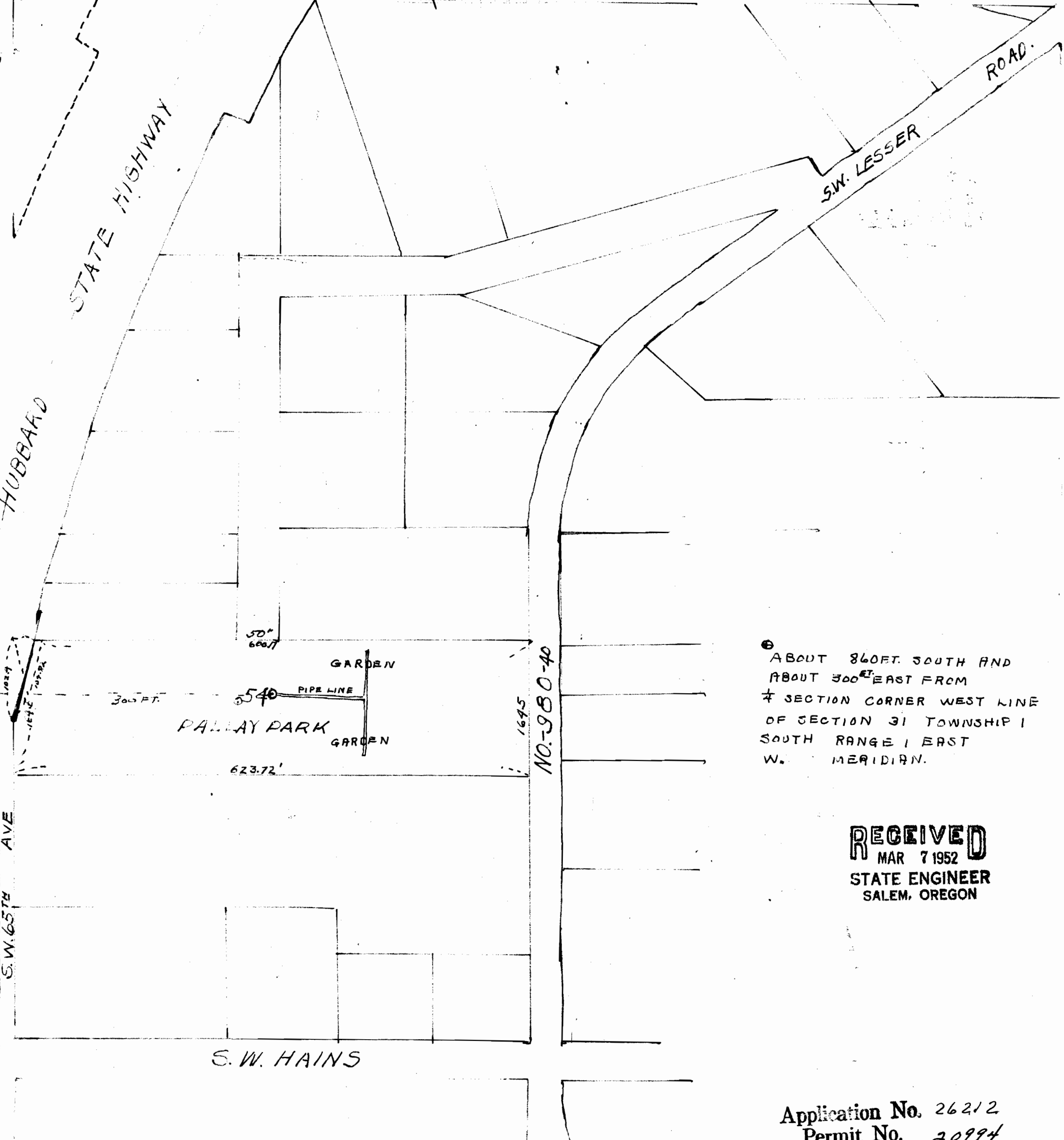

⑥ ABOUT 860 FT. SOUTH AND  
 ABOUT 300<sup>FT</sup> EAST FROM  
 7 SECTION CORNER WEST LINE  
 OF SECTION 31 TOWNSHIP 1  
 SOUTH RANGE 1 EAST  
 W. MERIDIAN.

**RECEIVED**  
 MAR 7 1952  
 STATE ENGINEER  
 SALEM, OREGON

Application No. 26212  
 Permit No. 20994