

5258

# MAP OF W.O. DENNIS AND LEE SAVELY PRIVATE IRRIGATION AND DOMESTIC PURPOSE DITCH

5  
3  
3

I, J.J. CHISHOLM, OF PENDLETON, OREGON, DO  
HEREBY CERTIFY THAT THIS MAP WAS MADE FROM NOTES  
TAKEN DURING AN ACTUAL SURVEY MADE BY ME ON  
JUNE 27, 1914, AND THAT IT CORRECTLY  
REPRESENTS THE WORKS DESCRIBED IN THE  
ACCOMPANYING APPLICATION, TOGETHER WITH THE  
LOCATION OF STREAMS AND OTHER DITCHES IN THE  
IMMEDIATE VICINITY, AND HAS WRITTEN THEREON THE  
AREA IN EACH SMALLEST LEGAL SUBDIVISION WHICH  
IT IS PROPOSED TO IRRIGATE.

J. J. Chisholm.

N

T. 3 N., R. 28, E. W. M.

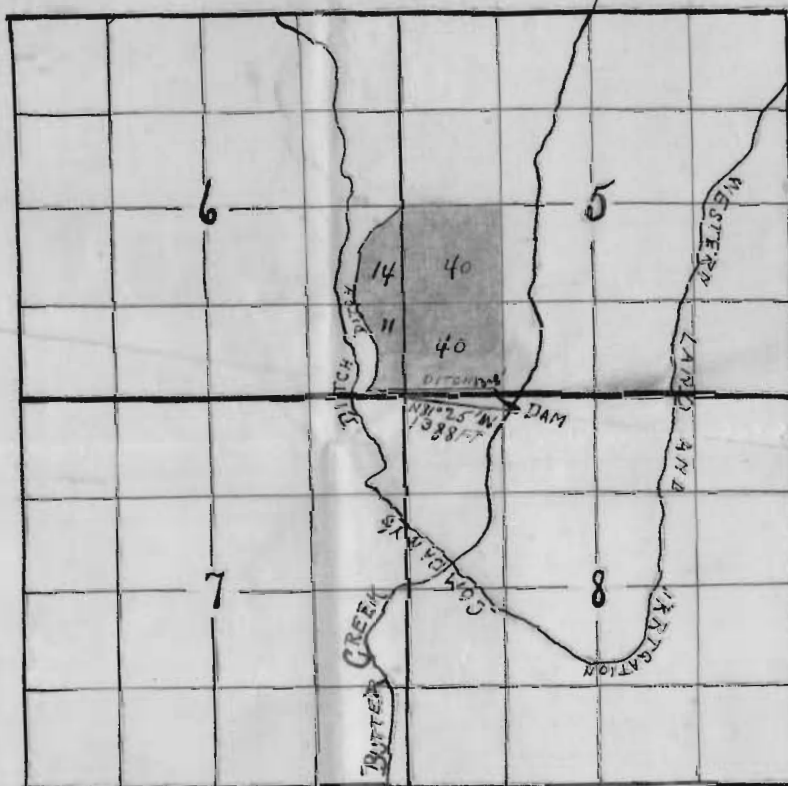

W

E

OFFICE OF STATE ENGINEER  
RECEIVED  
JUL 6 1914  
SALEM, OREGON,

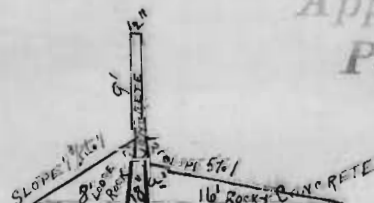
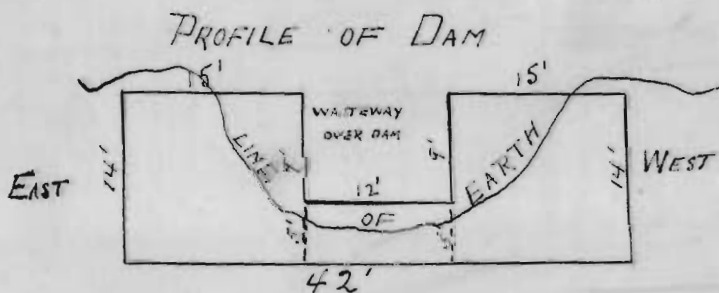

Application No. 3762  
Permit No. 2102

\$