

place of use. N/A
GAL. NO.



2



1 MI.

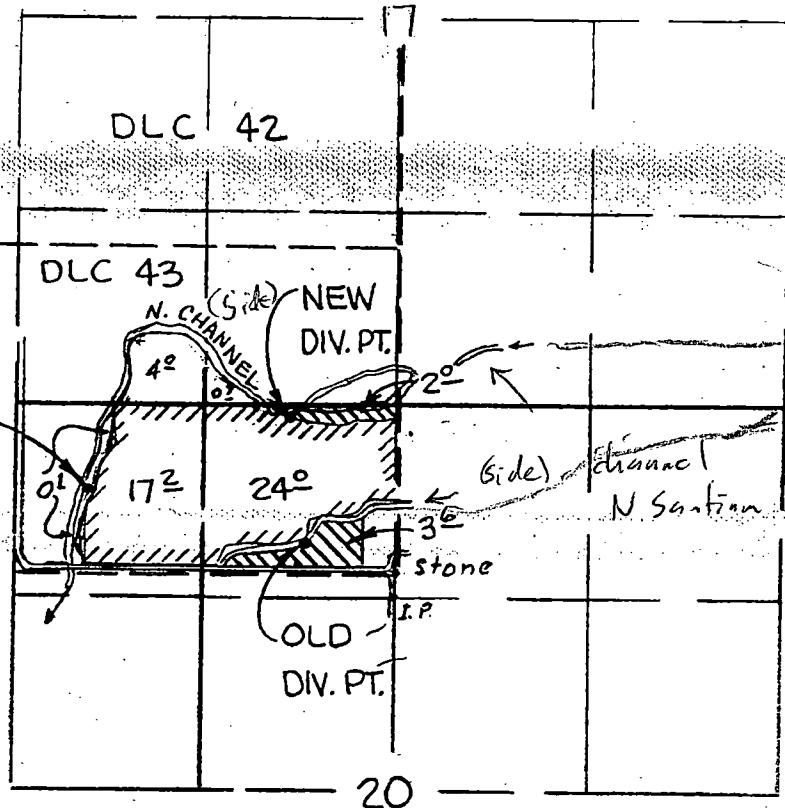

EXIST. C-26421

PRIMARY

THIS MAP WAS PREPARED FOR THE PURPOSE OF IDENTIFYING THE LOCATION OF A WATER RIGHT ONLY AND IS NOT INTENDED TO PROVIDE LEGAL DIMENSIONS OR LOCATION OF PROPERTY OWNERSHIP LINES.

WATER RIGHT MAP FOR

WARREN S. or JANICE GRAY

SURVEYED ON SEPT. 16, 1992

BY:

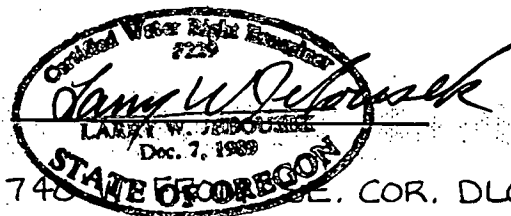

NEW DIV. PT. LOC. 1080' N. & 740' W. COR. DLC 43.
 EXIST. DIV. PT. LOC. 570' N. & 2180' W. " " " " "
 OLD DIV. PT. LOC. 200' N. & 650' W. " " " " "