

T.30S.R.5-6W.W.M.

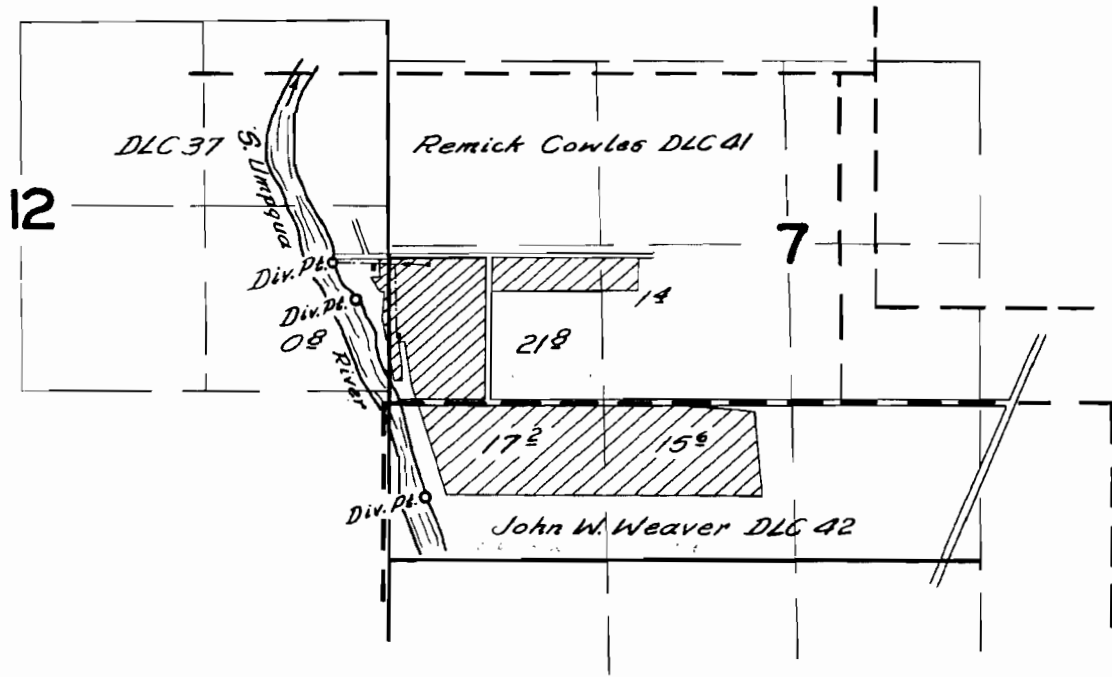

Note: Section and DLC Lines are Located from Douglas County Records

FINAL PROOF SURVEY UNDER

Application No. 26958 Permit No. 21179 ...
IN NAME OF

Glenn N. & Agnes A. Riddle

Surveyed Oct. 3, 1956, by *R.H. Whitby*.....