

SECTIONS 10, 11, 14, & 15; T. 36 S.; R. 2 W., W.M.

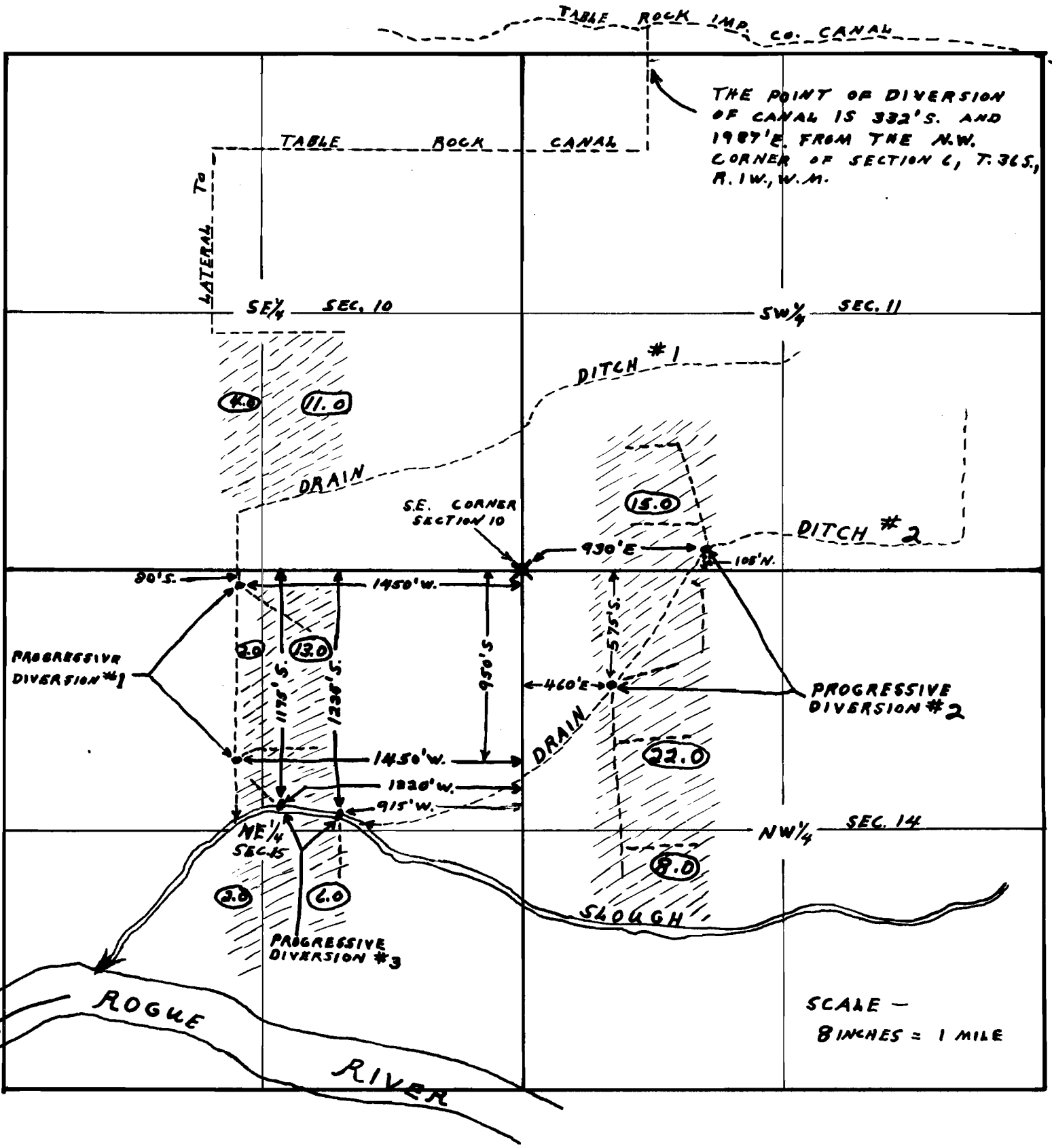

MAP TO ACCOMPANY APPLICATION OF JOHN L. NEALON FOR USE OF WATER FROM ROGUE RIVER, #1 DRAIN DITCH, #2 DRAIN DITCH, AND SLOUGH FOR IRRIGATION PURPOSES.

THIS OFFICE 3-18-52

D. C. Hendrix

Application No. 26999

Permit No. 21410

RECEIVED
MAR 20 1952
STATE ENGINEER
SALEM, OREGON