

TWP. 36, S., R. 3, W.

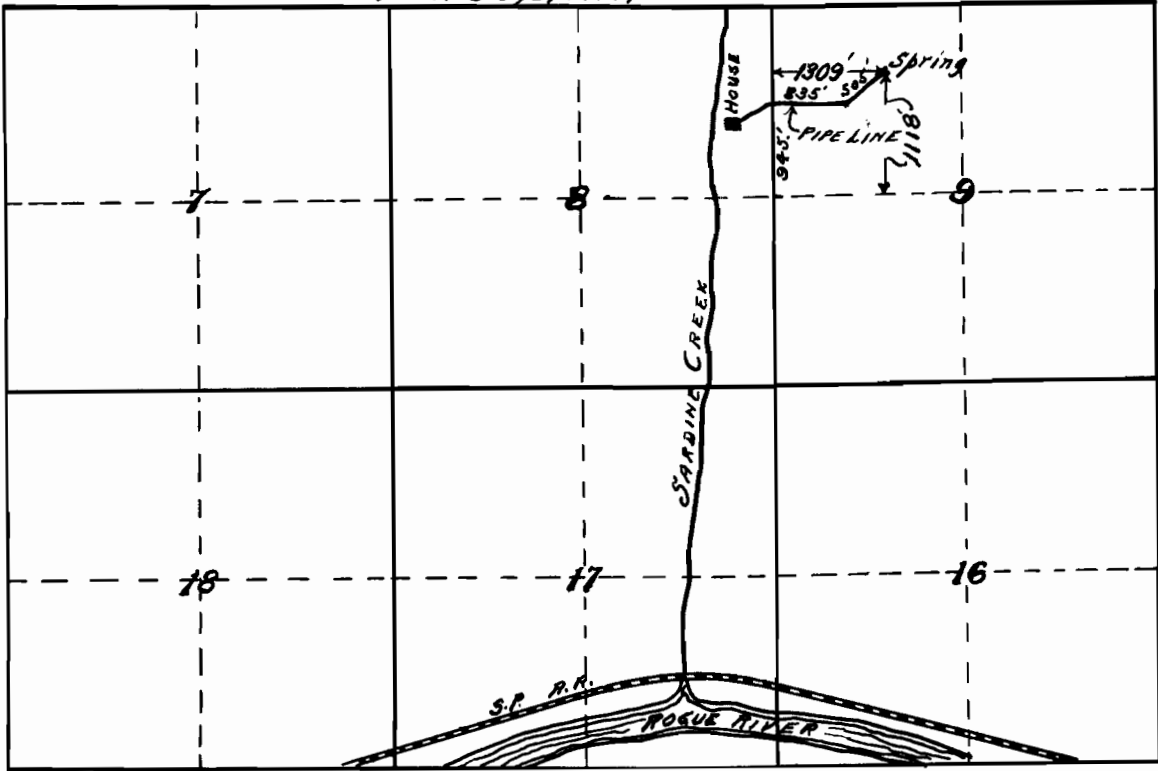

RECORDED
INDEXED
AUG 30 1914
S.W. CORNER

Application No. 3785
Permit No. 2146

I, F.M. Dodge, of Gold Hill, Ore., do hereby certify that this map was made from notes taken in an actual survey made under my supervision on July 10th, and Aug. 26th, 1914, and that it correctly represents the works described in the accompanying application.

F. M. Dodge
Surveyor.

MAP TO ACCOMPANY
WATER RIGHT APPLICATION
OF
ELLEN L. AND MARTHA FIENE,
OF
Gold Hill, Oregon.
Aug. 27th,
1914.