

40-2
Permit 21636

T.40 S.R.8 W.W.M.

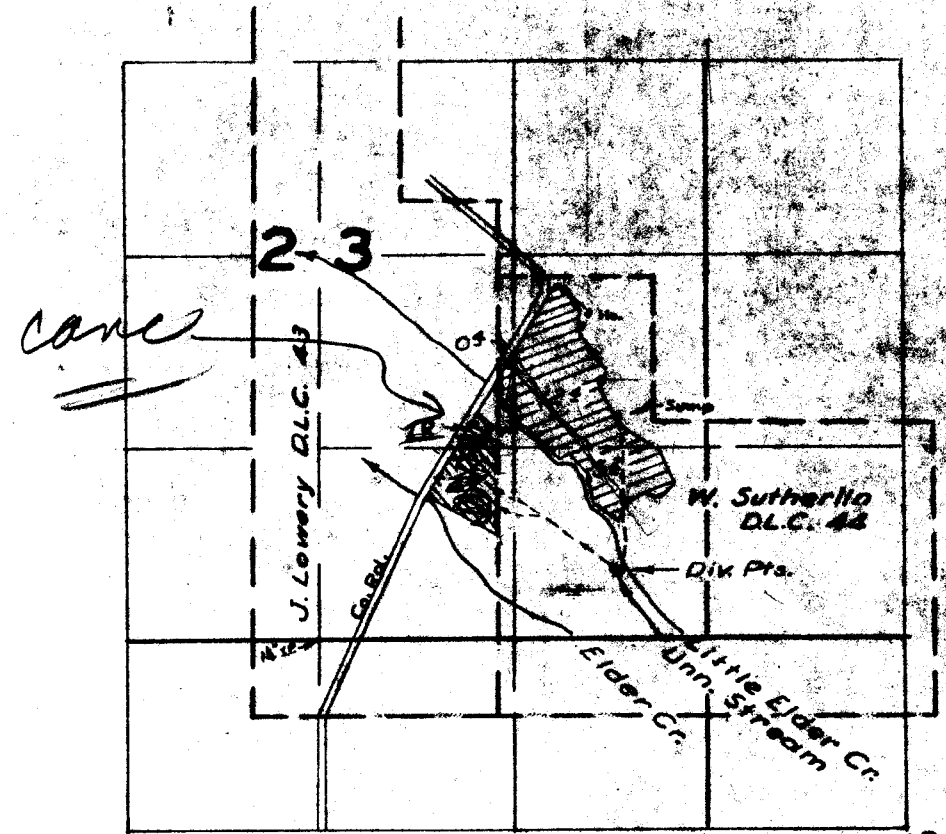

4700fs = .02 cfs per acre

Hanby Buckendahl

7-24-52 from unnamed stream

Supplemental water canceled 8-5-81

FINAL PROOF SURVEY UNDER

Application No. 27488 Permit No. 21636
IN NAME OF

DOUGLAS K HANBY & ARNOLD W. BUCKENDAHL

Surveyed 14 July 1959, by *M. Bick*