

OFFICE OF STATE ENGINEER  
BOISE, ID.  
OCT 24 1911

# MAP of KELSEY LAND and

## KELSEY-MOORE and SUNNY-SLOPE CO. DITCHES

Scale 2"=1 mile

Application No. 1779  
Permit No. 2173

T.6.S. Range 39 E. W.M.

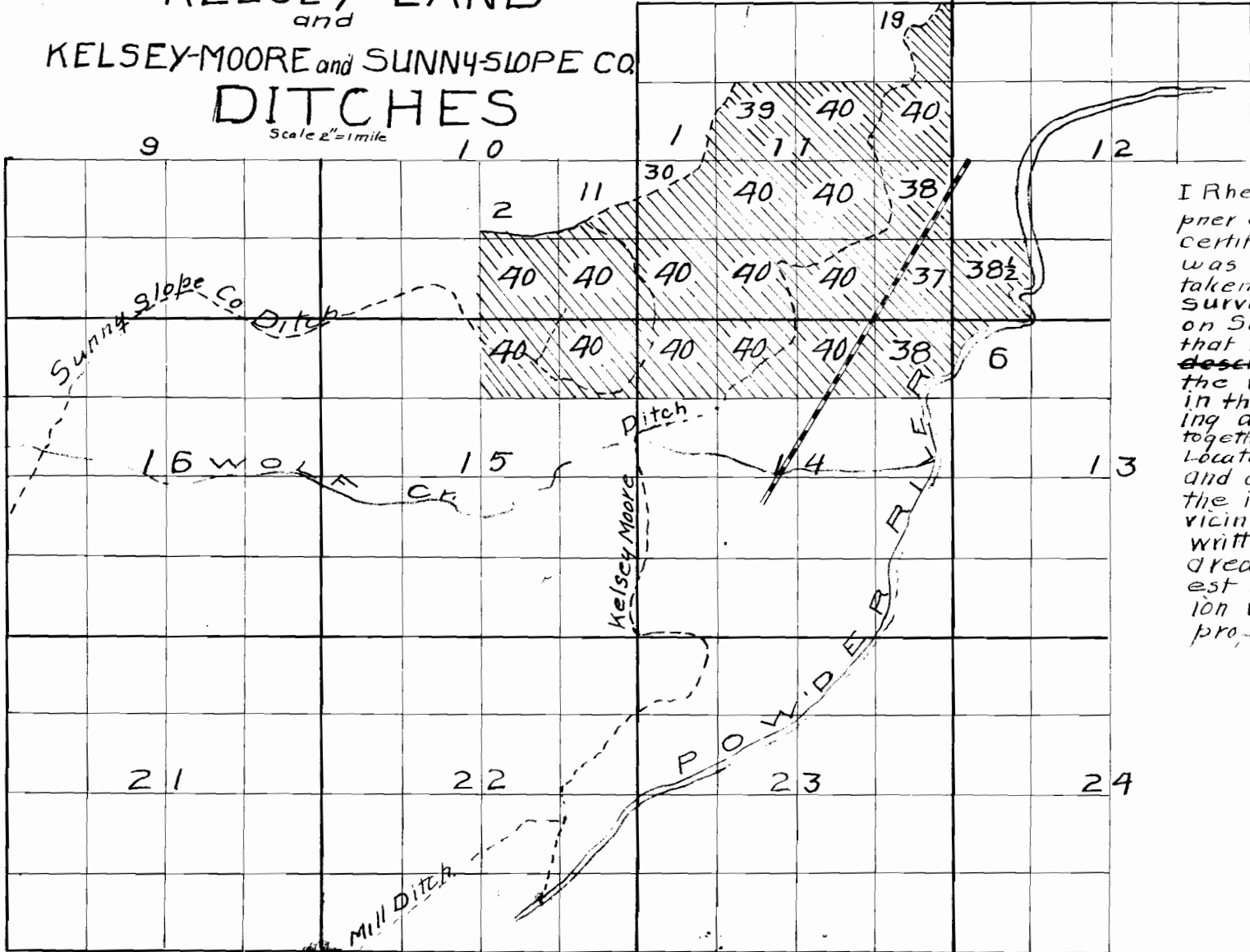

I Rhea Luper of Hep-  
pner Ore, do hereby  
certify that this map  
was made from notes  
taken in an actual  
survey made by me  
on Sept 3 1911 and  
that it correctly  
~~describes~~ represents  
the works described  
in the accompany-  
ing application  
together with the  
location of streams  
and other ditches in  
the immediate  
vicinity and has  
written thereon the  
area in each small-  
est legal subdivis-  
ion which it is  
proposed to irrigate

Rhea Luper