

SECTION 33, T. 33 S., R. 2 W., W.M.

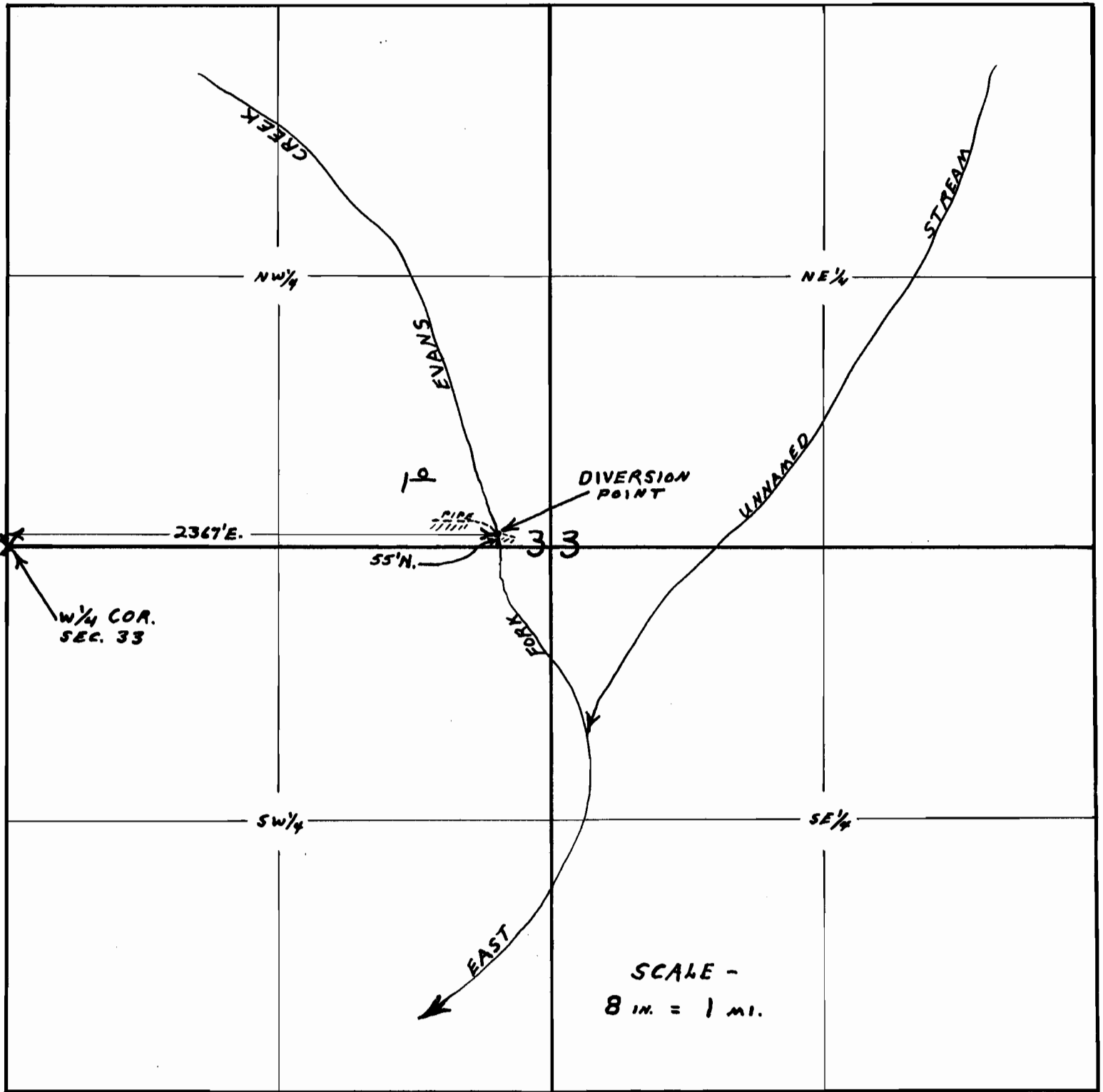

MAP TO ACCOMPANY APPLICATION OF
J.L. WHITE, FOR USE OF WATER FROM
EAST FORK EVANS CREEK FOR
IRRIGATION PURPOSES.

Application No. 27569
Permit No. 21730

THIS OFFICE 8-19-52
David L. Hendrix