

SECTION 10, T. 38 S., R. 3 W., W. M.

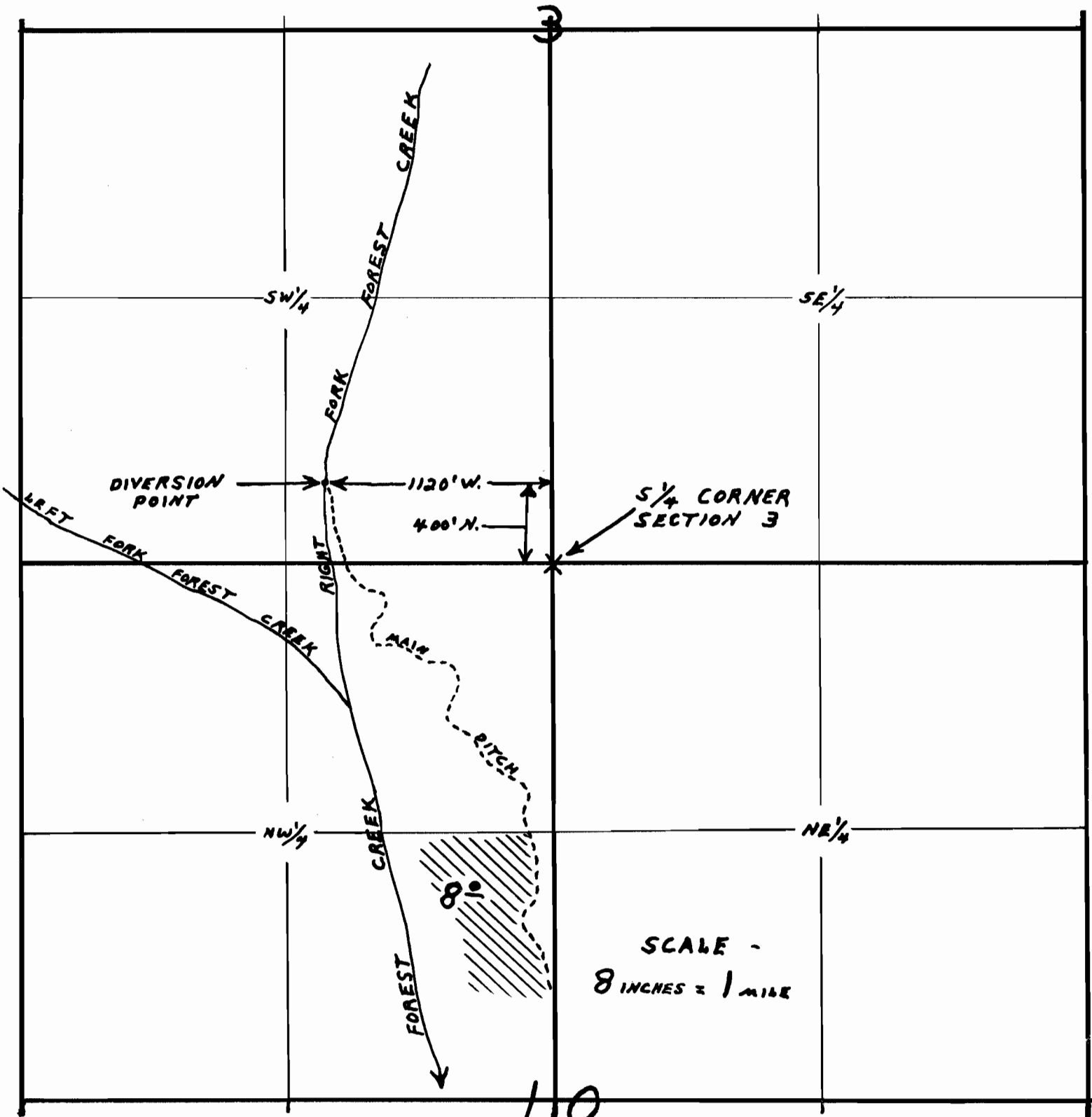

MAP TO ACCOMPANY APPLICATION OF
GERTRUDE E. WINNINGHAM, FOR USE OF
WATER FROM RIGHT FORK FOREST CREEK
FOR IRRIGATION PURPOSES.

Application No. 28467
Permit No. 12304

THIS OFFICE 5-23-53
David G. Hendrix