

# Map of

## Peter Luthi Water Right

SEP 8 1914  
SALEM, OREGON

Application No. 3891  
Permit No. 2435

### CERTIFICATE OF SURVEYOR

I A.M. Austin of Tillamook do hereby certify that this map was made from notes taken during an actual survey made by me on September 3<sup>rd</sup> 1914, and that it correctly represents the works described in the accompanying application, together with the location of streams and other ditches in the immediate vicinity, and has written thereon the area in each smallest legal subdivision which it is proposed to irrigate.

A.M. Austin,  
Surveyor.

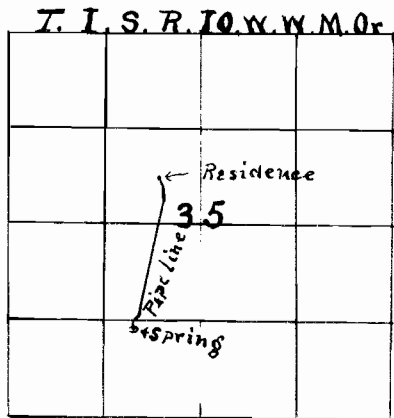

Profile of Dam

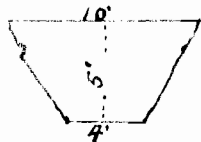

Wasteway.

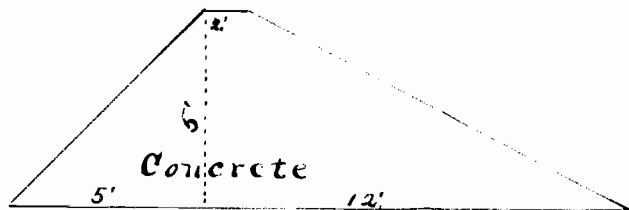
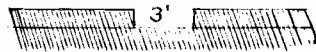

### Field Notes of pipeline

Beginning at the Spring which is 61.01 chains south and 26.16 chains East of the N.W. corner of section 35. T. 1. S. R. 10. W.

Thence N. 10 1/2° W. 0.58 chains

Thence N. 10 1/2° W.	0.58 chains
" N. 29° E.	2.22 "
" N. 11° E.	24.75 "
" N. 8° W.	2.20 "
" N. 30° W.	1.78 "

To the end of the pipe line at Peter Luthi's residence.