

TOWNSHIP No 6 SOUTH RANGE No 36 EAST WILLAMETTE MERIDIAN OREGON

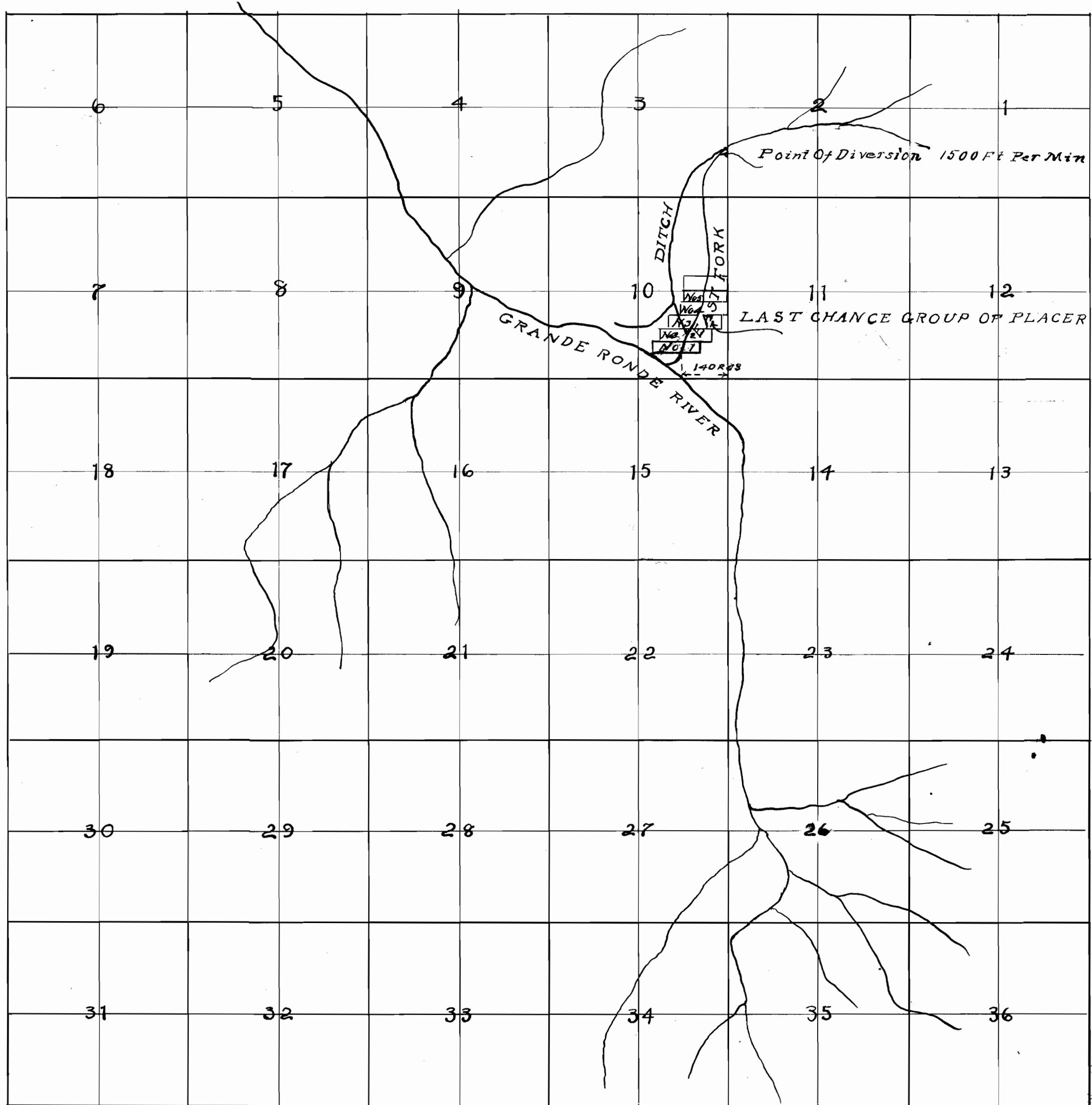

RECORDED
OCT 18 1881
S.W. CORNER

3728
2254

This is to certify that this map shows approximately the correct location of the water-right location of the parties named hereon as taken and plotted from the U. S. Land Office Records and from notes given me by the Locators,

J. L. SLATER,
Draughtsman

PLAT SHOWING WATER LOCATION OF M. A. STEPHENSON AND H. REDELL