

Section 5 Township 41 South Range 13 West

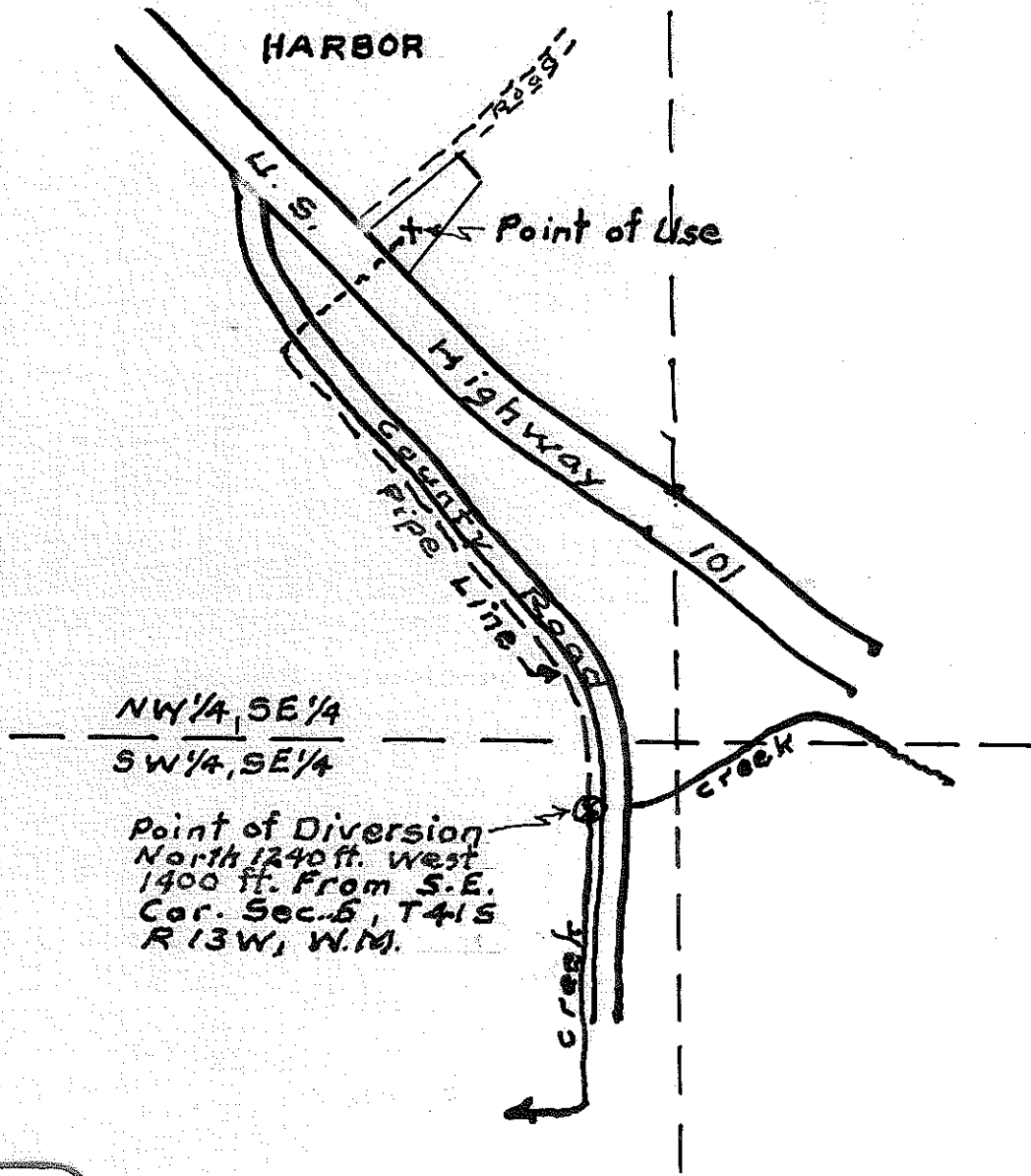

Point of Diversion
 North 1240 ft. West
 1400 ft. From S.E.
 Cor. Sec. 6, T41S
 R 13W, W.M.

REGISTERED
OREGON
 LAND SURVEYOR

Charles T. M. Echols

JAN. 1, 1945
 Charles T. M. Echols
 87

RECEIVED
 SEP 3 1953
 STATE ENGINEER
 SALEM, OREGON

Russell D. Messer
 Harbor, Oregon

Water Permit
 Application Map

Application No. 28760
 Permit No. 22621

August 1953 Scale: 1" = 200'

28760