

Map of the Christy Ditch

Sec. 12 T. 38 S. R. 8 W.

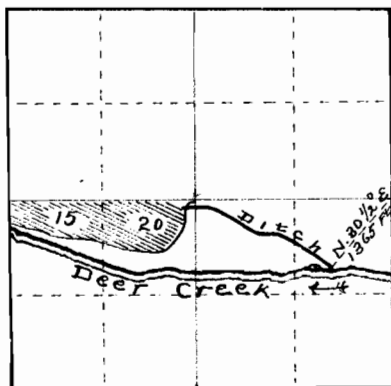

3990
1776

I, Horace C. Hall, of Grants Pass, Oregon, do hereby certify that this map was made from notes taken during an actual survey made by me on Nov. 19, 1914, and that it correctly represents the works described in the accompanying application, together with the location of streams and other ditches in the immediate vicinity, and has written thereon the area in each smallest legal subdivision which it is proposed to irrigate.

Horace C. Hall
Surveyor.