

3295

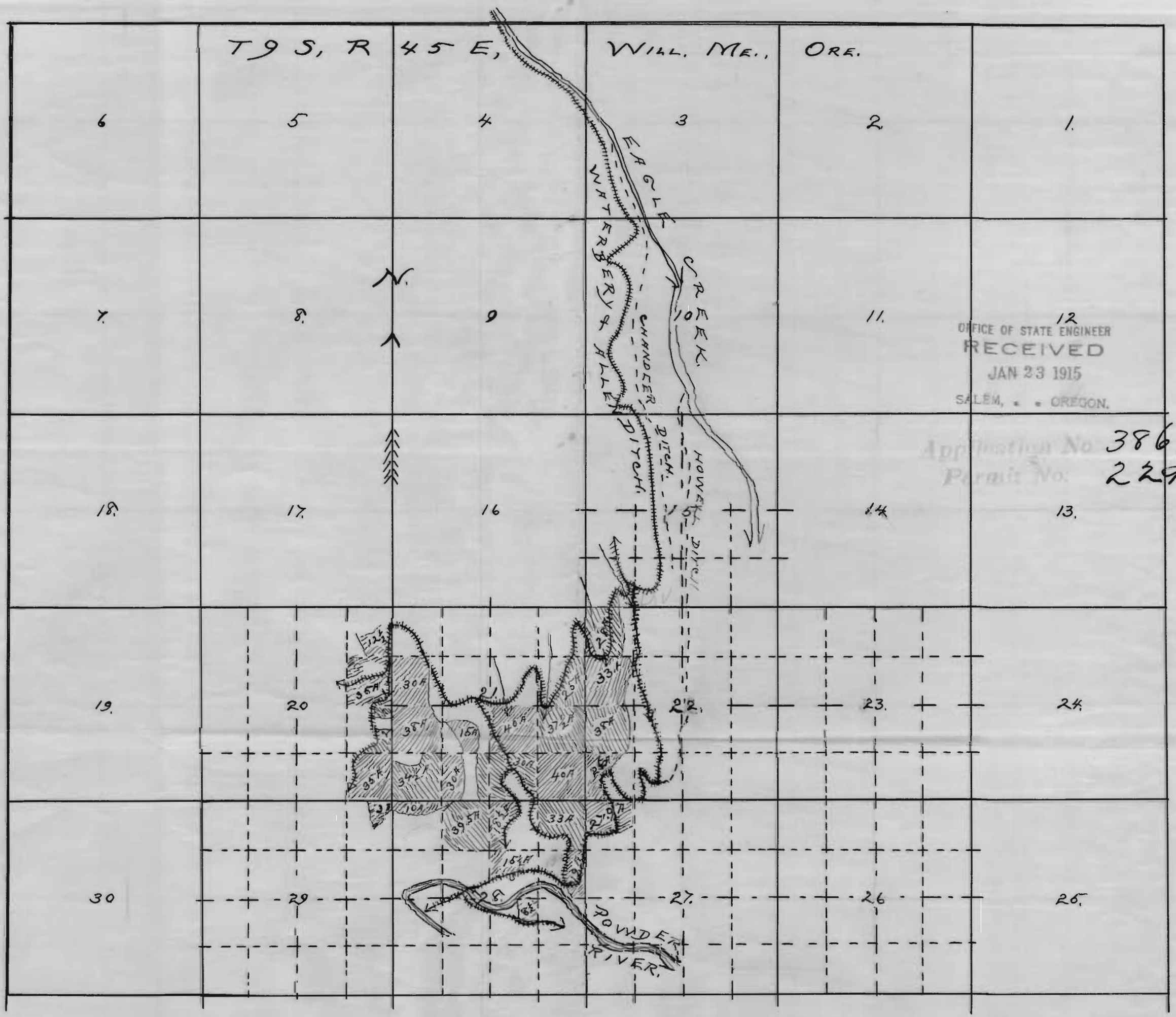

3295

3295

OFFICE OF STATE ENGINEER  
 RECEIVED  
 JAN 23 1915  
 SALEM, OREGON.

Application No. 3862  
 Permit No. 2292

**SKETCH**

SHOWING  
 THE LANDS TO BE SERVED WITH  
 THE WATER COLLECTED FROM  
 THE FOUR GULCHES LEADING IN  
 TO THE LOWER PORTION OF THE  
 WATERBERY & ALLEN DITCH &  
 LAYING IN SECS. 20, 21, 22, 27, 28 & 29,  
 T9S, R45E, WILL. MER., OREGON.  
 SCALE, ONE INCH = 40 FT.  
 DRAWN JAN. 20, 1915.

Ira L. Hoffman,  
 Surveyor.

**CERTIFICATE OF SURVEYOR.**

I, IRA L. HOFFMAN OF BAKER, ORE., DO HEREBY  
 CERTIFY THAT THIS MAP WAS MADE FROM DATA  
 TAKEN FROM THE STATE ENGINEER'S "POWDER  
 RIVER ADJUDICATION TOWNSHIP MAP" & THAT IT  
 CORRECTLY REPRESENTS THE DATA TAKEN THERE-  
 FROM IN RE OF THE WATERBERY & ALLEN DITCH  
 & TOGETHER WITH THE LOCATION OF THE STREAMS  
 AND OTHER DITCHES IN THE IMMEDIATE VICINITY &  
 HAS WRITTEN THEREON THE AREA IN EACH LEGAL  
 SUBDIVISION WHICH IT IS PROPOSED TO IRRIGATE.

Ira L. Hoffman,  
 Surveyor.

3295

3295