

SECTION 14, T. 38 S., R. 2 W., W.M.

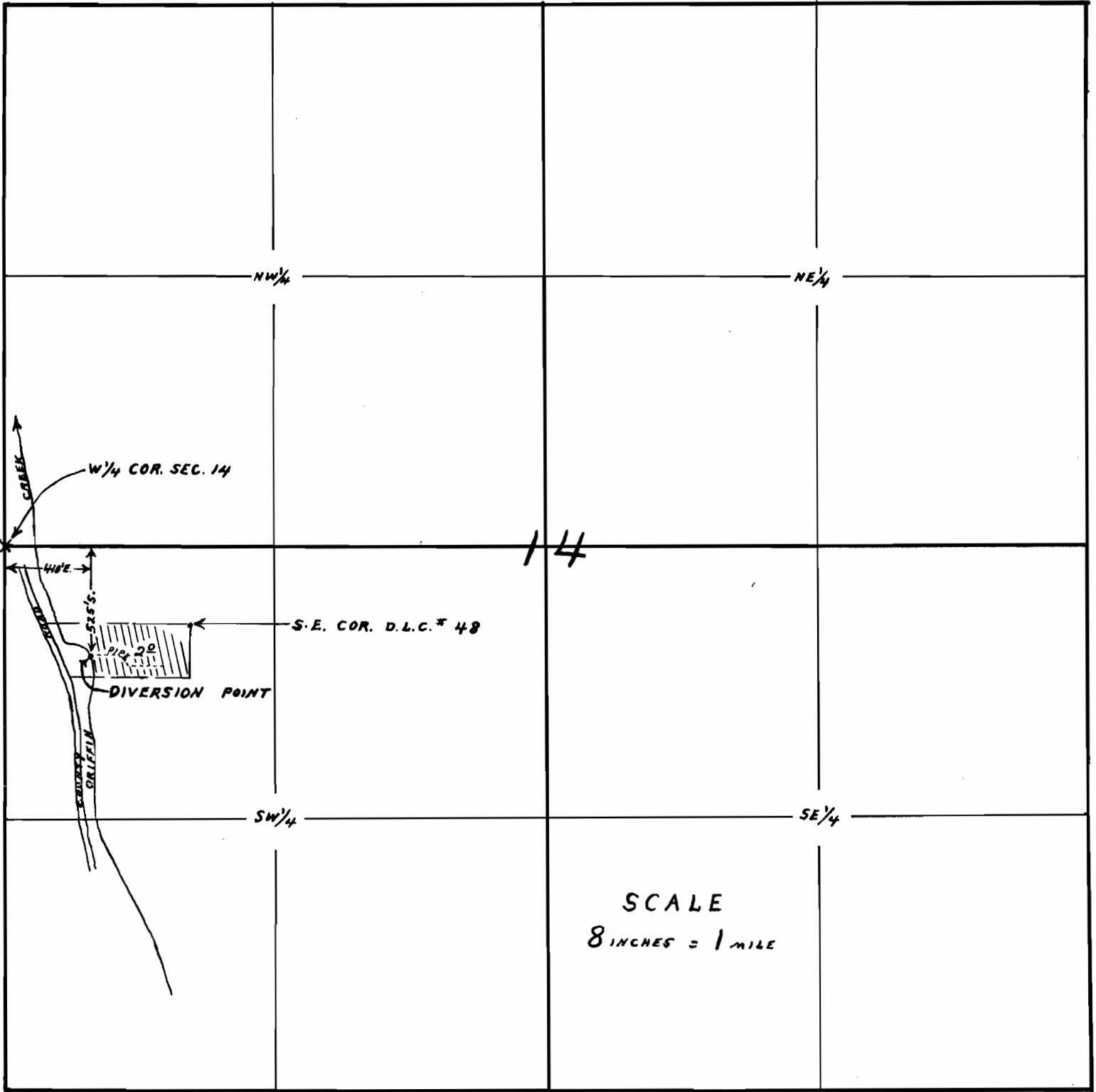

MAP TO ACCOMPANY APPLICATION OF
DONALD E. AARSETH, FOR USE OF WATER
FROM GRIFFIN CREEK FOR IRRIGATION
PURPOSES.

THIS OFFICE 4/19/54
David b. Hendrix

Application No. 29128
Permit No. 22928