

MAP

Accompanying Application for Permit
to Appropriate Water
of Life Saving Creek
Dec. 7, 1914.

Scale: 2 in = 1 mi.

I. R. E. Jackson, of Bar View, do hereby certify that this map was made from notes taken during an actual survey made by me on Dec. 7, 1914, and that it correctly represents the works described in the accompanying application, together with the location of streams and other ditches in the immediate vicinity and has written thereon the area in each smallest legal subdivision which it is proposed to irrigate

I. R. E. Jackson
Surveyor.

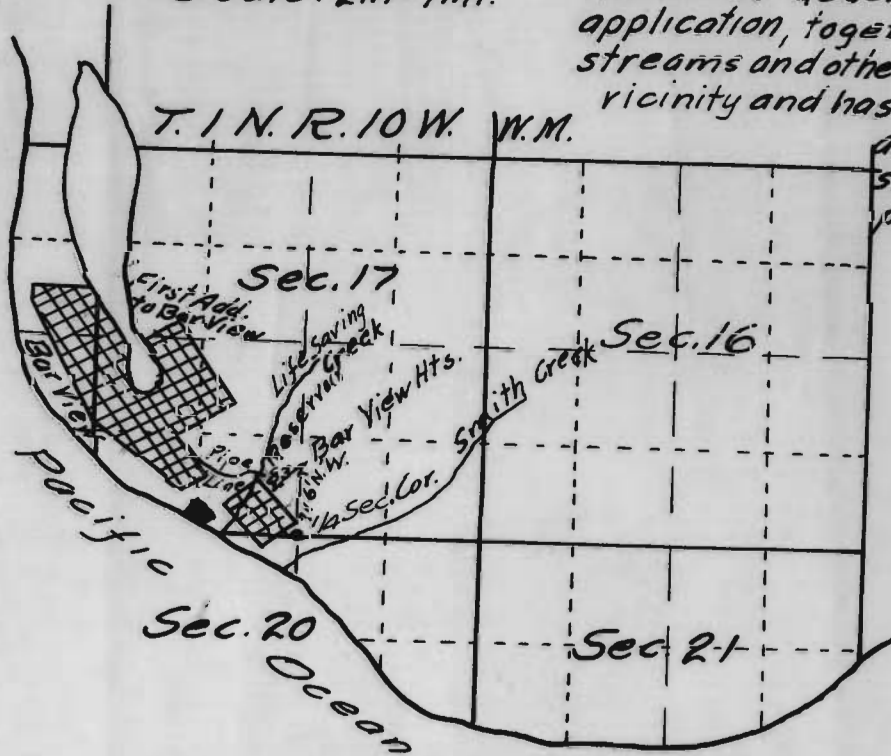

RECEIVED
DEC 12 1914
SALEM, OREGON

Application No. 4023
Permit No. 2306

4053

RECEIVED
DEC 15 1914
SALEM, OREGON

7053