

T. 34 S., R. 1 W., W. M.

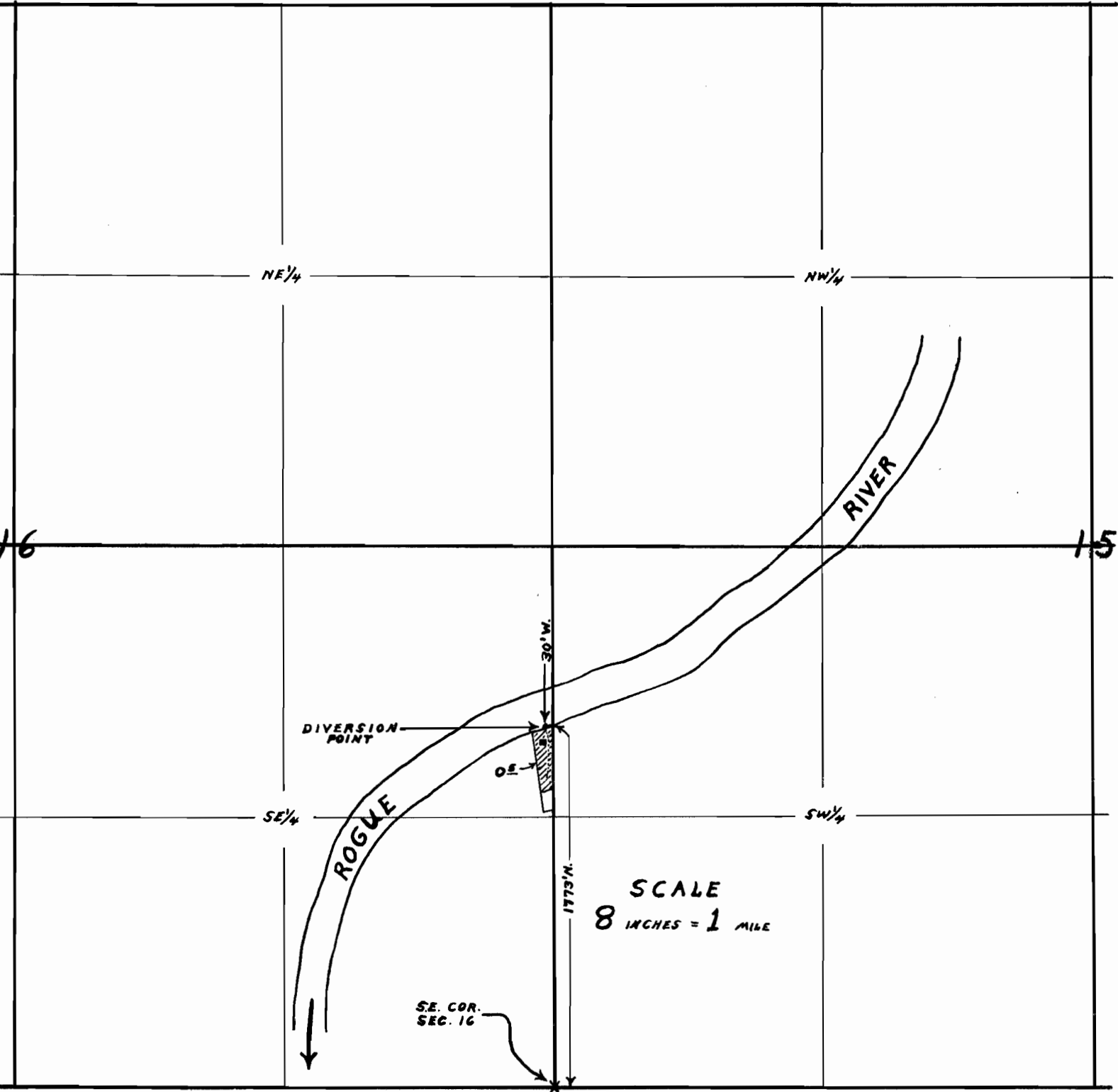

MAP TO ACCOMPANY APPLICATION OF
CHARLES K. TODD, FOR USE OF WATER
FROM ROGUE RIVER FOR IRRIGATION
PURPOSES.

THIS OFFICE 10-9-54
David L. Hendrix W.M.

Application No. 29518
Permit No. 23206

29518