

RECEIVED

JUL 15 1954

STATE OF OREGON
COUNTY OF JEFFERSON

33

T13S JEFFERSON COUNTY

T14S

DESCHUTES COUNTY
CROOK COUNTY

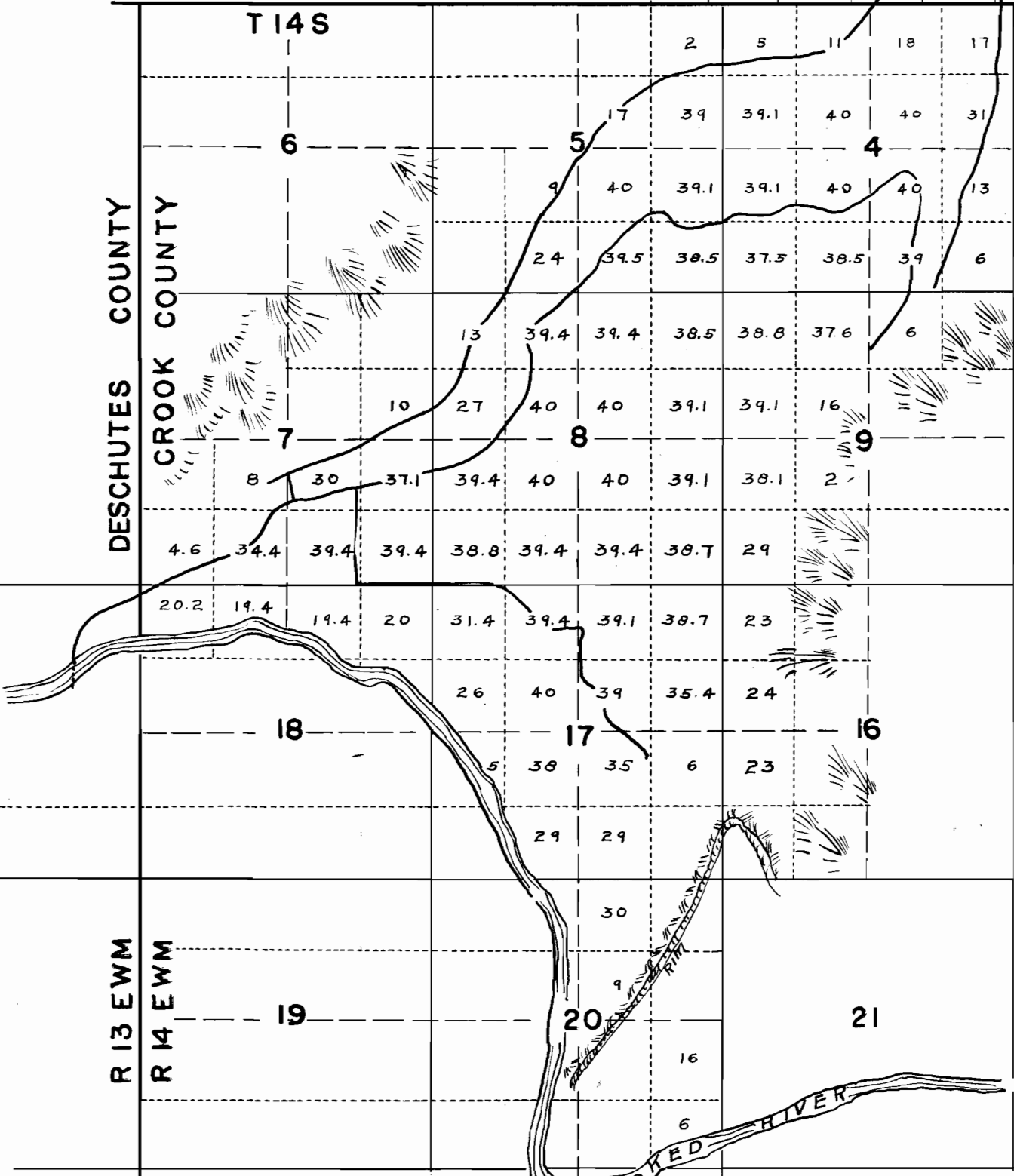

MAP
 CROOK COUNTY MUNICIPAL
 IMPROVEMENT DISTRICT NUMBER ONE
 APPLICATION R13179
 CRANE PRAIRIE RESERVOIR
 SHOWING ACRES TO BE IRRIGATED
 BY
 CROOK COUNTY MUNICIPAL
 IMPROVEMENT DISTRICT NUMBER ONE

REGISTERED
 OREGON
 LAND SURVEYOR

E. Mansfield
 June 15, 1954

MARCH 10, 1944
 Ellithorpe G. Mansfield
 10

Application No. R-13179
 13180
 Permit No. R-1687
 23256

RECEIVED
 JUL 15 1954
 STATE ENGINEER
 SALEM, OREGON

T17S
 T18S

T18S
 T19S

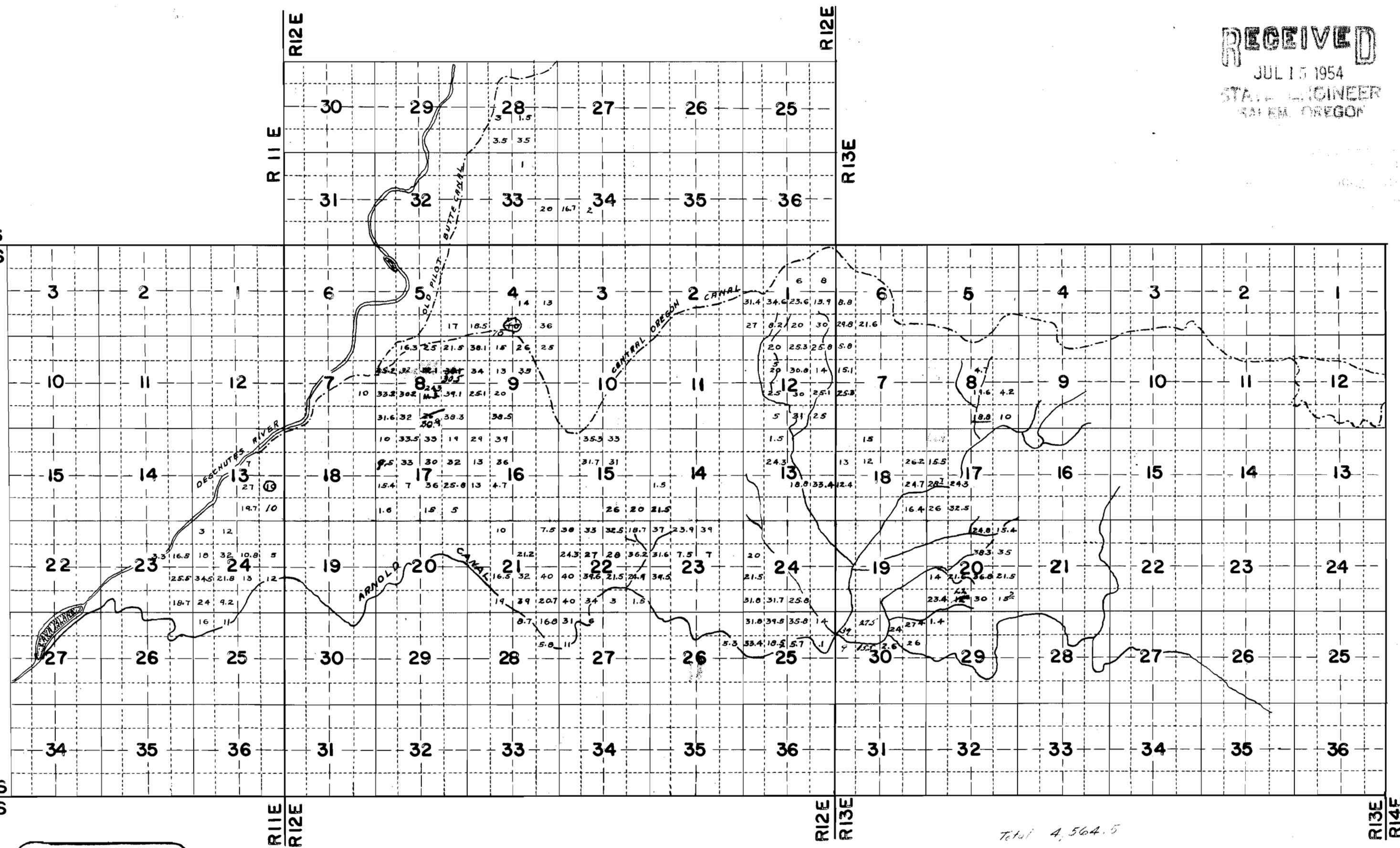

Total 4,564.5

REGISTERED
 OREGON
 LAND SURVEYOR
 E.M. Mansfield
 July 12, 1954
 MARCH 10, 1944
 Ellithorpe G. Mansfield
 10

Note: Prepared from information and data
 furnished by officials of Arnold Irrigation District

ARNOLD IRRIGATION DISTRICT
 DESCHUTES COUNTY OREGON

Application No. R-13179
 13180
 Permit No. R-1687
 23256

Drawn by E.G.M.
 Date July 12, 1954
 Scale 1" = 1 mile

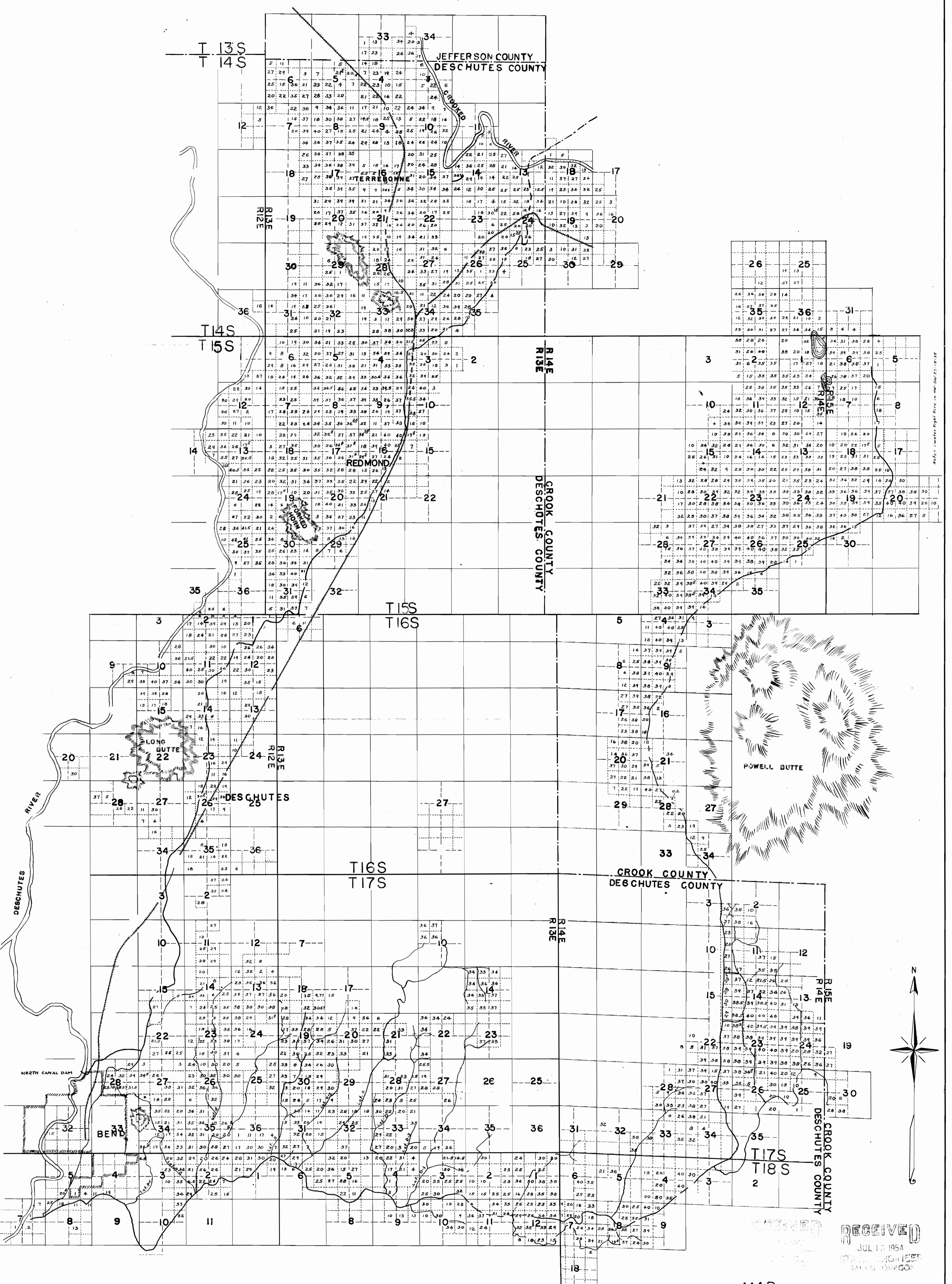

RECEIVED
 JUL 15 1954
 STATE ENGINEER
 OREGON

MAP

CENTRAL OREGON IRRIGATION DISTRICT

APPLICATION R13179
 CRANE PRAIRIE RESERVOIR
 SHOWING ACRES TO BE IRRIGATED

BY
 CENTRAL OREGON IRRIGATION DISTRICT

Application No. R-13179
 13180
 Permit No. R-1687
 23258

REGISTERED
 OREGON
 LAND SURVEYOR
 Ellithorpe G. Mansfield
 JUNE 16, 1954

MARCH 10, 1944
 Ellithorpe G. Mansfield
 10

Drawn by E.G.H.
 Checked by J.W.B.
 Date June 16, 1954
 Scale 1"=1 mile