

MAP  
 TO ACCOMPANY APPLICATION  
 TO APPROPRIATE THE PUBLIC WATERS  
 OF THE STATE OF OREGON

CHARLES A. SHERMAN & SON - APPLICANTS

SCALE: 6" = 1 MILE.

I, PAUL R. REVIS OF BURNS, OREGON, DO HEREBY CERTIFY THAT THIS MAP  
 WAS MADE FROM NOTES TAKEN DURING AN ACTUAL SURVEY MADE BY  
 ME ON MAY 14-29, 1948; THAT THE MONUMENT SHOWN ON THIS MAP  
 CONSISTING OF AN IRON PIPE IS N 42° 43' W, 317.0' FROM THE E 1/4  
 OF SECTION 23, TWP. 19 S., RANGE 23 EAST W.M.

OREGON LICENSE NO. 2511.

*Paul R. Revis*  
 Registered Professional Engineer.

*Paul R. Revis*

RANGE 23 EAST W.M.

TWP  
19  
S

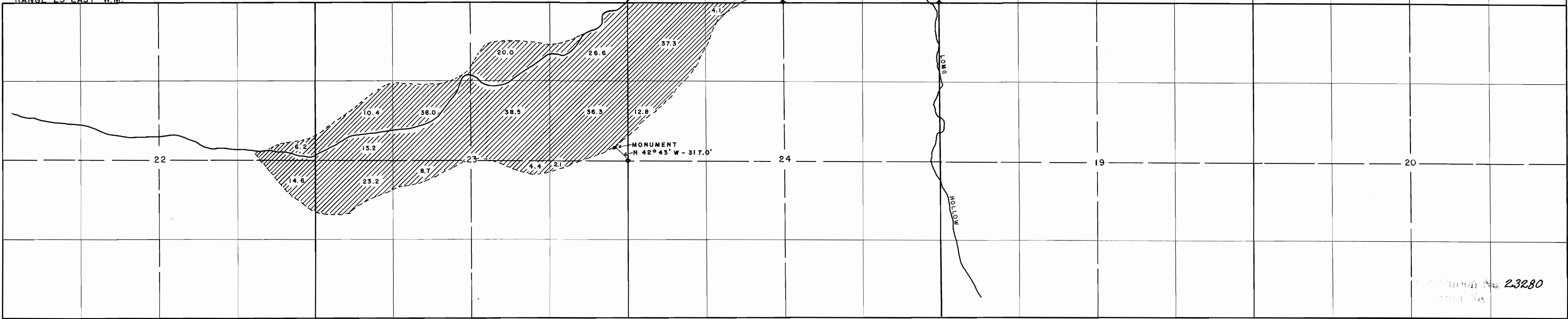

RANGE 24 EAST W.M.

TWP  
19  
S

N 15° 00' E 310.0'  
 POINT OF DIVERSION  
 TWELVE MILE CREEK

S 73° 56' E 186.5'  
 POINT OF DIVERSION - LILLARD DAM  
 AND NORCROSS CREEK

N 47° 31' W  
 1236.0'  
 POINT OF DIVERSION  
 FREEZEOUT RESERVOIR  
 AND LONG HOLLOW DRAW

MONUMENT  
 N 42° 43' W - 317.0'

23280