

TOWNSHIP NO 12 SOUTH RANGE 39 E.W.M

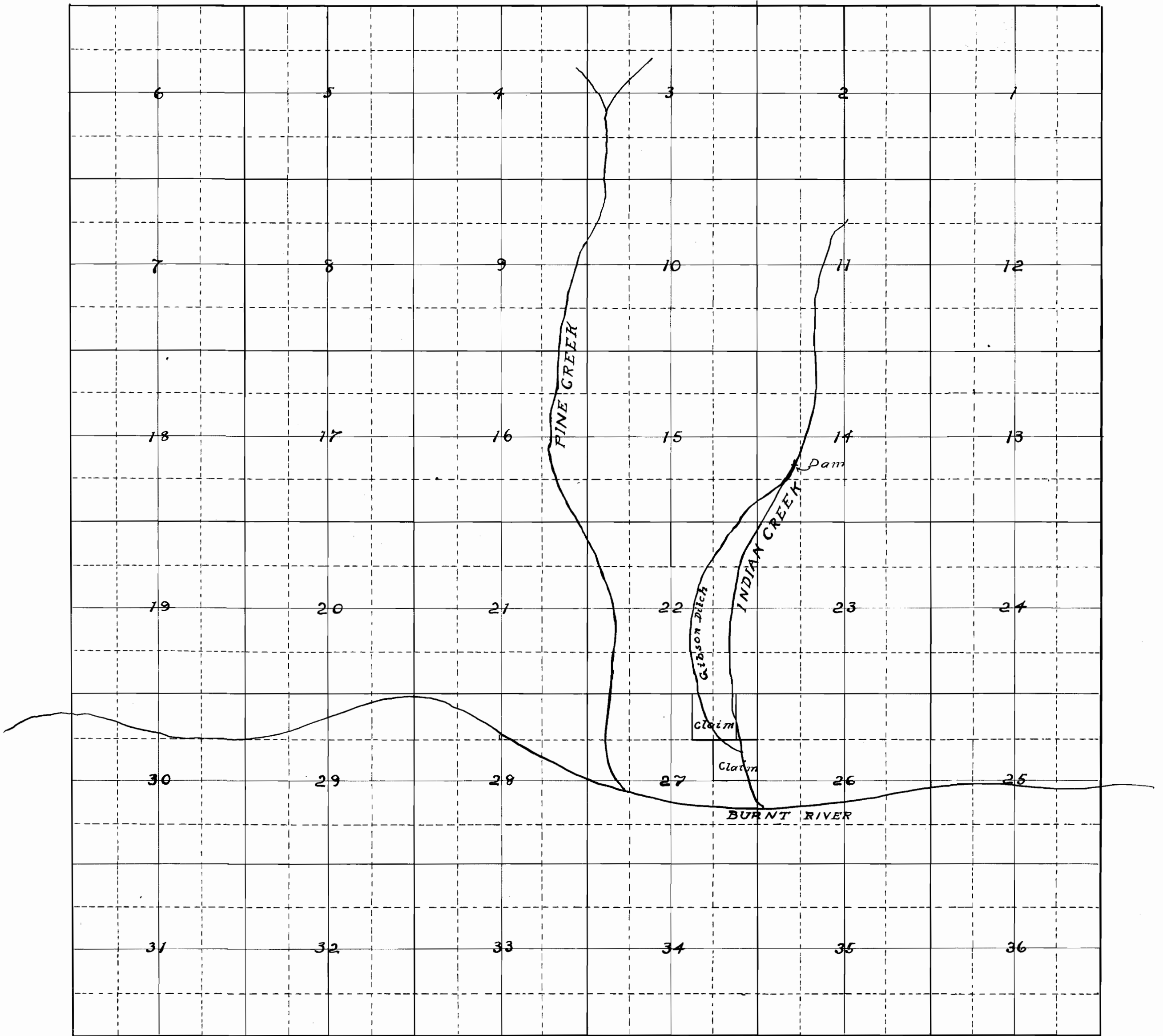

MAP SHOWING WATER APPROPRIATION OF G.R. AND G.W. GIBSON

This is to certify that this map is made from notes furnished me by G.W. Gibson and as far as I am able to ascertain is a correct description of the works in the accompanying application, together with the location of streams and other ditches in the immediate vicinity

J.L. SLATER

Draughtsman.

RECORDED
DEC 2 1914
SALEM OREGON

3997
2337