

ALLEN CREEK RESERVOIR

RESERVOIR HEADGATE

R 21 E

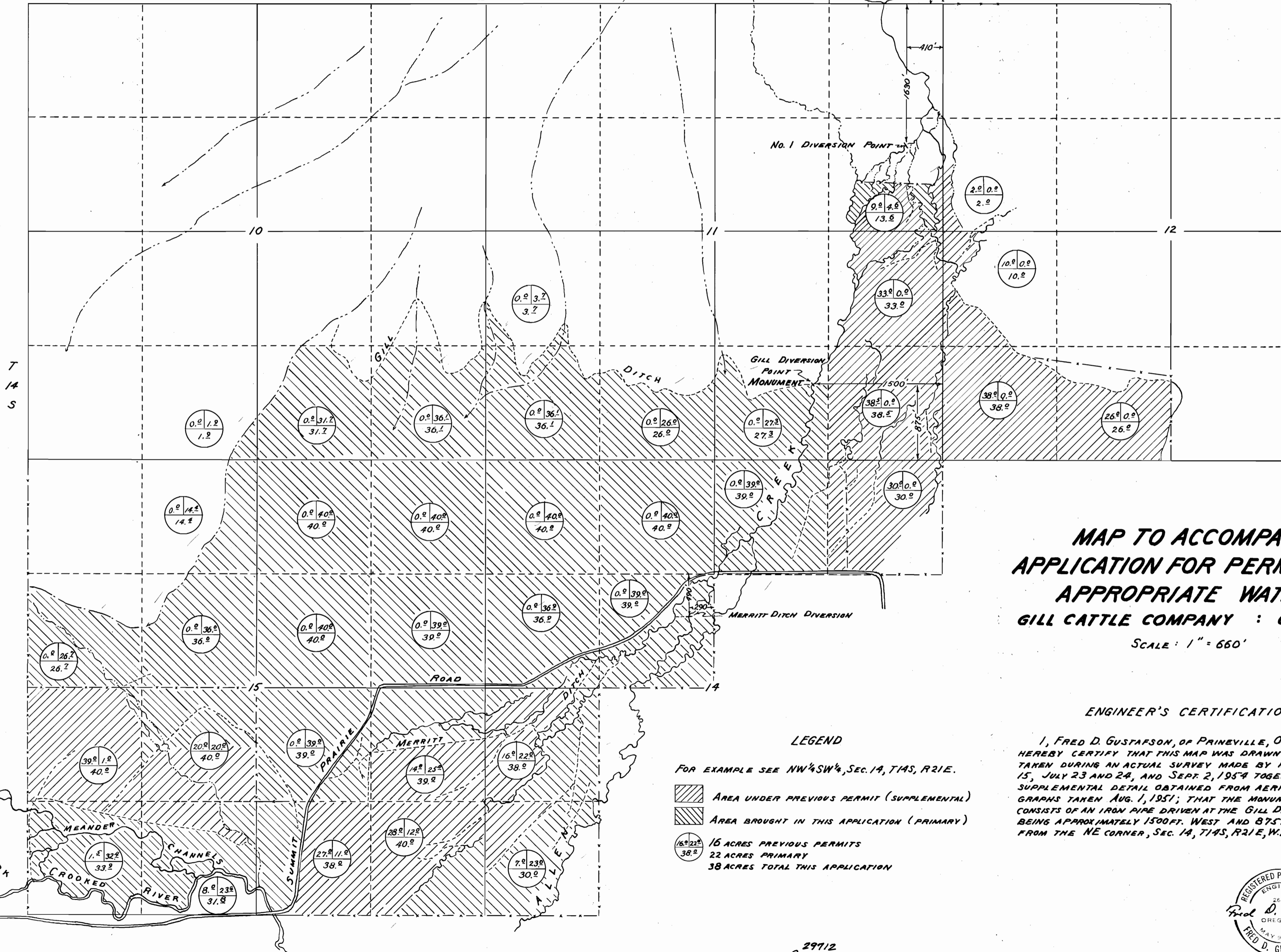

**MAP TO ACCOMPANY
APPLICATION FOR PERMIT TO
APPROPRIATE WATER
GILL CATTLE COMPANY : OWNER**



SCALE : 1" = 660'

ENGINEER'S CERTIFICATION

I, FRED D. GUSTAFSON, OF PRINEVILLE, OREGON DO HEREBY CERTIFY THAT THIS MAP WAS DRAWN FROM NOTES TAKEN DURING AN ACTUAL SURVEY MADE BY ME ON JUNE 15, JULY 23 AND 24, AND SEPT. 2, 1954 TOGETHER WITH SUPPLEMENTAL DETAIL OBTAINED FROM AERIAL PHOTOGRAPHS TAKEN AUG. 1, 1951; THAT THE MONUMENT SHOWN CONSISTS OF AN IRON PIPE DRIVEN AT THE GILL DIVERSION POINT BEING APPROXIMATELY 1500 FT. WEST AND 875 FT. NORTH FROM THE NE CORNER, SEC. 14, T14S, R21E, W.M.

LEGEND

FOR EXAMPLE SEE NW 1/4 SW 1/4, SEC. 14, T14S, R21E.

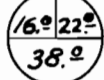
-  AREA UNDER PREVIOUS PERMIT (SUPPLEMENTAL)
-  AREA BROUGHT IN THIS APPLICATION (PRIMARY)
-  16 ACRES PREVIOUS PERMITS
22 ACRES PRIMARY
38 ACRES TOTAL THIS APPLICATION



29712
R-29713
Application No. 23714
Permit No. 2330
R-1710

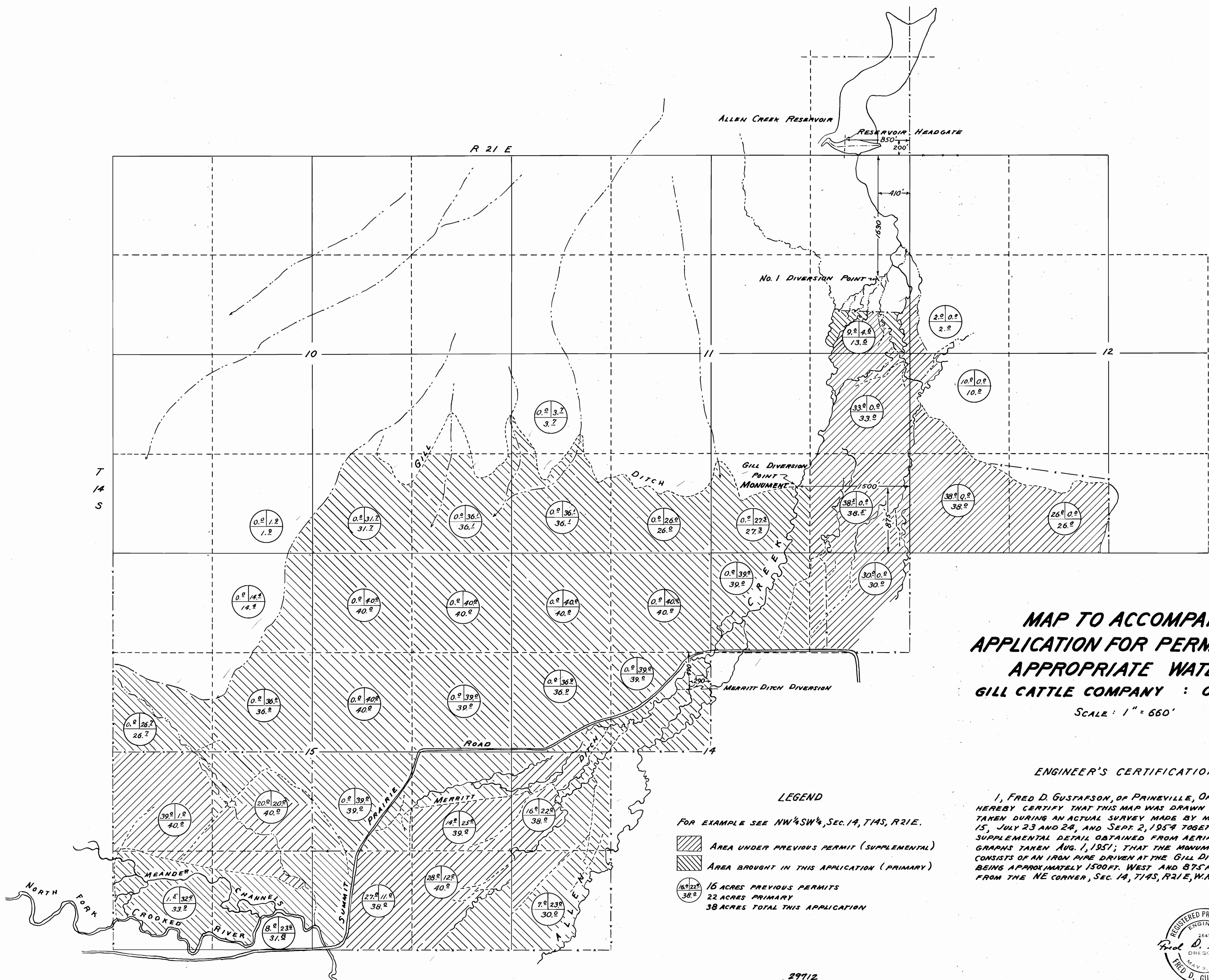

**MAP TO ACCOMPANY
APPLICATION FOR PERMIT TO
APPROPRIATE WATER
GILL CATTLE COMPANY : OWNER**
SCALE : 1" = 660'

ENGINEER'S CERTIFICATION

I, FRED D. GUSTAFSON, OF PRINEVILLE, OREGON DO HEREBY CERTIFY THAT THIS MAP WAS DRAWN FROM NOTES TAKEN DURING AN ACTUAL SURVEY MADE BY ME ON JUNE 15, JULY 23 AND 24, AND SEPT 2, 1954 TOGETHER WITH SUPPLEMENTAL DETAIL OBTAINED FROM AERIAL PHOTOGRAPHS TAKEN AUG. 1, 1951; THAT THE MONUMENT SHOWN CONSISTS OF AN IRON PIPE DRIVEN AT THE GILL DIVERSION POINT BEING APPROXIMATELY 1500 FT. WEST AND 875 FT. NORTH FROM THE NE CORNER, SEC. 14, T14S, R21E, W.M.

LEGEND

- FOR EXAMPLE SEE NW¹/₄SW¹/₄, SEC. 14, T14S, R21E.
- AREA UNDER PREVIOUS PERMIT (SUPPLEMENTAL)
 - AREA BROUGHT IN THIS APPLICATION (PRIMARY)
 - 16⁰ 22⁰ 38⁰ 16 ACRES PREVIOUS PERMITS
22 ACRES PRIMARY
38 ACRES TOTAL THIS APPLICATION



29712
R-29713
Application No. 29714
Permit No. 23301
R-1710
23302