

Plat of the
Walton Pumping Plant
Sec. 9, T. 38 S., R. 7 W., W.M.

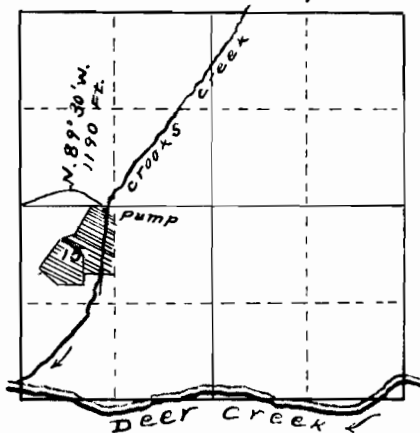

I, Horace C. Hall, of Grants Pass, Oregon, do hereby certify that this map was made from notes taken during an actual survey made by me on Feb. 22, 1915, and that it correctly represents the works described in the accompanying application, together with the location of streams and other ditches in the immediate vicinity, and has written thereon the area in each smallest legal subdivision which it is proposed to irrigate

Horace C. Hall
Surveyor.

4109
2363