

T-5849

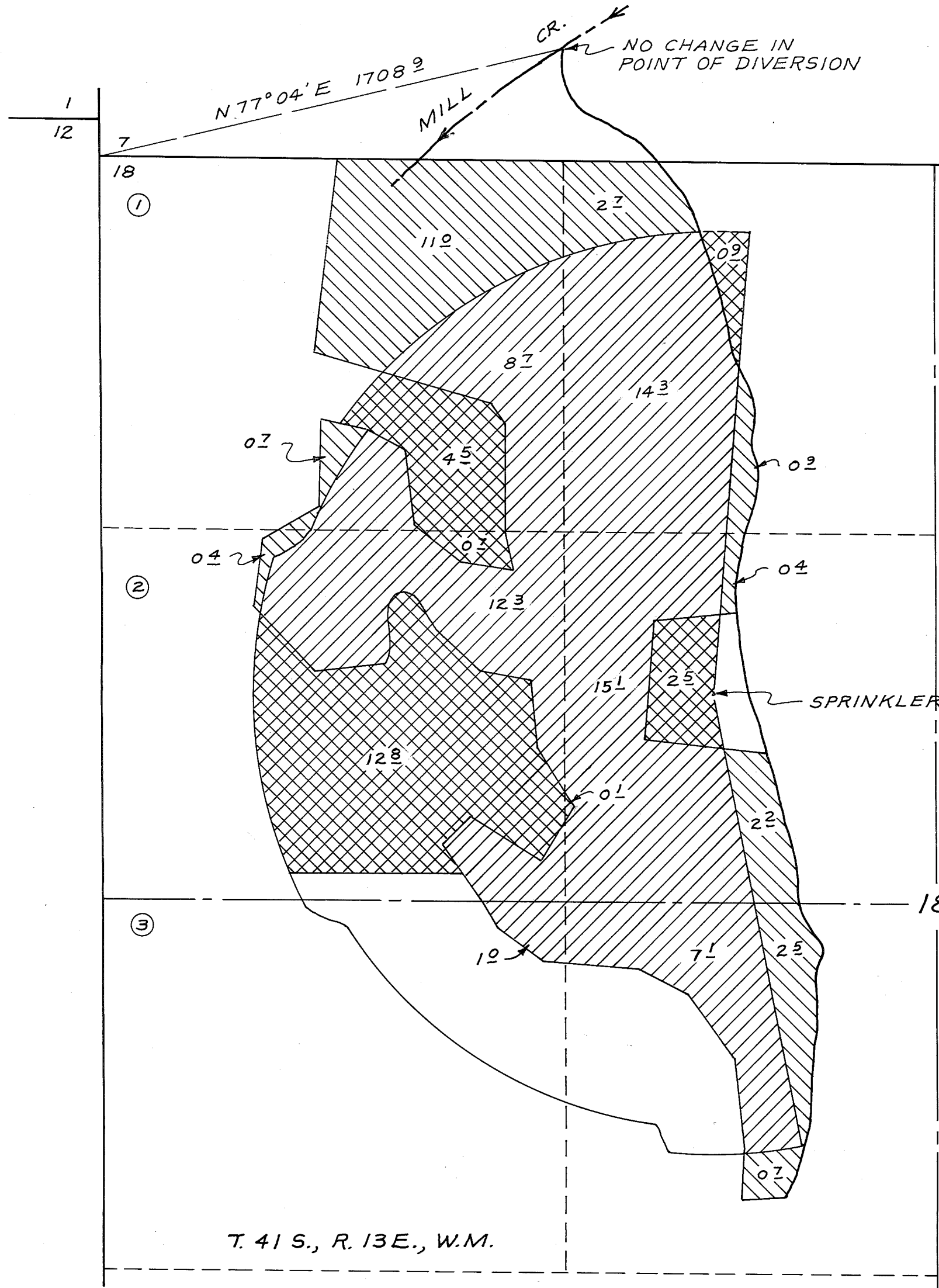

T. 41 S., R. 13 E., W.M.

-  LANDS TO CONTINUE TO BE IRRIGATED UNDER WATER RIGHT CERTIFICATE NO. 3321 & CERT. NO. 2751 = 58.5 ACRES
-  LANDS COVERED BY CERTIFICATE NO. 3321 & CERT. NO. 2751 TO BE TRANSFERRED TO NEW PLACE OF USE = 21.5 ACRES
-  NEW PLACE OF USE FOR TRANSFERRED WATER RIGHTS = 21.5 ACRES

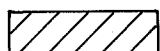
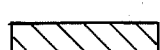
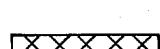
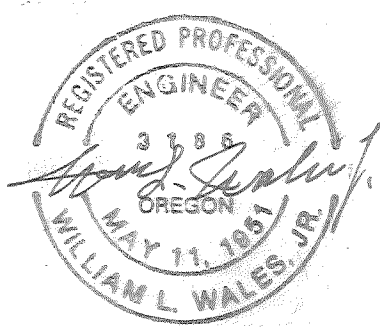

MAP SHOWING WATER RIGHT TRANSFER
 FOR
LOVENESS FARMS
 IN
 SECTION 18, T. 41 S., R. 13 E., W.M.
 KLAMATH COUNTY, OREGON
 Scale: 1" = 400'
 Prepared under direction of WILLIAM L. WALES
 Consulting Engineer
 4512 Clinton Ave.
 Klamath Falls, Or.
 July, 1986