

NW 1/4 SE 1/4
 SEC. 31
 T. 8 S., R. 4 E.

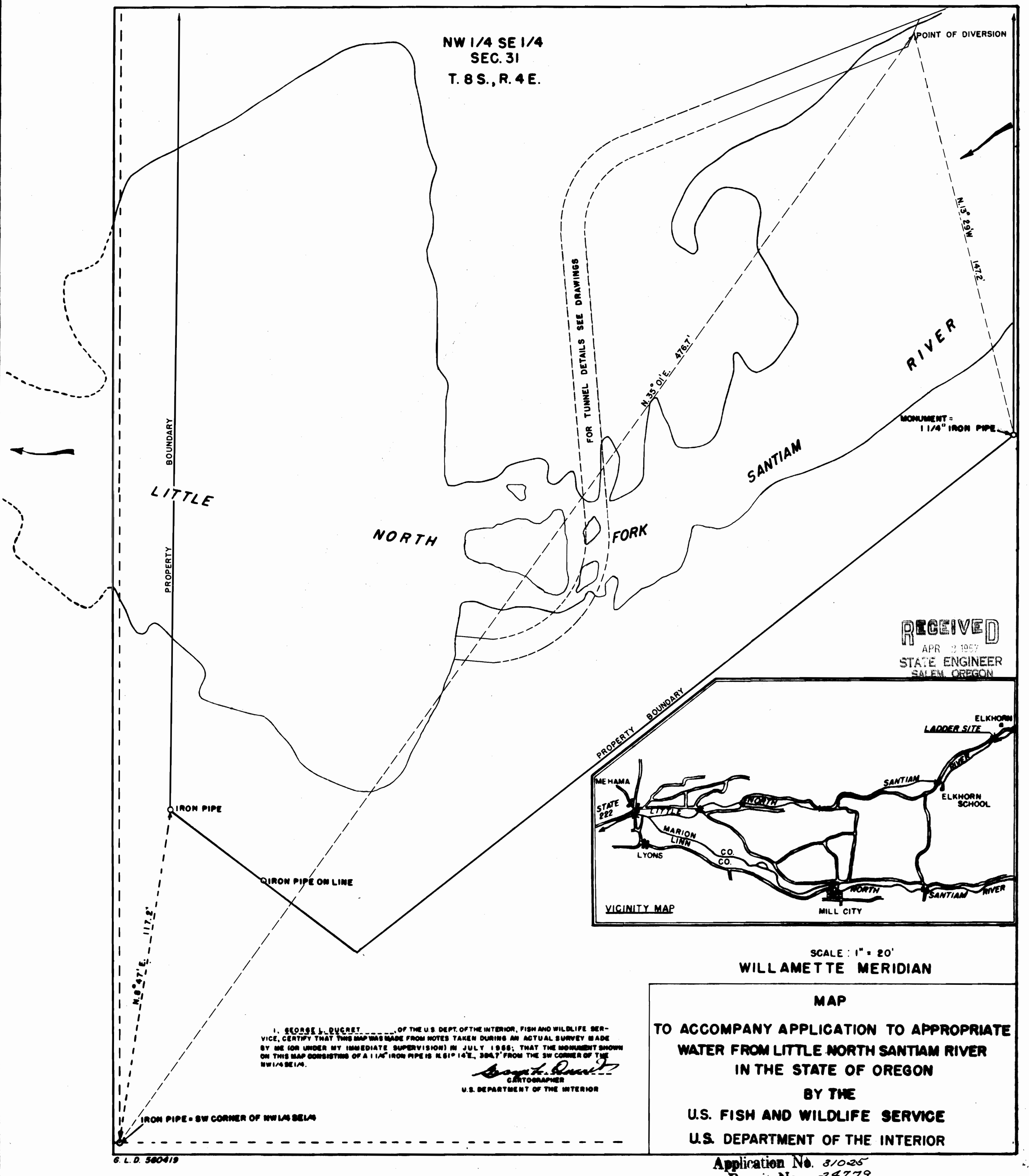

RECEIVED
 APR 3 1957
 STATE ENGINEER
 SALEM, OREGON

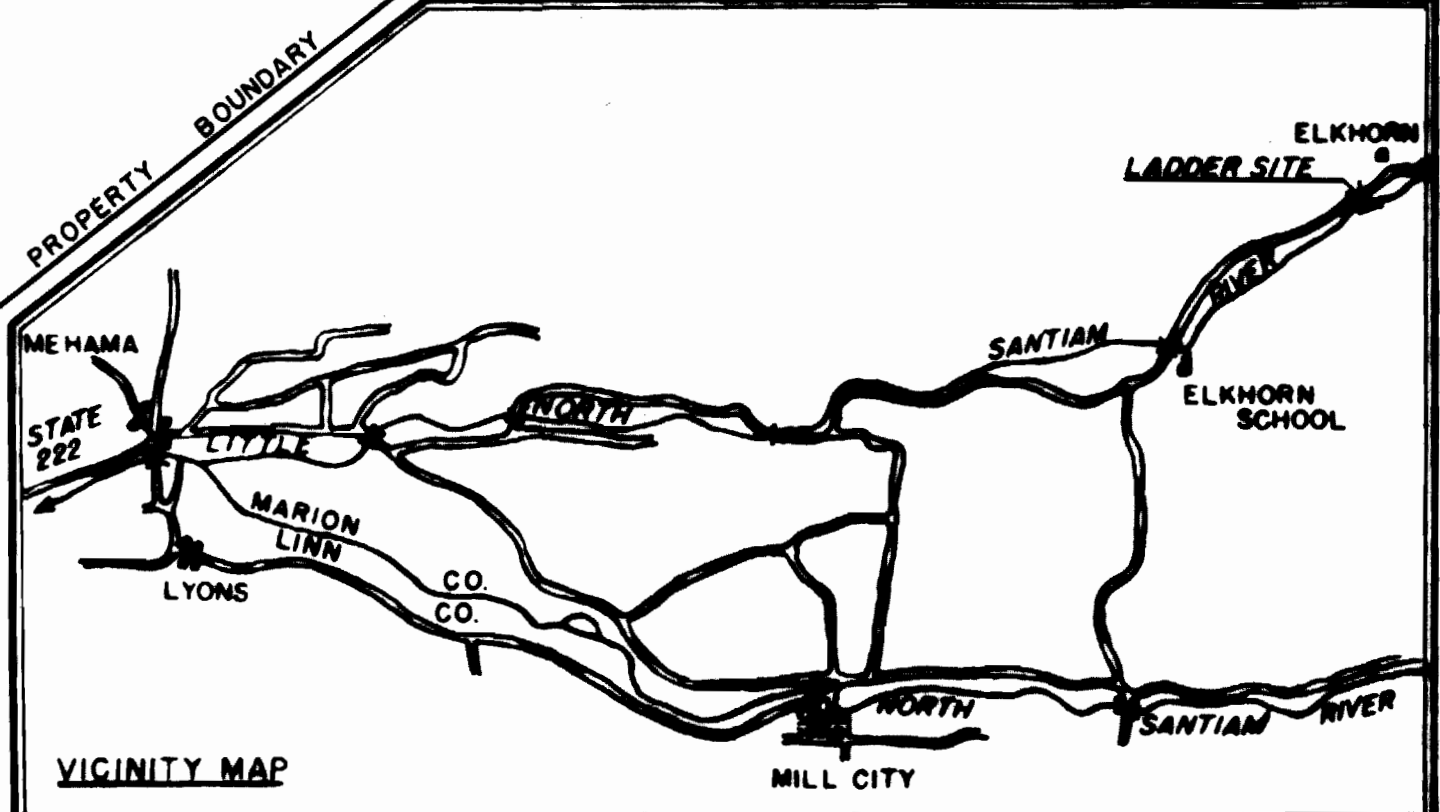

SCALE: 1" = 20'
 WILLAMETTE MERIDIAN

I, GEORGE L. DUCRET, OF THE U.S. DEPT. OF THE INTERIOR, FISH AND WILDLIFE SERVICE, CERTIFY THAT THIS MAP WAS MADE FROM NOTES TAKEN DURING AN ACTUAL SURVEY MADE BY ME (OR UNDER MY IMMEDIATE SUPERVISION) IN JULY 1955; THAT THE MONUMENT SHOWN ON THIS MAP CONSISTING OF A 1 1/4" IRON PIPE IS N. 81° 14' E., 394.7' FROM THE SW CORNER OF THE NW 1/4 SE 1/4.

George L. Ducret
 CARTOGRAPHER
 U.S. DEPARTMENT OF THE INTERIOR

MAP
TO ACCOMPANY APPLICATION TO APPROPRIATE
WATER FROM LITTLE NORTH SANTIAM RIVER
IN THE STATE OF OREGON
BY THE
U.S. FISH AND WILDLIFE SERVICE
U.S. DEPARTMENT OF THE INTERIOR

IRON PIPE - SW CORNER OF NW 1/4 SE 1/4
 N. 8° 47' E. 117.8'

Application No. 31025
 Permit No. 24779