

T 10 S, R. 26 E.
T 11 S, R. 26 E.

NORTH

SEC. 6
SEC. 7

POINT OF DIVERSION
8380' N., 1015' W., N.E. COR. SEC. 7

POINT OF DIVERSION
1840' N., 1959' W., N.E. COR.
SEC. 7

9

7

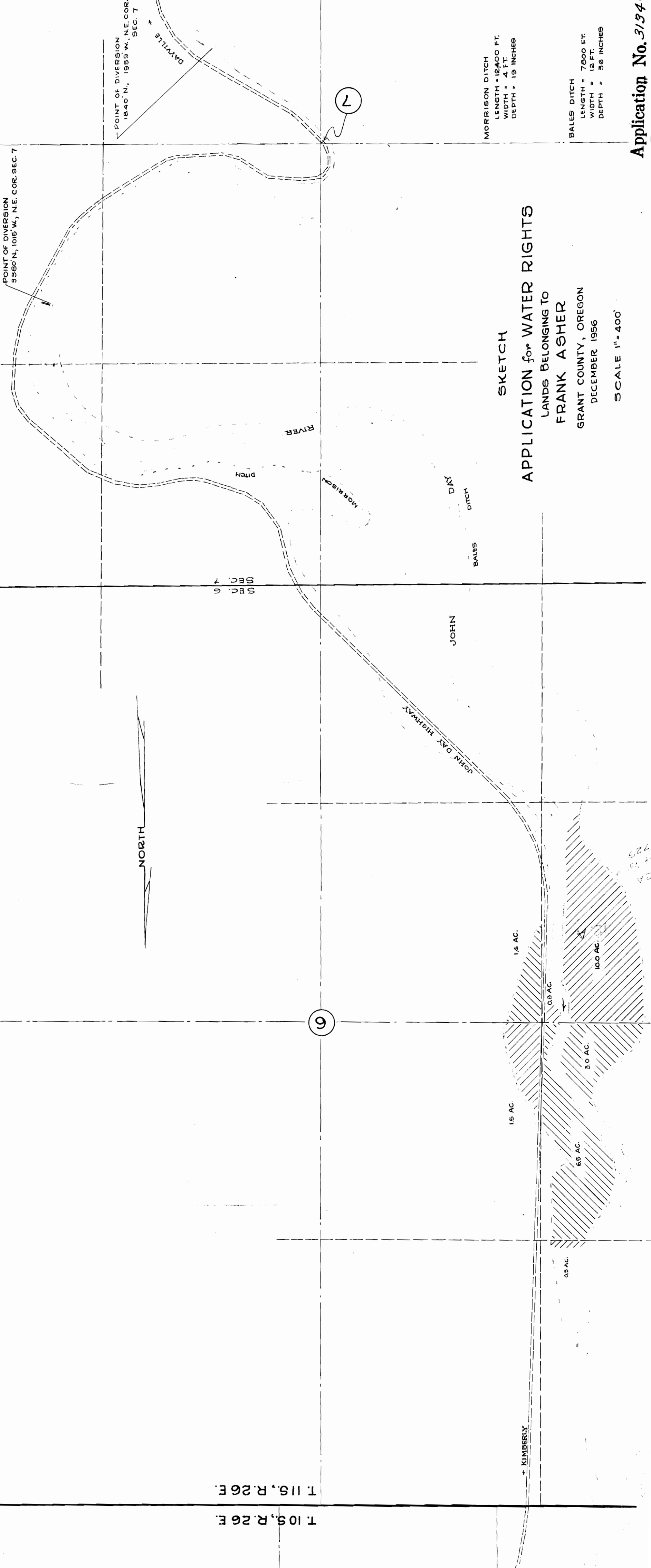

SKETCH

APPLICATION for WATER RIGHTS

LANDS BELONGING TO
FRANK ASHER
GRANT COUNTY, OREGON
DECEMBER 1956

SCALE 1" = 400'

MORRISON DITCH
LENGTH = 12400 FT.
WIDTH = 4 FT.
DEPTH = 19 INCHES

BALES DITCH
LENGTH = 7800 FT.
WIDTH = 12 FT.
DEPTH = 36 INCHES

Application No. 31349
Permit No. 24883