

# SKETCH

Showing proposed use of water for power purposes in  
 Sec. 2, T. 1 N. R. 6 E.  
 Scale 1 inch = 400 ft.

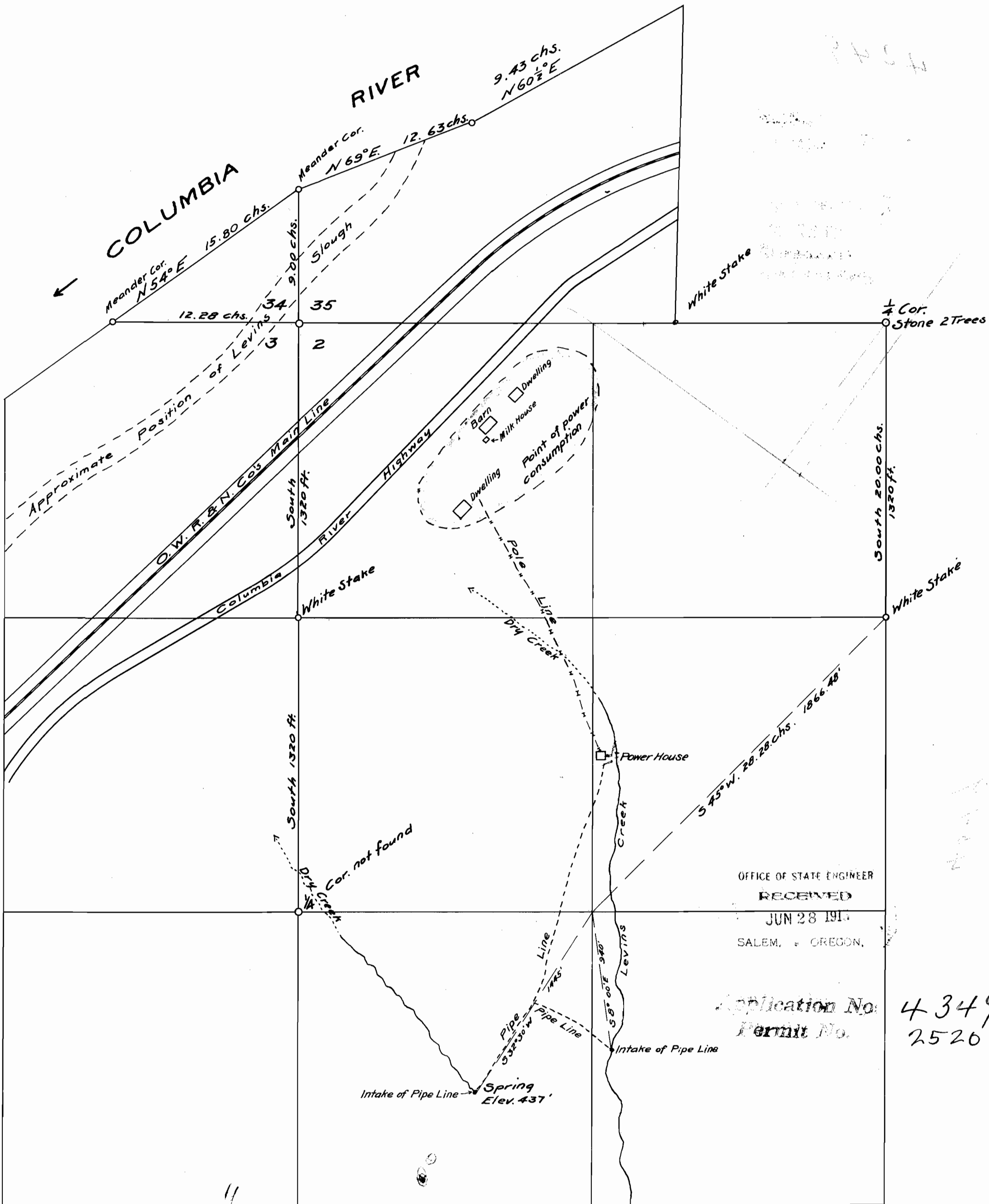

OFFICE OF STATE ENGINEER  
 RECEIVED  
 JUN 28 1914  
 SALEM, OREGON.

Application No. 4349  
 Permit No. 2520

I, J. L. Stannard, of Portland, Ore., do hereby certify that this map was made from notes taken during an actual survey made under my immediate supervision on July 17, 1914, and that it correctly represents the works described in the accompanying application, together with the location of streams, pipe, and pole lines in the immediate vicinity, and has indicated there on the points at which it is proposed to utilize the power developed.

*J. L. Stannard*  
 Surveyor.