

Acreage from correction Cert. No. 7762  
Cert. No. 3345 is void.

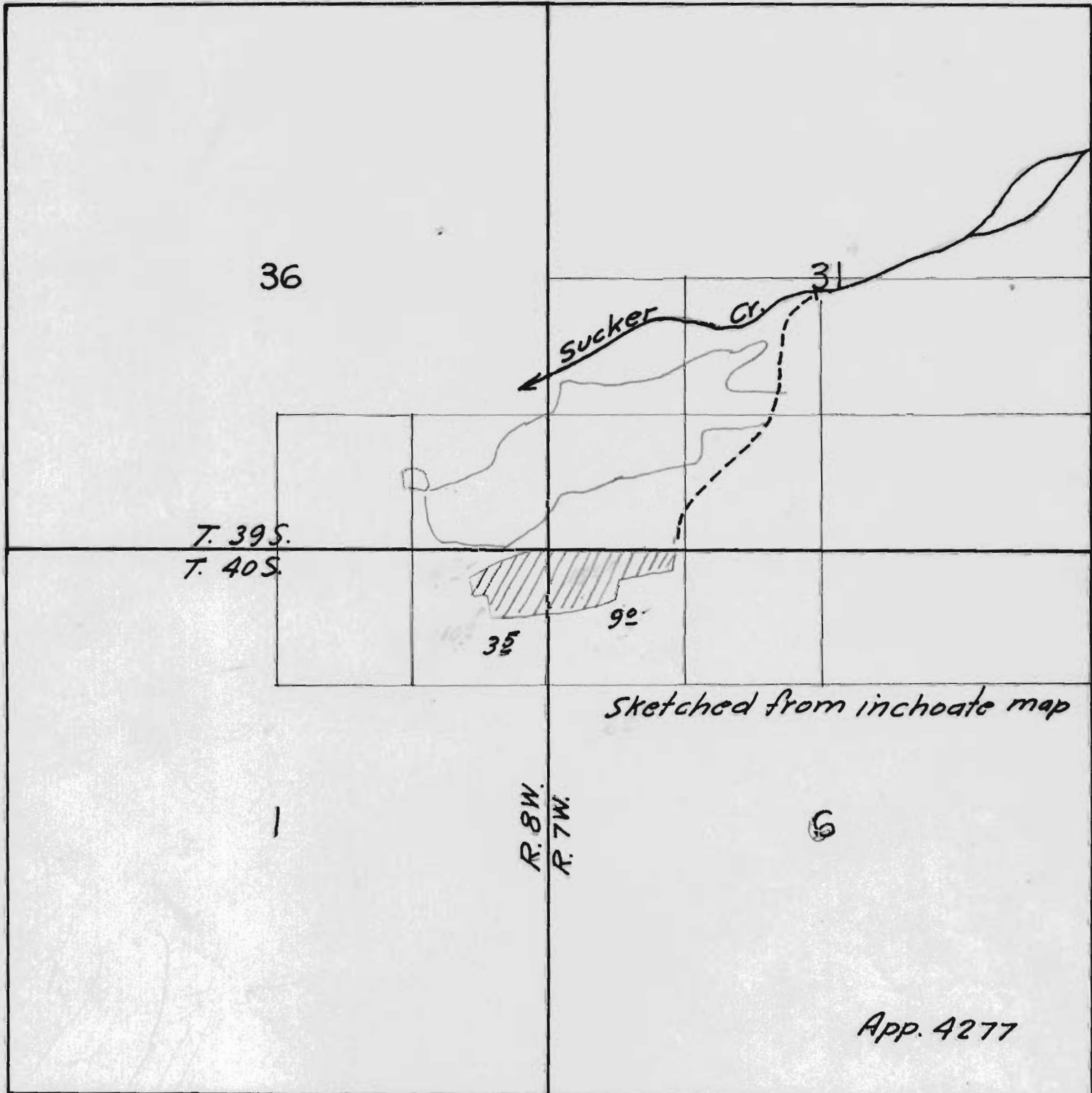

App. 4277

PPSA 4277

Township 39 S, Range 7 W.

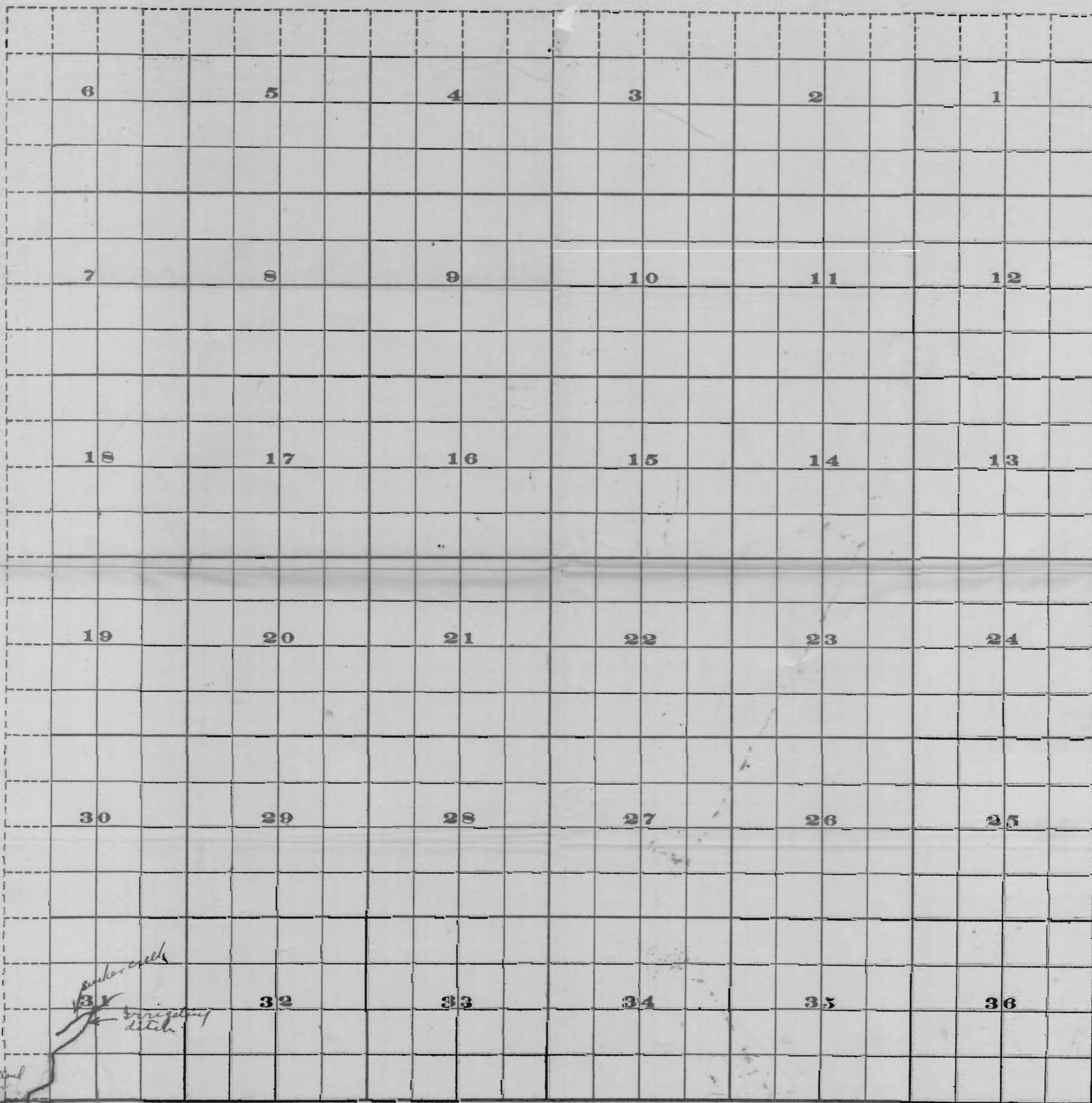

PPSA

427

#4277

*Kerby-Holland  
ditch*

*31*

*32*

*33*

*34*

*35*

*36*

FROM OFFICE OF THE STATE ENGINEER, SALEM, OREGON

1-40-8

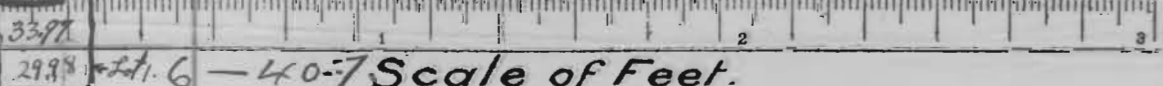

A portion of the land on which the ditch terminates already has water rights. My application is for water to cover balance of land. The figures indicate the number of acres in each forty acre tract for which I wish additional water.

A-4277  
P-2543

4500