

4438

OFFICE OF STATE ENGINEER
RECEIVED
AUG 3 1915
SALEM, OREGON.

4438

Township 39 S.

Range 5 W. W.M.

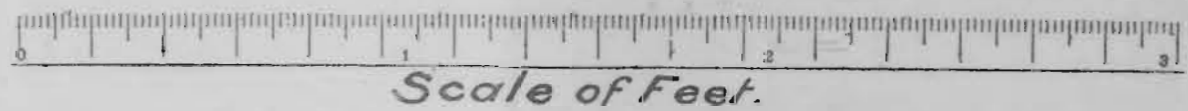
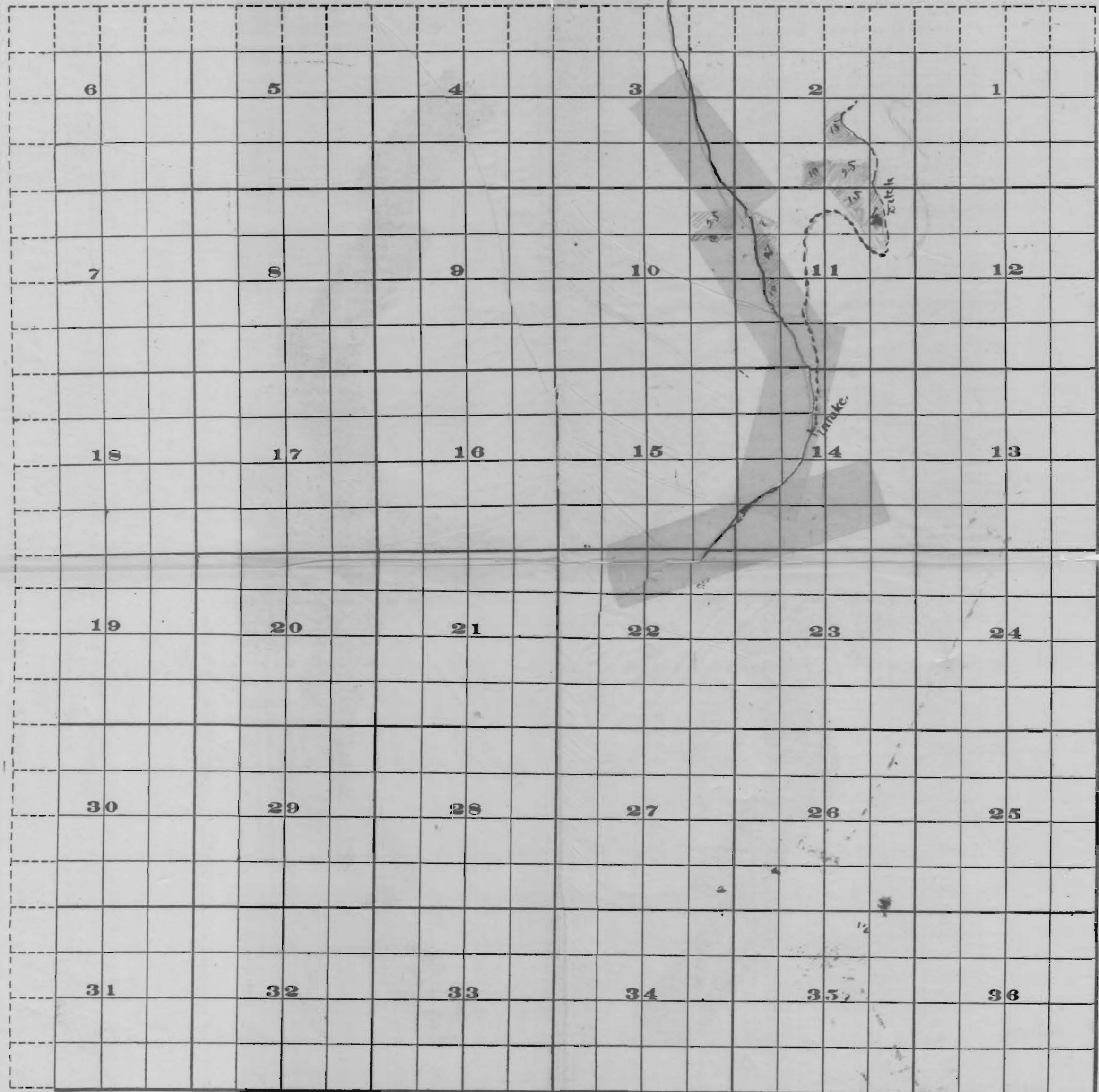

Scale of Feet.

FROM OFFICE OF THE STATE ENGINEER, SALEM, OREGON

4438

Application No. 4438
Permit No. 2600

4438