

OFFICE OF STATE ENGINEER

RECEIVED

JUN 17 1915

SALEM, OREGON

# MAP

Accompanying application for  
Permit to appropriate water.

August Muller.

June 1, 1915.

Scale 2 in = 1 mi.

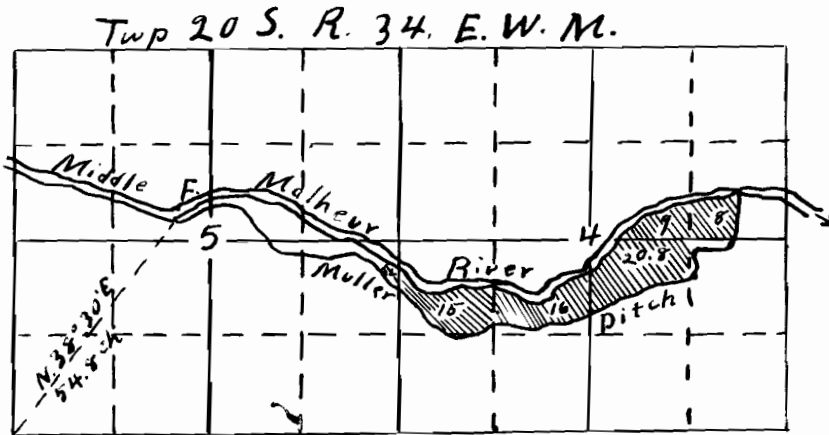

Location No. 4395  
Permit No. 2613

I, J. Edwin Johnson, of Drewsey,  
Ore., do hereby certify that this map  
was made from notes taken during an  
actual survey made by me during  
April, 1915.

J. Edwin Johnson  
Surveyor.