

4403

OFFICE OF STATE ENGINEER  
RECEIVED  
AUG 27 1915  
SALEM, OREGON,

Township 17 S., Range 47 E.

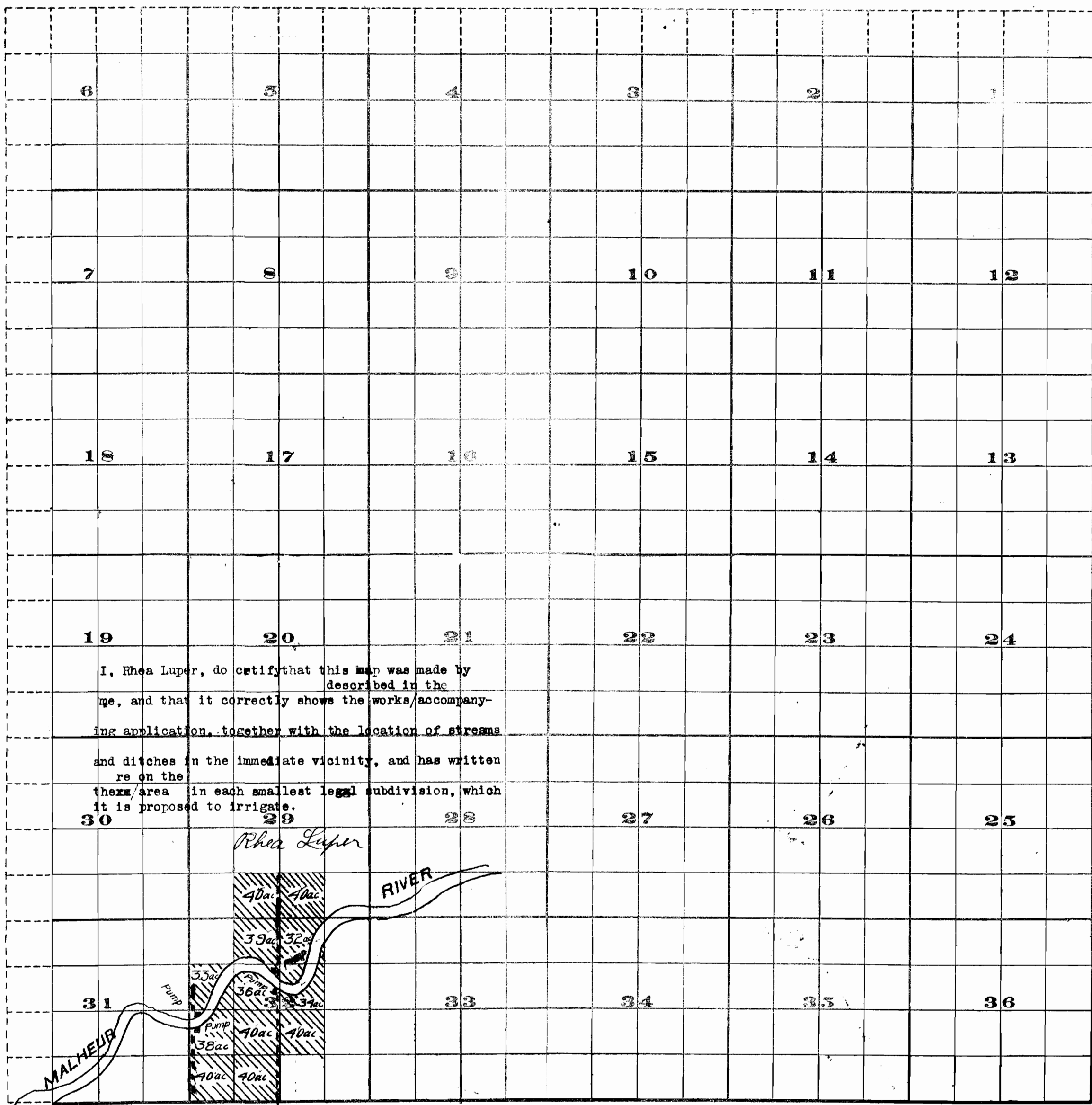

4483  
Application No.  
Permit No. 2610

I, Rhea Luper, do certify that this map was made by me, and that it correctly shows the works/accompanying application, together with the location of streams and ditches in the immediate vicinity, and has written there on the area in each smallest legal subdivision, which it is proposed to irrigate.

