

T.37S.R.6W.W.M.

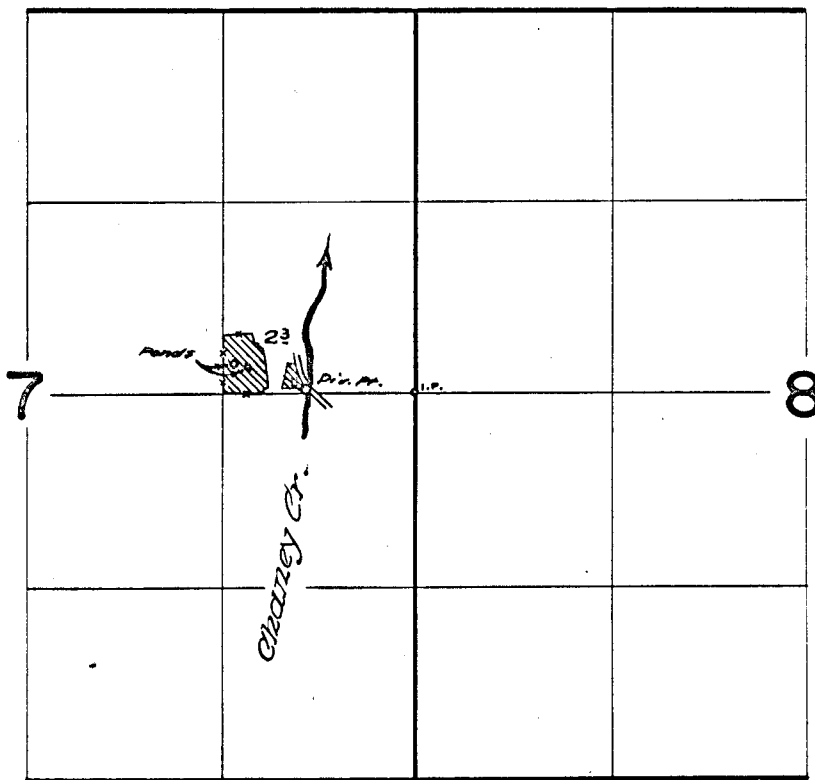

Div. Pt. is located 10 ft. North & 740 ft. West from E. 1/4 Cor. Sec. 7

FINAL PROOF SURVEY UNDER

Application No. 33280... Permit No. 26348...
IN NAME OF

PAUL A. & MARY E. BENEDETTI

Surveyed July 11, 1961, by *R. Jackson*
June 26, 1965