

CONCRETE CULVERT UNDER HIGHWAY

SET I.P. POINT OF DIVERSION
1097.77' NORTH OF 1887
S.W. CORNER OF THE WEST OF THE
THE N.W. 1/4 OF SECTION 24
STREAM ELEVATION 59.4

UN-NAMED STREAM

TO HAYNES INLET

1" PLASTIC WATER LINE

NORTH

OLD OREGON COAST HIGHWAY

NORTH 335.0'

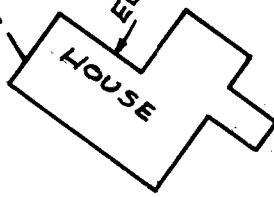

ELEVATION 94.8

N 52° 32' W

293.0'

313.0'
N 52° 56' E

687.86'
NORTH

FD. I.P.

FD. I.P.

FD. I.P.

Application No. 33481
Permit No. 26469

WATER RIGHTS SURVEY
IN SECTION 24
TOWNSHIP 24 SOUTH, RANGE 13 WEST, W.M.
COOS COUNTY, OREGON
FOR KERMIT WRIGHT
RTE. 1, BOX 539
NORTH BEND, OREGON

SCALE: 1" = 50' 11-21-59
R.H. ERICHSEN, CONSULTING ENGINEER

S.W. CORNER OF THE SE 1/4 OF
THE NW 1/4 OF SECTION 24
TOWNSHIP 24 SOUTH, RANGE 13 WEST, W.M.

REGISTERED
OREGON
LAND SURVEYOR
Robert W. Wade
OCTOBER 4, 1957
ROBERT W. WADE
433