

Per. 26830

30-8-3

T.38S.R.8W.W.M.

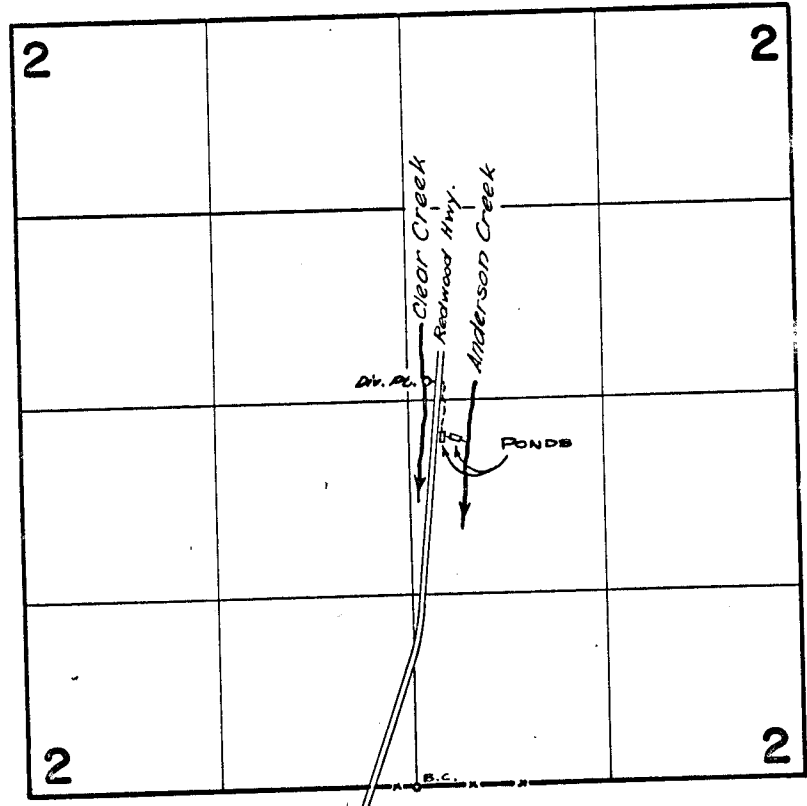

Div. Pt. is located 2780 ft. North & 120 ft. East from S. 1/4 Cor. Sec. 2

FINAL PROOF SURVEY UNDER

R-33940 R-2366
Application No. 34020... Permit No. 26830...
IN NAME OF

MERVYN WILLIAM HOGAN

Surveyed June 23 1965, by *R. Jackson*