

1204

Township 39 South, Range West. W. M.

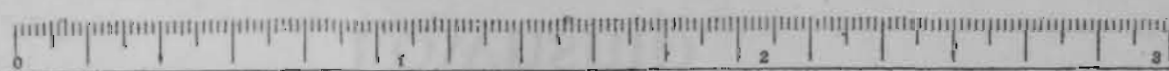
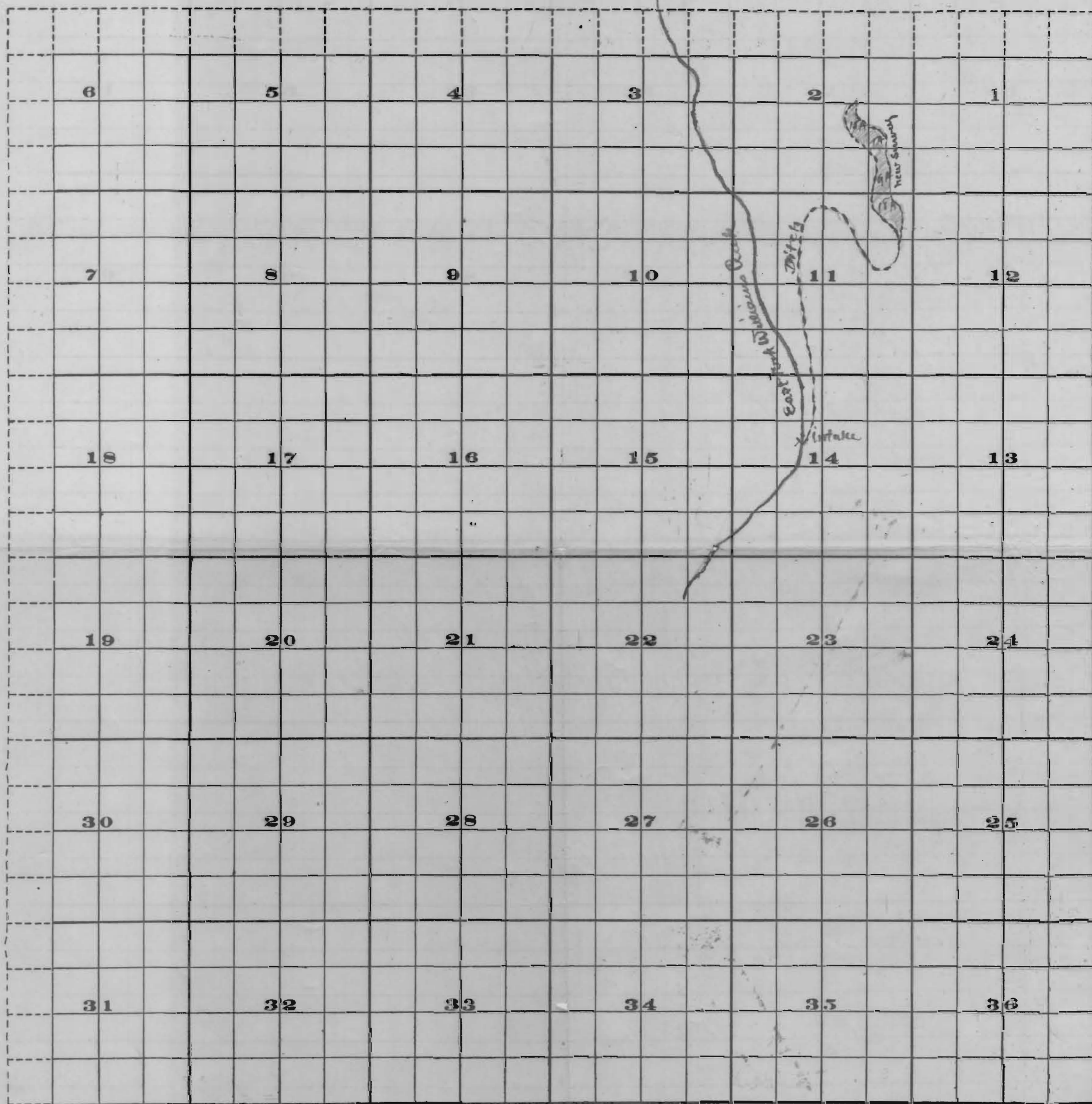

Scale of Feet.

FROM OFFICE OF THE STATE ENGINEER SALEM, OREGON

707

OFFICE OF STATE ENGINEER
RECEIVED
NOV 24 1915
SALEM, OREGON

Application No. 4641
Permit No. 2729

707

STATE OF OREGON
NOV 24 1915
RECEIVED
OFFICE OF STATE ENGINEER