

MAP of WATER RIGHT. HAYS-ALLEN-STEPPA SEC 16-15 T1S R9W W.M.

I, W.A. Markham of Arch Cape, Ore., certify that this map was made from notes of an actual survey made by me April 15, 1961.

W.A. Markham Ref. Engr. No. 18472.

SCALE 1" = 200'

Point of
Diversion
N 2194.8'
E 437.8'
From
SEC COR $\frac{16}{15}$
21/22
T1S R9W.

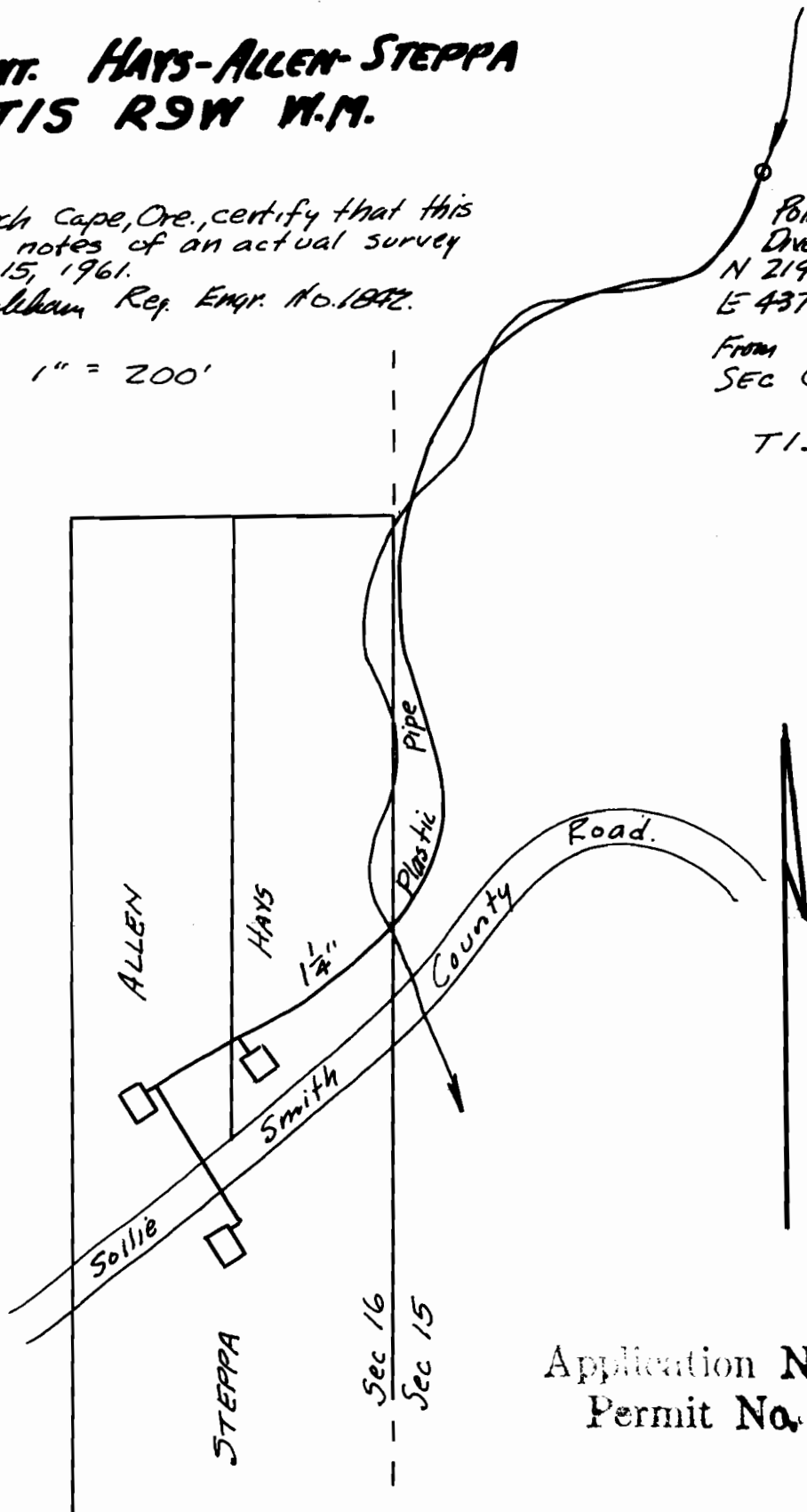

Application No. 34876
Permit No. 27372