

Silver Creek Ditch

4672

2749

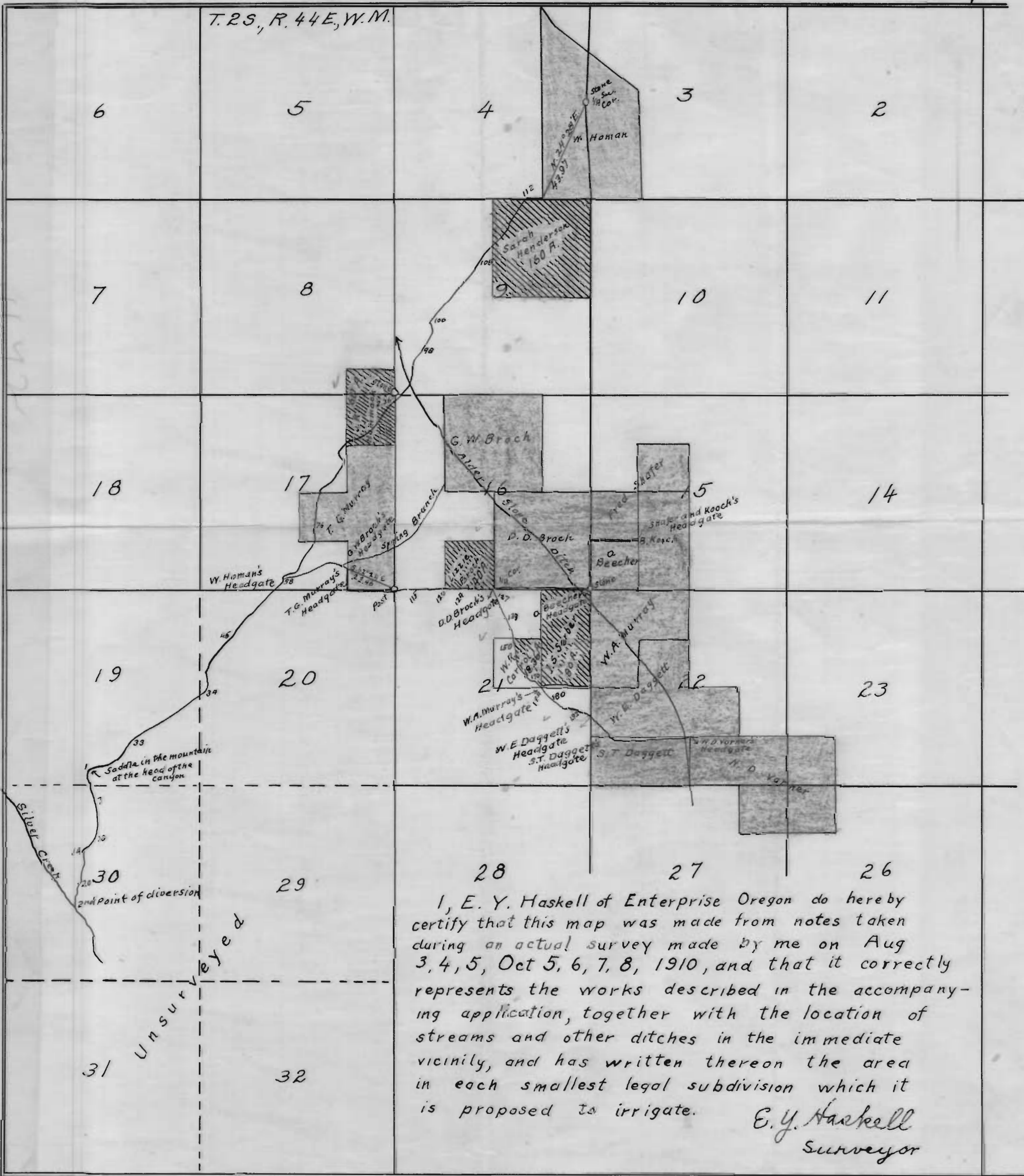

I, E. Y. Haskell of Enterprise Oregon do hereby certify that this map was made from notes taken during an actual survey made by me on Aug 3, 4, 5, Oct 5, 6, 7, 8, 1910, and that it correctly represents the works described in the accompanying application, together with the location of streams and other ditches in the immediate vicinity, and has written thereon the area in each smallest legal subdivision which it is proposed to irrigate.

E. Y. Haskell
 Surveyor

Unsurveyed

7025