

OFFICE OF STATE ENGINEER
RECEIVED
FEB 14 1916
SALEM, OREGON

8 4748

Township 21 S, Range 46 E

7
7
7
T. 21 S. R. 46 E

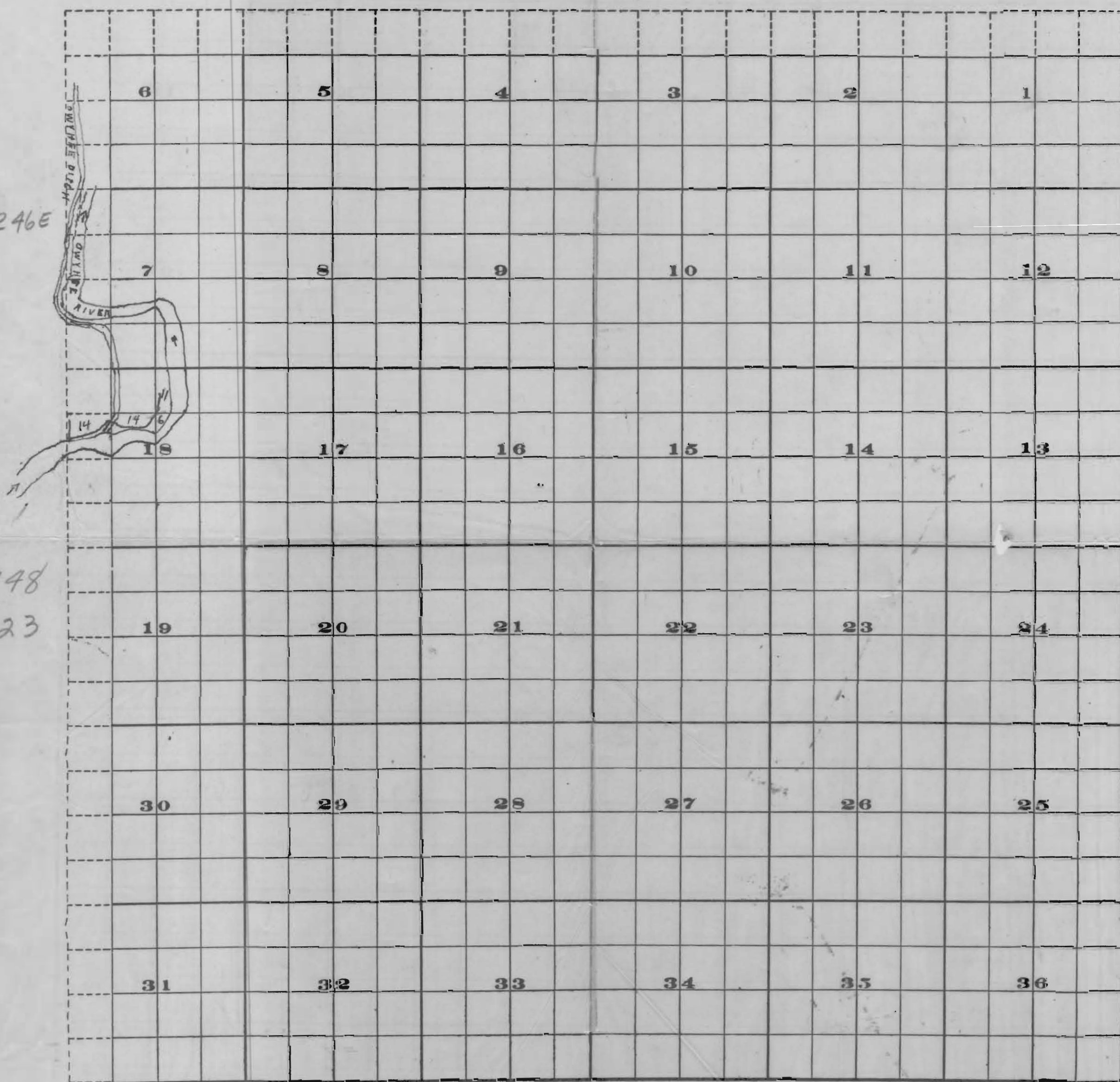

2747

App 4748
Per 2823

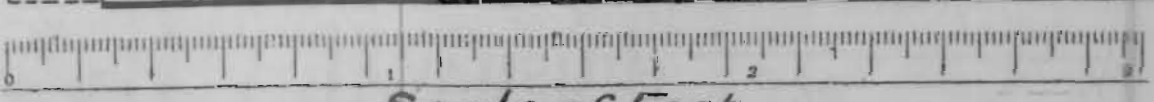

FROM OFFICE OF THE STATE ENGINEER, SALEM, OREGON

Application No. 4748
Permit No. 2823

OFFICE OF STATE ENGINEER
RECEIVED
FEB 14 1916
SALEM, OREGON

7
7
7

2747