

Map of proposed Water System.
 AC
 Summer Coos County Ore

State of Oregon
 County of Coos

Section 29 T26SR12W

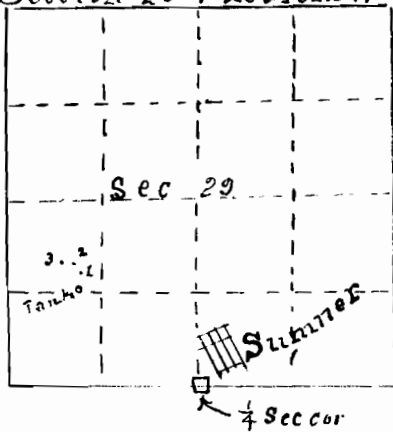

I. S. B. Cathcart of Marshfield Ore. do hereby certify that this map was made from notes taken during an actual survey made by me March 8th 1916 and that it correctly represents the position of the diverting point of the water from each of the three small unnamed streams all of which points are in the North west $\frac{1}{4}$ of the South west $\frac{1}{4}$ of section 29 T 26 S R 12 W Willamette Meridian. From diverting point 1 the $\frac{1}{4}$ section corner between sections 29 & 32 bears S 45° 22' E 34.51 chains. From point 2 it bears S 44° 48' E 35.31 chains & from point 3 it bears S 46° 45' E 36.50 chains. The green line shows approximately where the pipe line will run but was not actually surveyed.

S. B. Cathcart
 Surveyor

4794
 2838