

PLAT OF GLASGOW COOS COUNTY OREGON

"A"
 Vacated June 27, 1949
 Vol. 51, Page 269
 J. H. Linnert
 County Surveyor

"B"
 Vacated Jan 9, 1950
 Vol. 135, Page 364
 J. H. Linnert
 County Surveyor

"C"
 Vacated Mar 5, 1945
 Vol. 155, Page 1
 J. H. Linnert
 County Surveyor

"D"
 Vacated Nov 25, 1940
 County Court Journal
 No. 16, Page 379
 J. H. Linnert
 County Surveyor

"E"
 Vacated May 27, 1936
 Vol. 126, Page 23
 J. H. Linnert
 Deputy County Surveyor

"F"
 Vacated Aug. 15, 1951
 Book 211, Page 1
 J. H. Linnert
 County Surveyor

"G"
 Vacated Dec 6, 1955
 Book 247, Page 4
 J. H. Linnert
 County Surveyor

"H"
 Vacated June 13, 1958
 Book 265, Page 5
 J. H. Linnert
 County Surveyor

NOTE - The initial point of the survey is in a Section Corner between Section 2 and T25 to R13W and
 Section 30 of T24 S41W. The south line of Avenue F is 40 feet South of said Section Corner
 and a line going South from it will be on the center line of Central Avenue. One end of the Base Line
 is 40 feet North of said Section Corner and the center line of Central Avenue, the other end is 1300
 feet North of the same Section Corner and the center line of Central Avenue.
 All bearings and distances are given in feet and angles marked in red
 each mile. Street lines are marked and shown as follows:

Know All Men by these Presents, that Glasgow Tennessee Company, a corporation
 duly incorporated and organized under the laws of the State of Tennessee, having its principal
 office at the City of Portland, in the County of Multnomah, State of Oregon, has here
 by made, established and declared the annexed plat to be the plat of said Glasgow
 and Glasgow is situated on Lots Two (2), Three (3) and Four (4) of Section Two (2) in
 Township Twenty Five (25) North Range Thirteen (13) East of the Willamette
 Meridian in the County of Coos, State of Oregon.
 The initial point of said survey is in a Section Corner between Section 2 and
 Section 30 of Township Twenty Five (25) North Range Thirteen (13) East of the Willamette
 Meridian and the center line of Central Avenue. One end of the Base Line
 is 40 feet North of said Section Corner and the center line of Central Avenue, the other
 end is 1300 feet North of the same Section Corner and the center line of Central Avenue.
 All bearings and distances are given in feet and angles marked in red
 each mile. Street lines are marked and shown as follows:

All Blocks are subdivided into Lots as shown on said plat. Each of said Lots
 are Twenty Five (25) feet East and West and One Hundred (100) feet North and South.
 All Blocks and Lots are numbered as shown on said plat.
 Michigan Avenue and Central Avenue are each One Hundred (100) feet wide. All
 other Avenues and Streets with the exception of Avenue F, Tenth (10th) Street (10th
 Street) are Eighty (80) feet wide. Avenue F, Tenth Street (10th Street) and Tenth Street
 are each Forty (40) feet wide. There are no Avenues nor Streets in said
 Block 17. All streets are named, lettered and numbered on said plat. All said Avenues
 and Streets are hereby dedicated and granted to the Public use.
 IN WITNESS WHEREOF, said Glasgow Tennessee Company, its lawful agents, has caused these presents
 to be signed and attested by its President and attested by its Secretary
 and has under its corporate seal and the seal of its Board of Directors caused
 its corporate seal to be hereunto affixed this Sixth day of June Anno Domini One
 Thousand Eight Hundred and Ninety.

Glasgow Tennessee Company,
 S. Jonathan Bowers, Jr. President
 Attest: George F. Holman, Secretary

Fred K. Holman (Seal)

STATE OF OREGON
 COUNTY OF MULTNOMAH

Be it remembered that on this Sixth day of June AD 1890 before me the undersigned
 a Notary Public within and for said State and County, personally came Jonathan
 Bowers, Jr. the President and George F. Holman, the Secretary of the Glasgow Tennessee Company, the corporation which executed
 the foregoing instrument of writing and the said Jonathan Bowers, Jr. attested
 said instrument that he signed the same as president of said company, and for
 his act and deed and the said George F. Holman acknowledged to me that
 he attested the said instrument of writing and affixed the Corporate
 Seal of said Company thereto for and on behalf of said company.
 And the said Jonathan Bowers, Jr. and the said George F. Holman, having in me
 respectively first seen and acknowledged and say that he the said Jonathan Bowers,
 Jr. is the President and the said George F. Holman is the Secretary of the said
 Company, that they have the Corporate Seal of said Company, that he the said
 Jonathan Bowers, Jr. as President signed the same in the name of said
 Glasgow Tennessee Company to the foregoing instrument of writing and that
 he the said George F. Holman did attest the same and affix thereto the
 Corporate Seal of said Company, in presence of a resolution of the Board
 of Directors of said Company duly passed at a regular meeting of said
 Board of Directors duly called and held on the Sixth day of June AD 1890.
 IN TESTIMONY WHEREOF, I have hereunto set my hand and affixed my Notarial Seal
 this Sixth day of June AD 1890.

J. A. Lanning
 Notary Public for Oregon

STATE OF OREGON
 COUNTY OF MULTNOMAH

I, James H. Matson, County Clerk of Coos County, Oregon,
 do hereby certify that the foregoing instrument of writing is a true and
 correct copy of said instrument and the same as the same appears at the
 same office of record in Volume 3 on Page 10, 11, 12, 13, 14, 15, 16, 17, 18, 19, 20, 21, 22, 23, 24, 25, 26, 27, 28, 29, 30, 31, 32, 33, 34, 35, 36, 37, 38, 39, 40, 41, 42, 43, 44, 45, 46, 47, 48, 49, 50, 51, 52, 53, 54, 55, 56, 57, 58, 59, 60, 61, 62, 63, 64, 65, 66, 67, 68, 69, 70, 71, 72, 73, 74, 75, 76, 77, 78, 79, 80, 81, 82, 83, 84, 85, 86, 87, 88, 89, 90, 91, 92, 93, 94, 95, 96, 97, 98, 99, 100, 101, 102, 103, 104, 105, 106, 107, 108, 109, 110, 111, 112, 113, 114, 115, 116, 117, 118, 119, 120, 121, 122, 123, 124, 125, 126, 127, 128, 129, 130, 131, 132, 133, 134, 135, 136, 137, 138, 139, 140, 141, 142, 143, 144, 145, 146, 147, 148, 149, 150, 151, 152, 153, 154, 155, 156, 157, 158, 159, 160, 161, 162, 163, 164, 165, 166, 167, 168, 169, 170, 171, 172, 173, 174, 175, 176, 177, 178, 179, 180, 181, 182, 183, 184, 185, 186, 187, 188, 189, 190, 191, 192, 193, 194, 195, 196, 197, 198, 199, 200, 201, 202, 203, 204, 205, 206, 207, 208, 209, 210, 211, 212, 213, 214, 215, 216, 217, 218, 219, 220, 221, 222, 223, 224, 225, 226, 227, 228, 229, 230, 231, 232, 233, 234, 235, 236, 237, 238, 239, 240, 241, 242, 243, 244, 245, 246, 247, 248, 249, 250, 251, 252, 253, 254, 255, 256, 257, 258, 259, 260, 261, 262, 263, 264, 265, 266, 267, 268, 269, 270, 271, 272, 273, 274, 275, 276, 277, 278, 279, 280, 281, 282, 283, 284, 285, 286, 287, 288, 289, 290, 291, 292, 293, 294, 295, 296, 297, 298, 299, 300, 301, 302, 303, 304, 305, 306, 307, 308, 309, 310, 311, 312, 313, 314, 315, 316, 317, 318, 319, 320, 321, 322, 323, 324, 325, 326, 327, 328, 329, 330, 331, 332, 333, 334, 335, 336, 337, 338, 339, 340, 341, 342, 343, 344, 345, 346, 347, 348, 349, 350, 351, 352, 353, 354, 355, 356, 357, 358, 359, 360, 361, 362, 363, 364, 365, 366, 367, 368, 369, 370, 371, 372, 373, 374, 375, 376, 377, 378, 379, 380, 381, 382, 383, 384, 385, 386, 387, 388, 389, 390, 391, 392, 393, 394, 395, 396, 397, 398, 399, 400, 401, 402, 403, 404, 405, 406, 407, 408, 409, 410, 411, 412, 413, 414, 415, 416, 417, 418, 419, 420, 421, 422, 423, 424, 425, 426, 427, 428, 429, 430, 431, 432, 433, 434, 435, 436, 437, 438, 439, 440, 441, 442, 443, 444, 445, 446, 447, 448, 449, 450, 451, 452, 453, 454, 455, 456, 457, 458, 459, 460, 461, 462, 463, 464, 465, 466, 467, 468, 469, 470, 471, 472, 473, 474, 475, 476, 477, 478, 479, 480, 481, 482, 483, 484, 485, 486, 487, 488, 489, 490, 491, 492, 493, 494, 495, 496, 497, 498, 499, 500, 501, 502, 503, 504, 505, 506, 507, 508, 509, 510, 511, 512, 513, 514, 515, 516, 517, 518, 519, 520, 521, 522, 523, 524, 525, 526, 527, 528, 529, 530, 531, 532, 533, 534, 535, 536, 537, 538, 539, 540, 541, 542, 543, 544, 545, 546, 547, 548, 549, 550, 551, 552, 553, 554, 555, 556, 557, 558, 559, 560, 561, 562, 563, 564, 565, 566, 567, 568, 569, 570, 571, 572, 573, 574, 575, 576, 577, 578, 579, 580, 581, 582, 583, 584, 585, 586, 587, 588, 589, 590, 591, 592, 593, 594, 595, 596, 597, 598, 599, 600, 601, 602, 603, 604, 605, 606, 607, 608, 609, 610, 611, 612, 613, 614, 615, 616, 617, 618, 619, 620, 621, 622, 623, 624, 625, 626, 627, 628, 629, 630, 631, 632, 633, 634, 635, 636, 637, 638, 639, 640, 641, 642, 643, 644, 645, 646, 647, 648, 649, 650, 651, 652, 653, 654, 655, 656, 657, 658, 659, 660, 661, 662, 663, 664, 665, 666, 667, 668, 669, 670, 671, 672, 673, 674, 675, 676, 677, 678, 679, 680, 681, 682, 683, 684, 685, 686, 687, 688, 689, 690, 691, 692, 693, 694, 695, 696, 697, 698, 699, 700, 701, 702, 703, 704, 705, 706, 707, 708, 709, 710, 711, 712, 713, 714, 715, 716, 717, 718, 719, 720, 721, 722, 723, 724, 725, 726, 727, 728, 729, 730, 731, 732, 733, 734, 735, 736, 737, 738, 739, 740, 741, 742, 743, 744, 745, 746, 747, 748, 749, 750, 751, 752, 753, 754, 755, 756, 757, 758, 759, 760, 761, 762, 763, 764, 765, 766, 767, 768, 769, 770, 771, 772, 773, 774, 775, 776, 777, 778, 779, 780, 781, 782, 783, 784, 785, 786, 787, 788, 789, 790, 791, 792, 793, 794, 795, 796, 797, 798, 799, 800, 801, 802, 803, 804, 805, 806, 807, 808, 809, 810, 811, 812, 813, 814, 815, 816, 817, 818, 819, 820, 821, 822, 823, 824, 825, 826, 827, 828, 829, 830, 831, 832, 833, 834, 835, 836, 837, 838, 839, 840, 841, 842, 843, 844, 845, 846, 847, 848, 849, 850, 851, 852, 853, 854, 855, 856, 857, 858, 859, 860, 861, 862, 863, 864, 865, 866, 867, 868, 869, 870, 871, 872, 873, 874, 875, 876, 877, 878, 879, 880, 881, 882, 883, 884, 885, 886, 887, 888, 889, 890, 891, 892, 893, 894, 895, 896, 897, 898, 899, 900, 901, 902, 903, 904, 905, 906, 907, 908, 909, 910, 911, 912, 913, 914, 915, 916, 917, 918, 919, 920, 921, 922, 923, 924, 925, 926, 927, 928, 929, 930, 931, 932, 933, 934, 935, 936, 937, 938, 939, 940, 941, 942, 943, 944, 945, 946, 947, 948, 949, 950, 951, 952, 953, 954, 955, 956, 957, 958, 959, 960, 961, 962, 963, 964, 965, 966, 967, 968, 969, 970, 971, 972, 973, 974, 975, 976, 977, 978, 979, 980, 981, 982, 983, 984, 985, 986, 987, 988, 989, 990, 991, 992, 993, 994, 995, 996, 997, 998, 999, 1000.

James H. Matson
 County Clerk

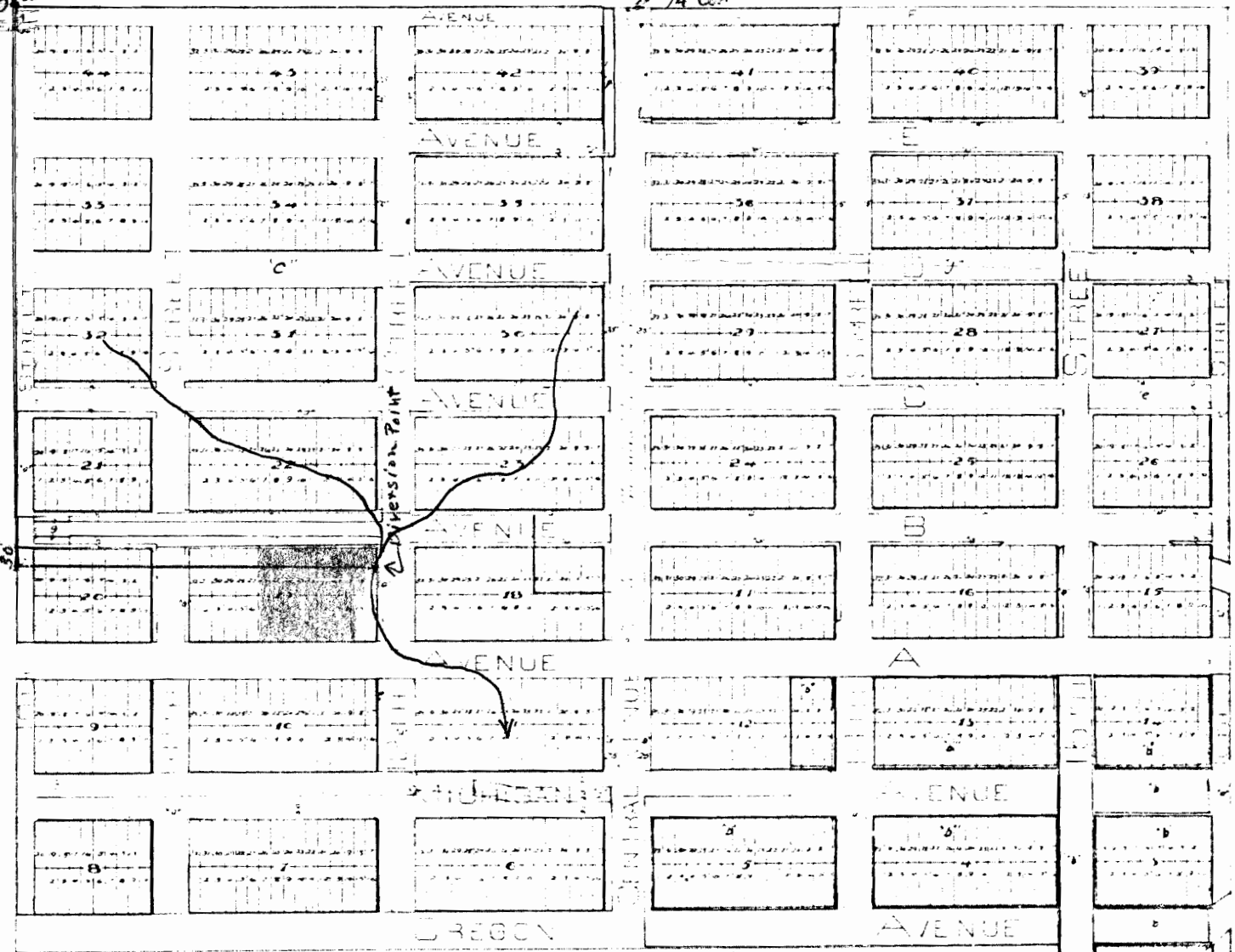

Div. - 30 ft. N. and 15 ft. W. from SE. Corner
 Lot 17, Blk 19.
Copy Copy

2

RECEIVED
 DEC 11 1962
 OFFICE ENGINEER

1/4 Section 20 5

200 VACATED

625 AVE

10 1410

SEE MAP 35 CD 2413

NEX 4 NW 1/4 SEC. 2 T25 S R13 W

10 SE

845

SEE MAP 2BB

3094

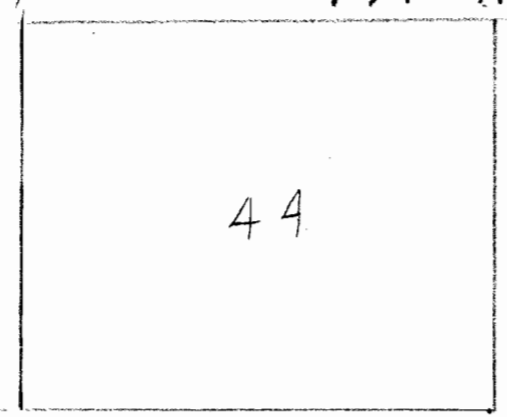

44

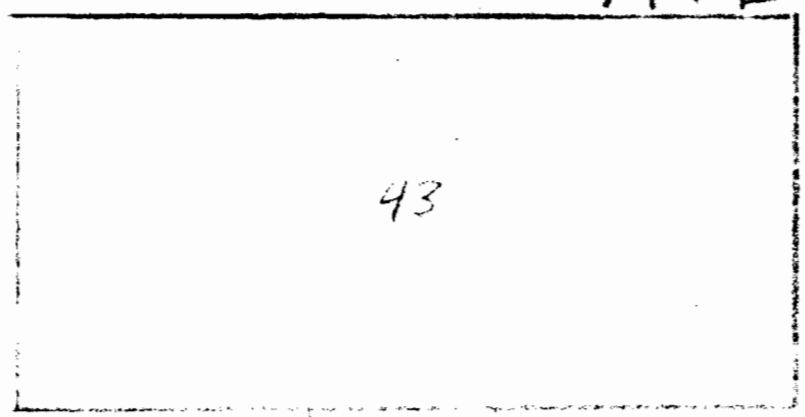

43

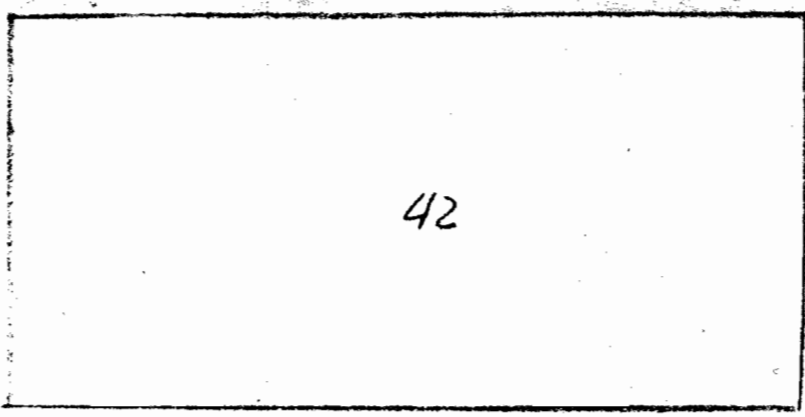

42

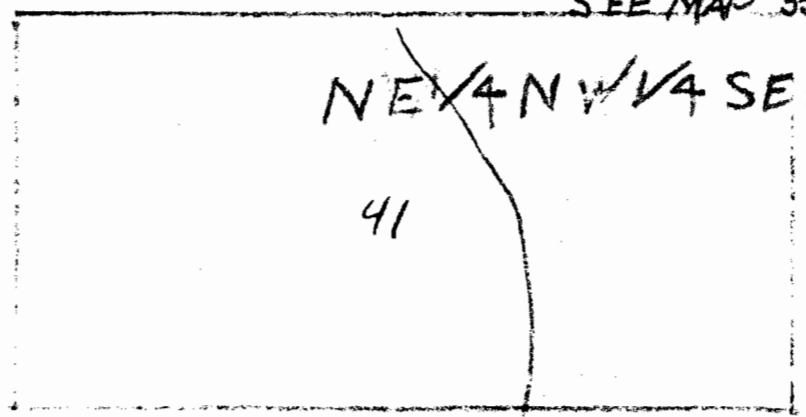

41

E-ST.

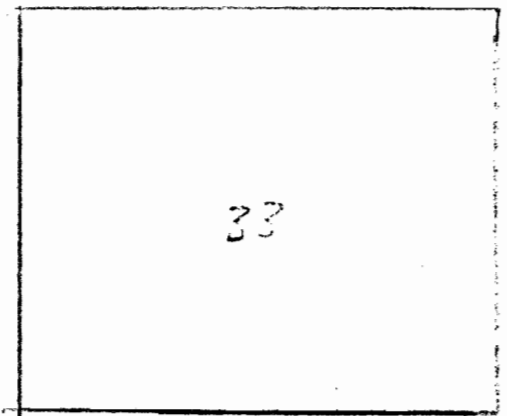

33

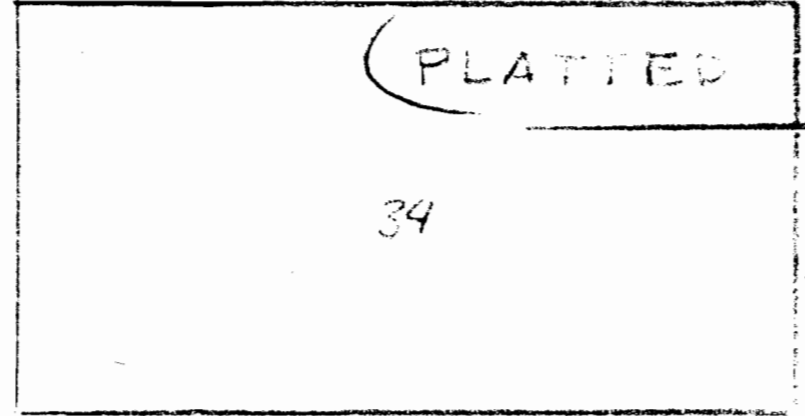

34

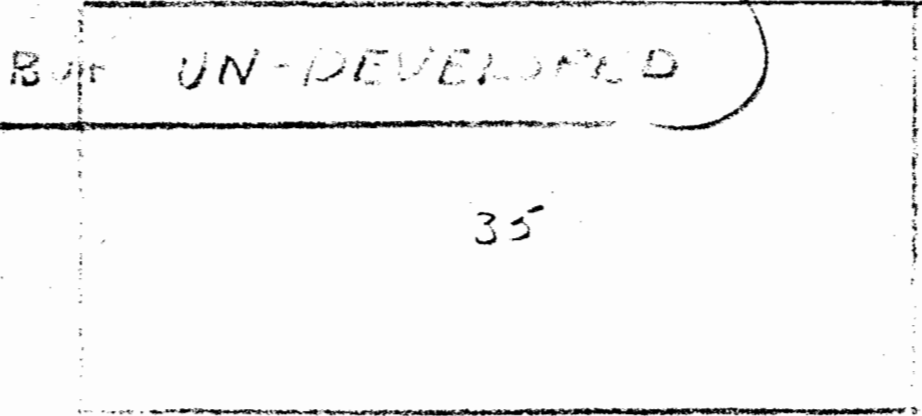

35

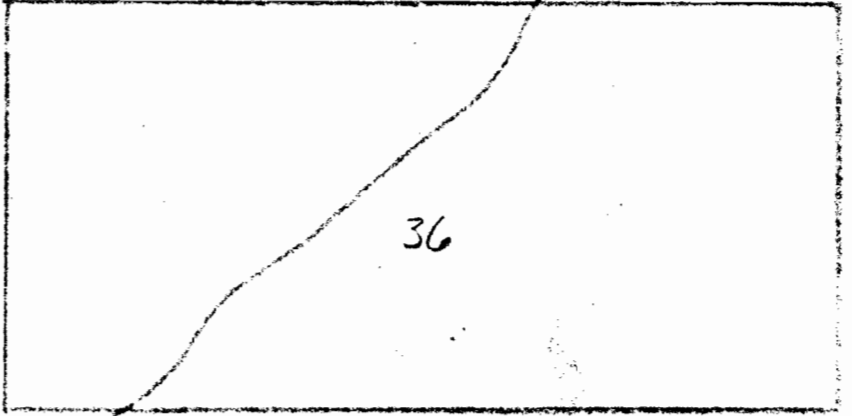

36

D-ST.

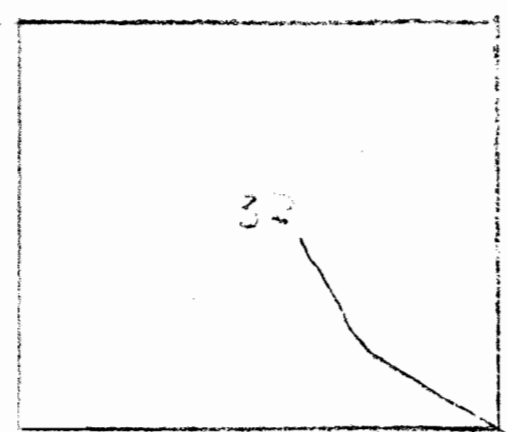

32

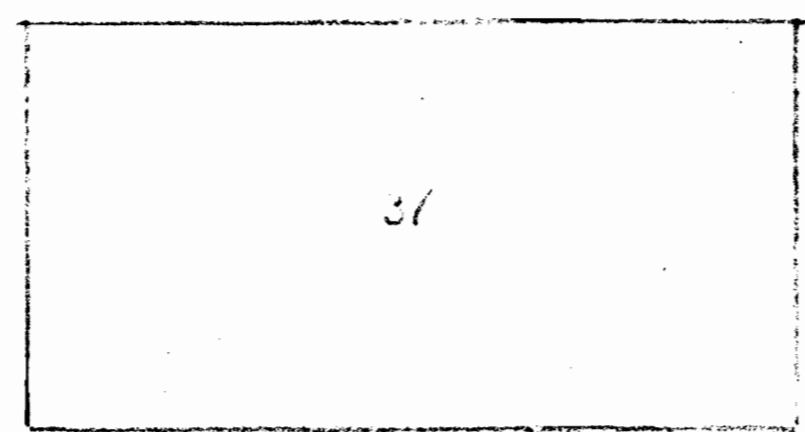

31

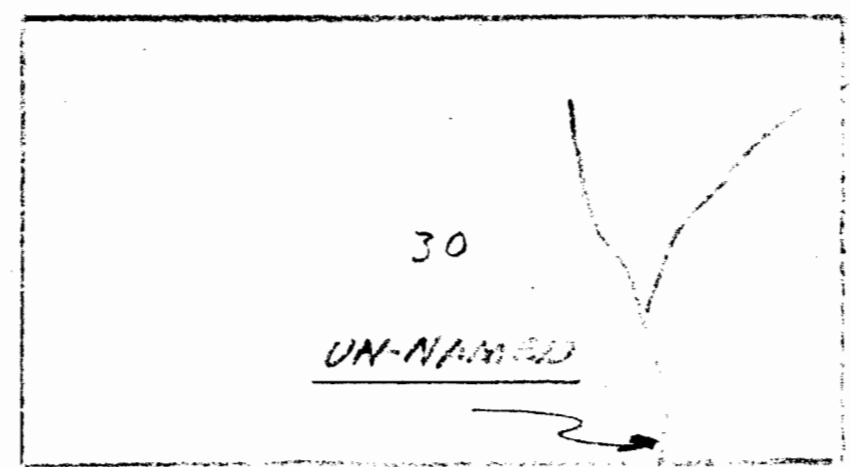

30

UN-NAMED

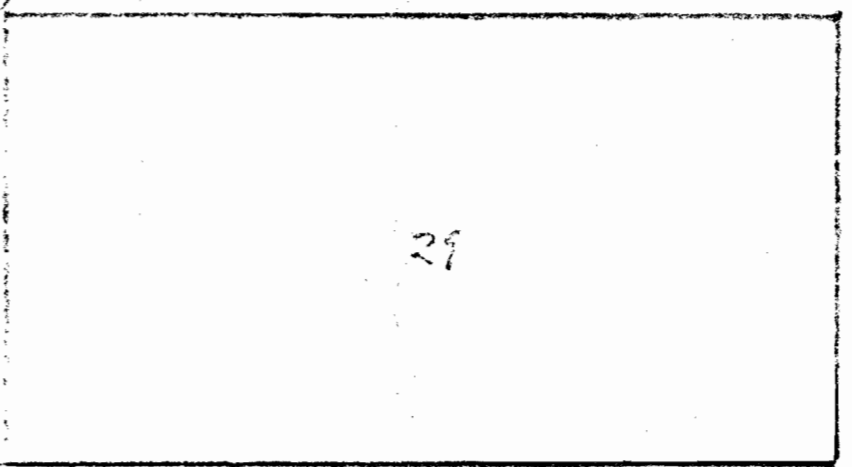

29

C-ST.

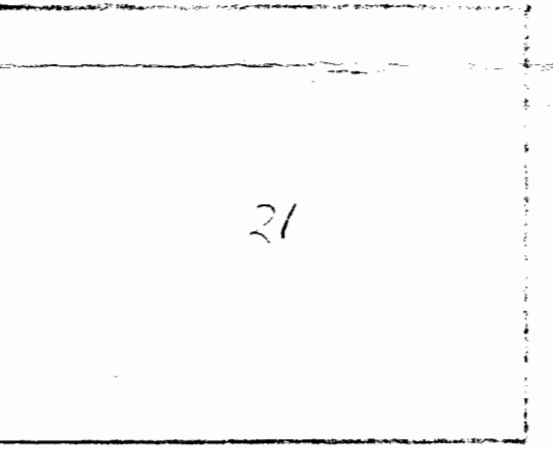

21

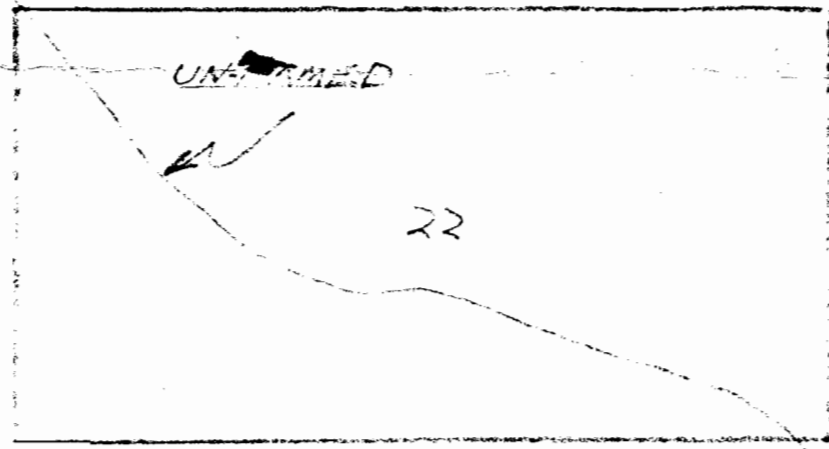

22

UN-NAMED

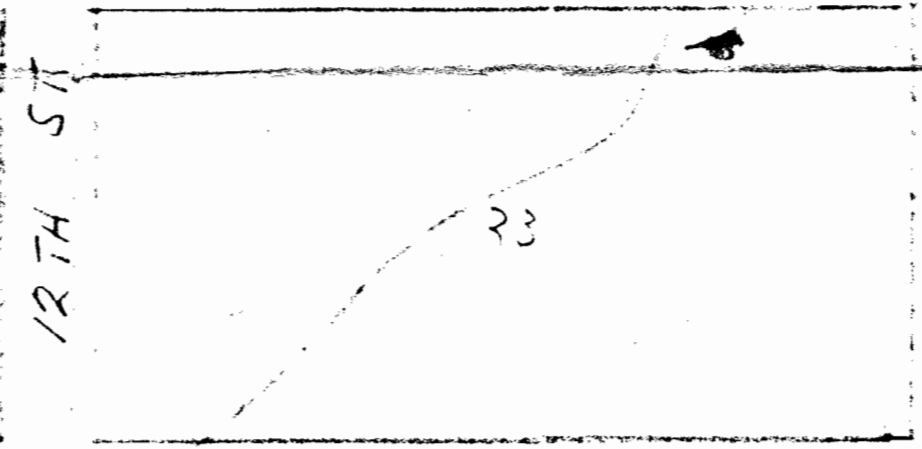

23

12TH ST

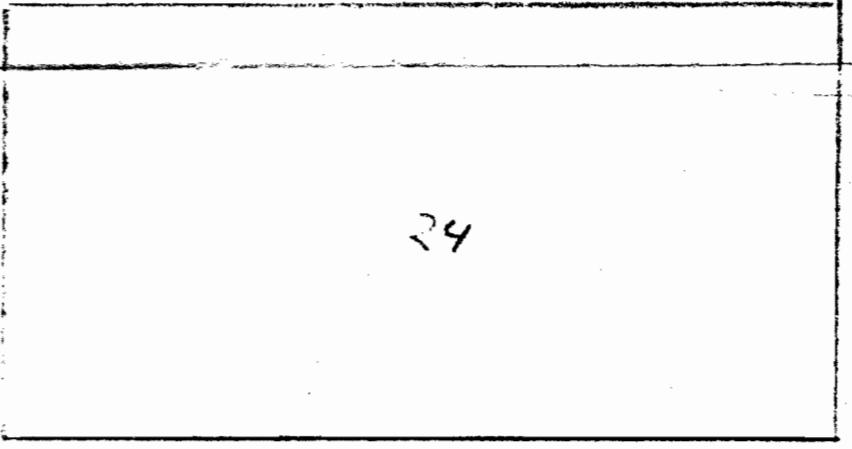

24

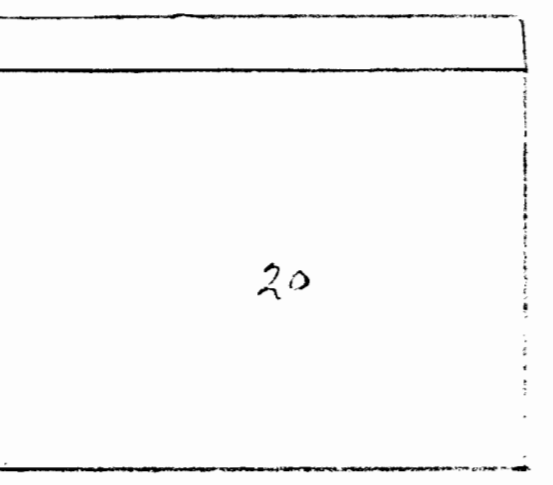

20

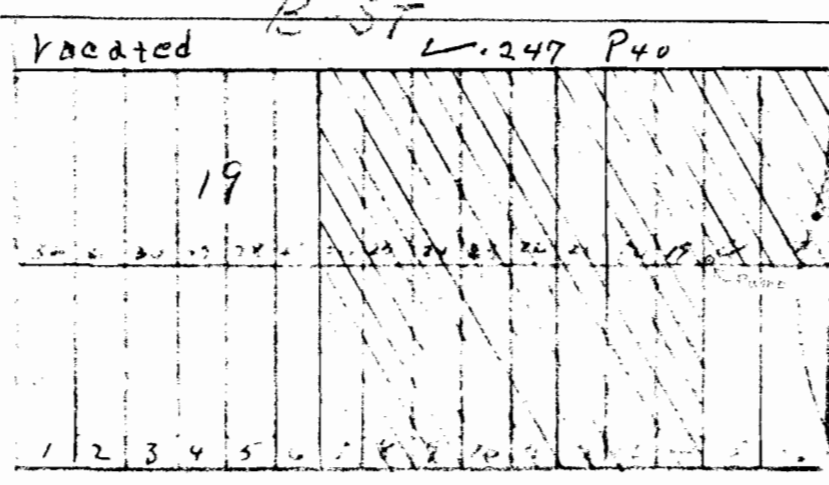

19

Vacated R ST L. 247 P 40

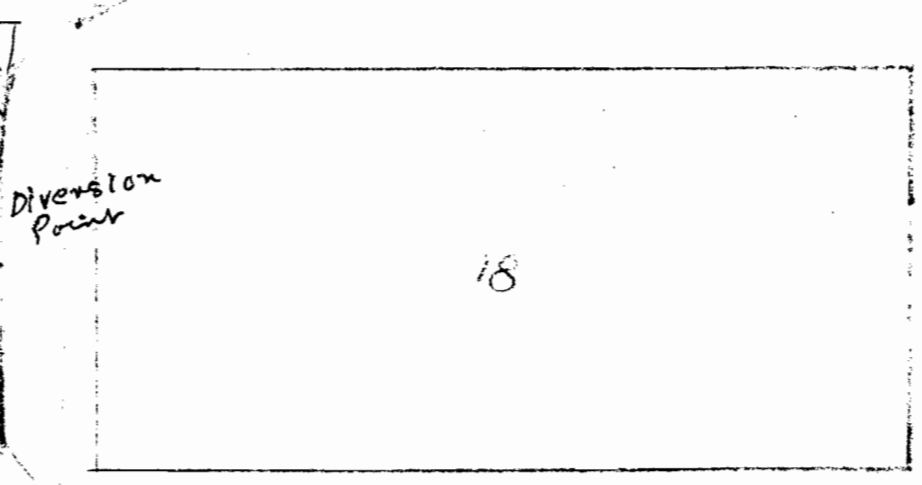

18

Diversion Point

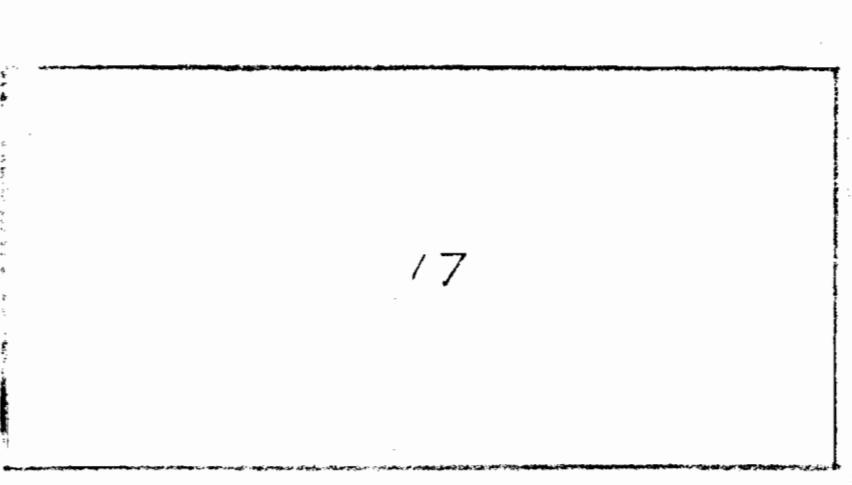

17

A-ST.

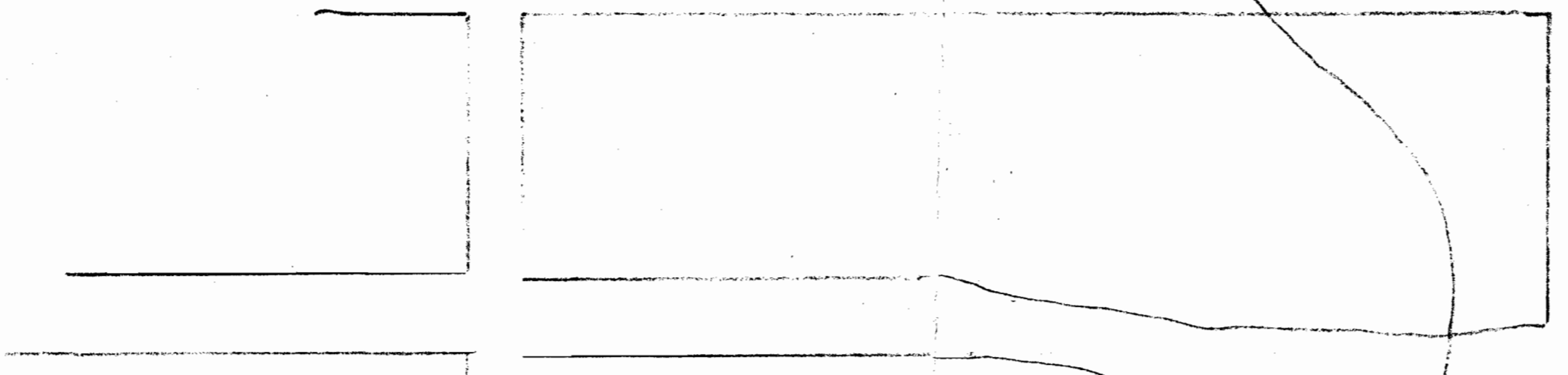

To Cass Bay

2 BA

GLASGOW AND VACATED BLOCKS & STREETS

SEE MAP 2AB

RECEIVED
DEC 6 1962
STATE ENGINEER
SALEM, OREGON

GLASGOW
COOS COUNTY ORE

2 BA 25 13