

38 5 W

Township 38 S.; Range 5 W.

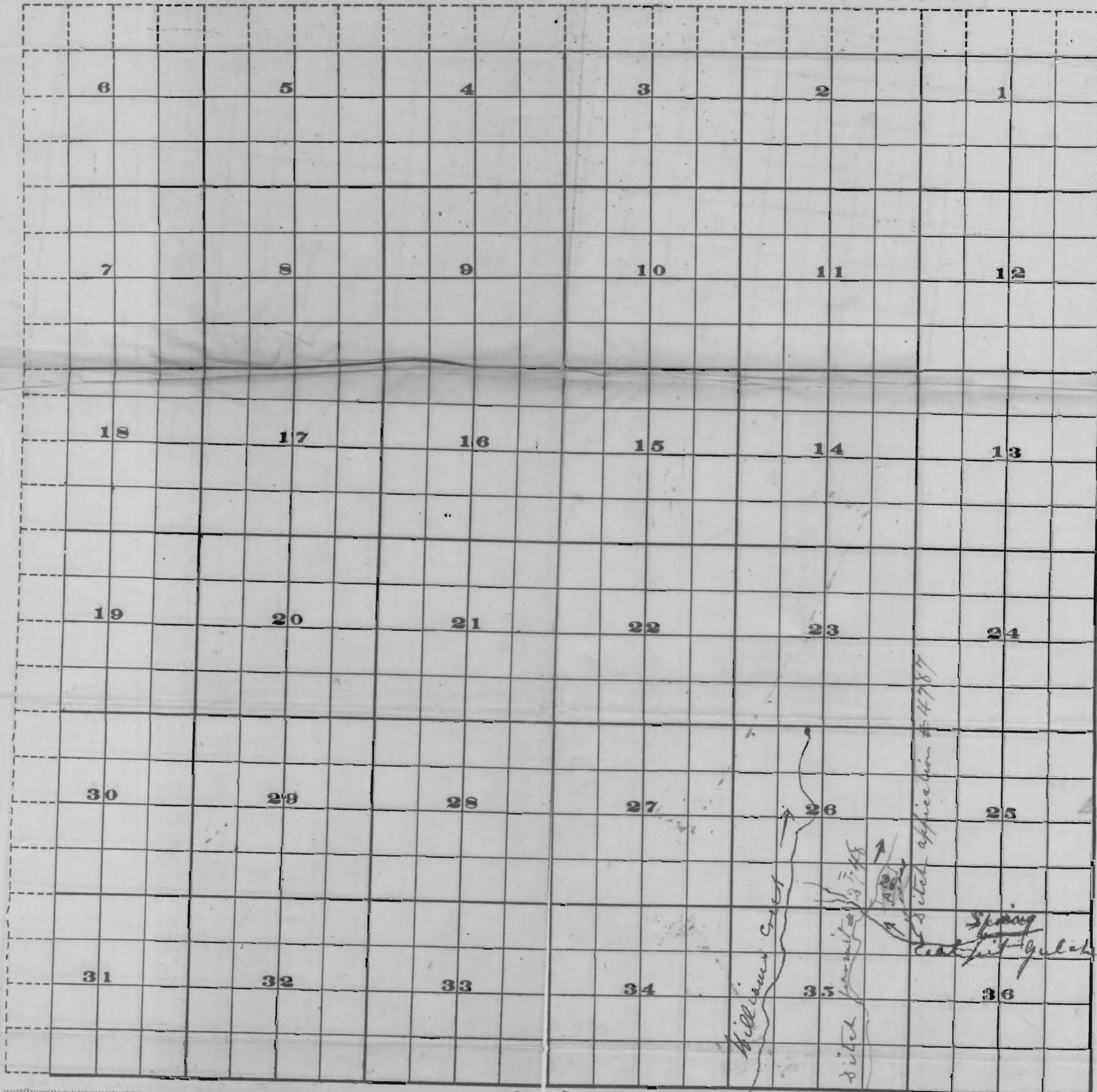

OFFICE OF STATE ENGINEER  
 RECEIVED  
 MAR 21 1916  
 SALEM, OREGON.

Application No. 4787  
 Permit No. 2846

FROM OFFICE OF THE STATE ENGINEER, SALEM, OREGON

Water to be used on 20 acres in S.E. 1/4 of S. 2 1/4 Sec 26 T4 38 S. R. 5 W.  
 ditch to start in Coalpit gulch NE 1/4 of NW 1/4 Sec 36 T4 38 S. R. 5 W.

Approved: \_\_\_\_\_  
 State Engineer

38 5 W

38 5 W

38 5 W