

28814 15
 R-3263
 38-5-37

T. 38 S. R. 5 W. W.M.

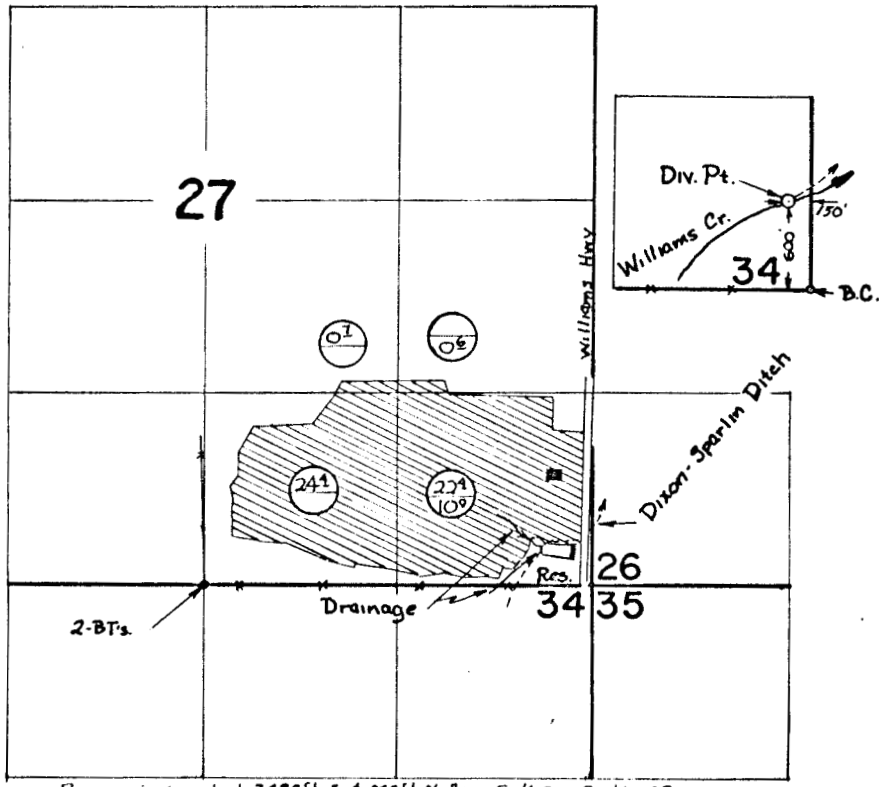

Reservoir Located 2480ft. E. & 240ft. N. from S. 4 Cor. Section 27

○ Primary
 ⊖ Supplemental (Cert 16343)

*Williams Cr. 100' wide
 100' deep
 100' long
 100' wide
 100' deep
 100' long*

FINAL PROOF SURVEY
 UNDER

R38650 R3263
 Application No. 38651 Permit No. 28814
 IN NAME OF

HAROLD P. & VIRGINIA SANDERS

Surveyed 15 APR. 1970, by D. R. BUELL