

28868 15
R-3270
FILE - 1A

T. 37S. R. 5 W. W.M.

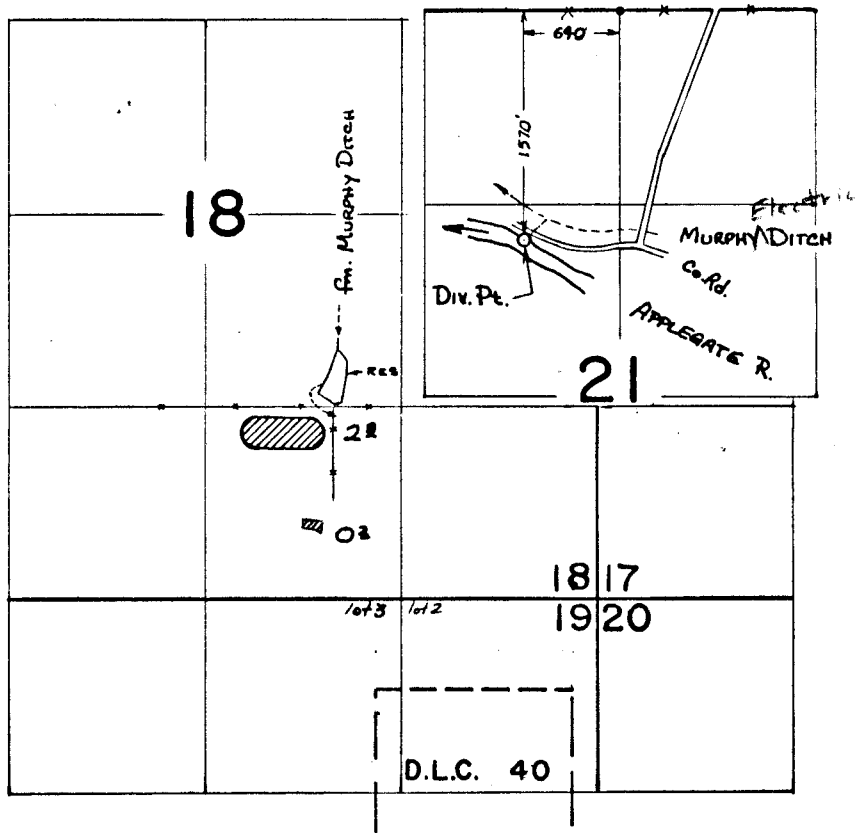

RES. DIV. PT: 20' N. & 450' W. FROM NE. COR. SW 1/4 SEC. 18

FINAL PROOF SURVEY UNDER

R 37640 R- 3270
Application No. 37641 Permit No. 28868
IN NAME OF

JOSEPHINE COUNTY SCHOOL DISTRICT.

Surveyed May 22 1967, by J. Gardner
15 APR. 70 D. BUELL

C-39271-39272

1967-C
E1870A RES