

R. 33. E. W. M.

R. 34. E. W. M.

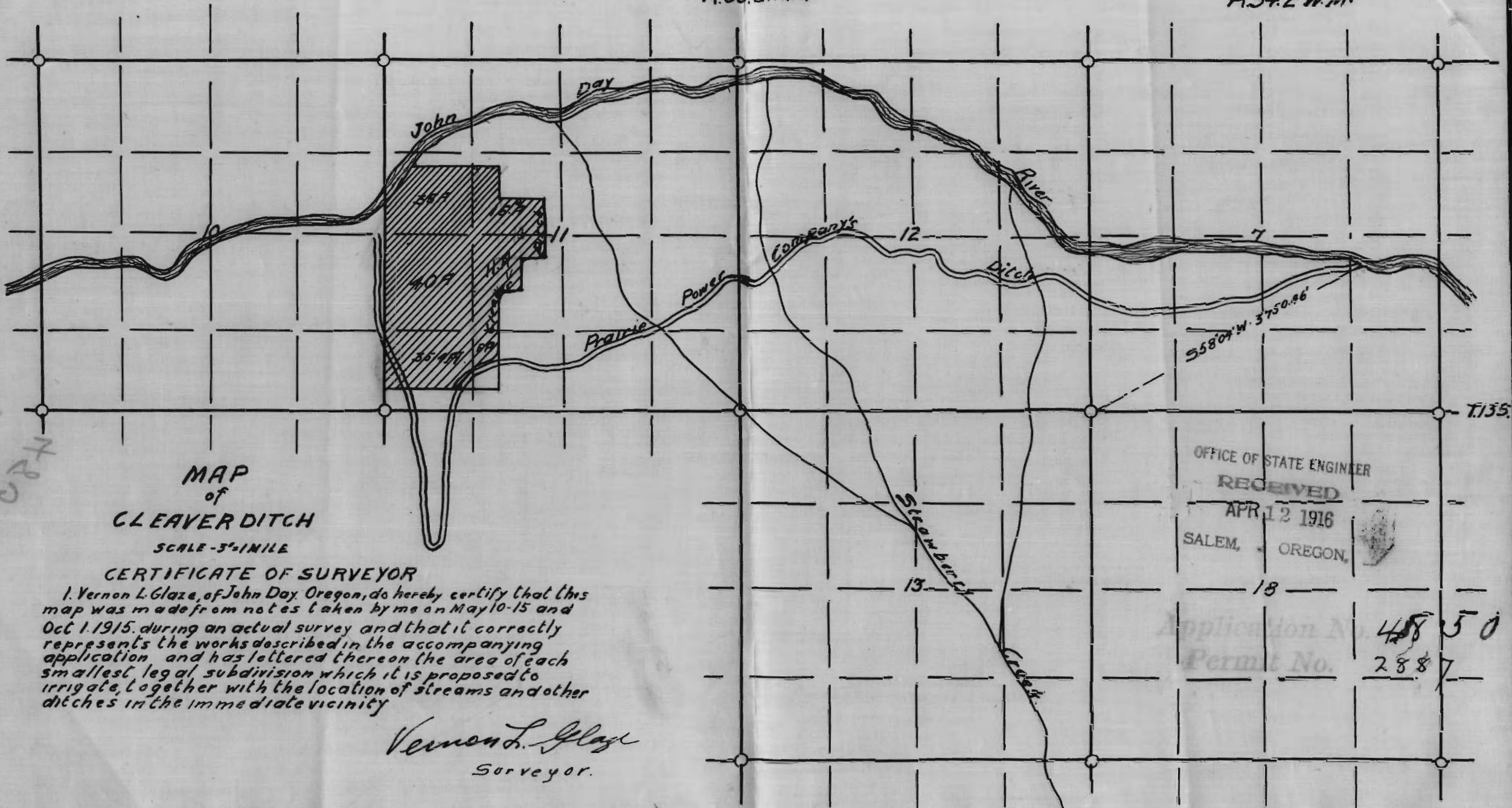

MAP
of
CLEAVER DITCH
SCALE - 5" = 1 MILE

CERTIFICATE OF SURVEYOR

I, Vernon L. Glaze, of John Day, Oregon, do hereby certify that this map was made from notes taken by me on May 10-15 and Oct. 1, 1915, during an actual survey and that it correctly represents the works described in the accompanying application and has lettered thereon the area of each smallest legal subdivision which it is proposed to irrigate, together with the location of streams and other ditches in the immediate vicinity

Vernon L. Glaze
Surveyor.

OFFICE OF STATE ENGINEER
RECEIVED
APR 12 1916
SALEM, OREGON.

Application No. 45850
Permit No. 2887

T. 13 S.

4220

4220